



# 2024 DANE COUNTY FAIR

**JULY 18-21, 2024**

**ALLIANT ENERGY CENTER**

***INFORMATION AS OF MAY 15, 2024***



# OVERVIEW

- Dates: Thursday, July 18 – Sunday, July 21
- Schedule, maps, and details will be listed on the Fair's website – [www.danecountyfair.com](http://www.danecountyfair.com)
- Fair Premium Book located on the [Youth Exhibitors](#) page at [www.danecountyfair.com](http://www.danecountyfair.com)
- **Entries Questions** – [entries.danecountyfair@gmail.com](mailto:entries.danecountyfair@gmail.com) or 608-880-0026 (**NEW**)
- Any questions can be directed to the Fair Office – [info@danecountyfair.com](mailto:info@danecountyfair.com) or 608-291-2900

# OVERVIEW – GROUNDS MAP

Swine is now in the NW Corner of Pavilion 2 – more details to come

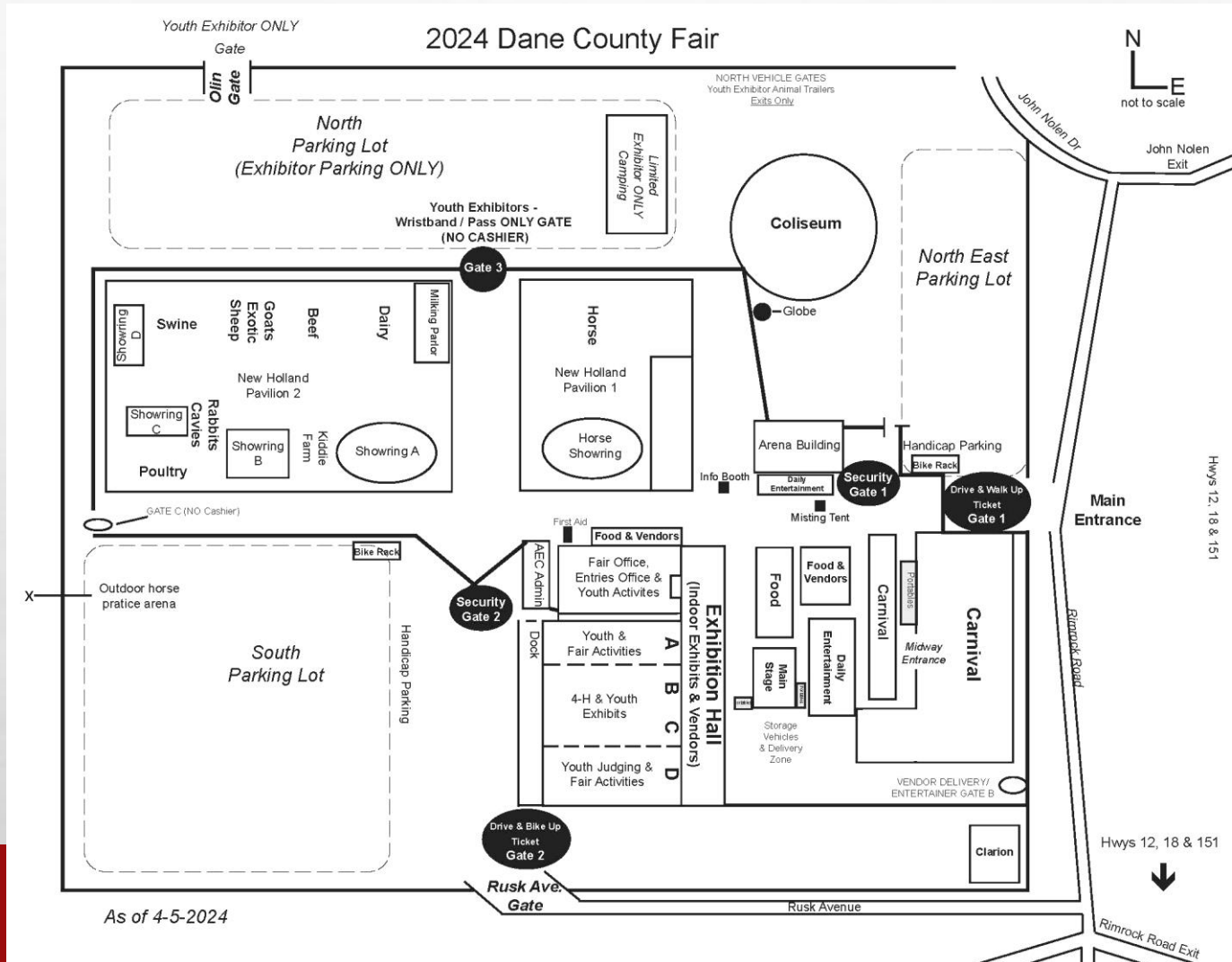

Hwys 12, 18 & 151



Rimrock Road Exit

# OVERVIEW – FAIR SHIRT

- Purchase via FairEntry or by order form with check located on the [Fair Merchandise](http://www.danecountyfair.com) page at [www.danecountyfair.com](http://www.danecountyfair.com).
- Shirts will be distributed with packets to Club/Chapter Leaders at pick up on June 26.
- Color will be Orange
  - \$13/shirt for XS-XL
  - \$15/shirt for 2XL
  - \$16/shirt for 3XL and 4XL





# ENTRIES - FAIRENTRY

- Entry process will remain the same – online through [FairEntry](#).
  - **Closes Saturday, June 1, 2024 at 11:59pm.**
  - Payments will be processed by credit card via FairEntry or check (by June 9) mailed directly to the Fair Office (PO Box 287, Oregon, WI 53575).
  - Entries, shavings/bedding, Fair shirts, privacy panels, etc. all processed through FairEntry.
  - [Family admission wristbands & day tickets](#) (NEW) will NOT be processed through FairEntry & will use a [new ticketing system](#).
  - [Guide to Entries](#) & [Exhibitor Resource](#) – Great reference tool! (website: **Youth Exhibitors/Online Entries-FairEntry**)
  - **Late Entries will be accepted for \$25/submission June 2-8, 2024, 11:59pm.** Submission is defined as one or multiple Department/Class/Lot entries in one transaction per exhibitor. Entries will NOT be accepted after 6/8.
- Fair Premium Book & FairEntry link is located on the [Youth Exhibitors](#) page at [www.danecountyfair.com](http://www.danecountyfair.com).
- **ALL FairEntry questions - [entries.danecountyfair@gmail.com](mailto:entries.danecountyfair@gmail.com) or 608-889-0026 (NEW).**

# ENTRIES - FAIRENTRY

- After June 1, Club/Chapter Leaders will receive an email summary of member exhibitors, entries, and fees. **Leaders MUST review and reply to the email with approval by NOON on June 9.**
  - Late entries will be shared as received (June 2-8).
- Club/Chapter Leader entry tag packet pick-up will be on **June 26 (5pm-7pm) at AEC – Exhibition Hall.**
- **NEW THIS YEAR –**
  - Entry fee is \$8 & ALL youth entries will receive a season wristband to the Fair (including Cloverbuds).
  - [Family Season Wristbands & Day Tickets](#) (NEW) – ability to purchase through our new ticketing site and NOT through FairEntry.
  - Verify Department Class & Lot in the [Premium Book](#) as some have changed or were added.
  - [Department 35](#) – Enter a group school or school class/club project entry at the Fair! [CLICK HERE](#) to view the information packet with more details on how to enter group exhibits. Students who participate in the school or school class/club entry will receive complimentary admission to the Fair for one day.

# ENTRIES – FAIRENTRY REMINDERS

- Exhibitors MUST select the Club/Chapter you are submitting the entry under (4-H, FFA, etc.)
- Select Exhibitor Entry Fee & Season Wristband (\$8.00) for individual entries – NOT Club Entry (\$0.00)
- Make sure to register ALL entries for EACH EXHIBITOR in the family **BEFORE** clicking SUBMIT.
  - Once submitted, two emails will be received. Only AFTER the 2<sup>nd</sup> email approving entries, can you add additional items or entries. To remove any item or for any questions, contact the Fair Entries Dept. at [entries.danecountyfair@gmail.com](mailto:entries.danecountyfair@gmail.com) or 608-889-0026 (not 4-H).
- 01-Fair Orders includes options for T-shirts, shavings/bedding, etc. and **NOT FAMILY ADMISSION**
  - Family discounted wristband & day tickets are to be purchased through the Fair's NEW ticketing system through the link noted in FairEntry. They cannot be ordered with entries through FairEntry. Those with a wristband/day ticket may enter through Gate 3 and park in the North Lot.
    - Youth Season Wristband (\$10) & Day Ticket (\$5) – for youth family members attending the Fair, but NOT exhibiting
    - Adult Season Wristband (\$20) & Day Ticket (\$8) – adult family members attending the Fair

# ENTRIES - FAIRENTRY

- [Youth Animal Exhibitor Code of Practice](#) – reference and acknowledgement in FairEntry when processing entries. The Code of Practice for all youth and their family members is listed in the Premium Book and on the website. Make sure to thoroughly read the Code of Practice; it touches on some of the following:
  - Treatment of animals
  - Proof of animal ownership; false ownership is illegal.
  - The use of drugs in animals
  - Any violation of the Code of Practice results in a forfeit of premiums and awards, disqualification for the youth exhibitor for the present Fair year, and a minimum one-year suspension from showing livestock at the Dane County Fair for the youth exhibitor and immediate family members and may result in a loss of eligibility for future shows. Possible civil penalties may be imposed by the proper authorities based on evidence provided by the show of exhibitors in violation of the Federal Food, Drug, and Cosmetic act/or the animal mistreatment, neglect and abandonment laws that apply on the local, state, and national levels.



# ANIMAL PROJECTS (1-11, 13)

- Majority of the schedule is similar to 2023; refer to the Premium Book for Department details.
  - Move-in is Wednesday, July 17 from 12:00pm-8:00pm; swine and sheep start at 9:00am.
    - All market animals MUST arrive by 7:00pm.
  - [Showring Schedule](#) – as of 4/15/24
  - [Move-out](#) will be on Sunday, July 21 at 6:30pm (tack at 5:30pm). (Sale Animals – 4pm Sheep, 4:30pm Beef & Swine)
- Additional [animal health regulations](#) will be required for some species; refer to the Premium Book.
- [Education requirements submission](#) deadline is June 15 via online form. [CLICK HERE](#) to view education offerings and Education Requirement Card for Animals and Horse & Pony (separate cards).
  - ALL education cards MUST be submitted through the Dane County Fair by June 15. If you have a question about which education sessions are approved for the Fair, contact the Fair Office at [info@danecountyfair.com](mailto:info@danecountyfair.com)

# ANIMAL PROJECTS (1-11, 13)

- Pocket Pets UPDATES: will be held on Tuesday, July 16 for check-in (6pm-7pm) and judging (7pm) in Exhibit Hall B & C and will return home with youth exhibitor post judging.
- Dog UPDATES:
  - NOW at Fair on Sunday, July 21 – ALL Shows. See Premium Book for more details.
- Dairy UPDATES:
  - Showmanship Clinic on Thursday, July 18 at 5:00pm.
  - Pizza Party on Thursday, July 18 will be at 6:00pm in Pavilion 1 – Mezzanine (2<sup>nd</sup> Floor).

# ANIMAL PROJECTS (1-11, 13)

- Swine UPDATES:

- Registration is Saturday, April 20 between 9am-11am at 4-H Office.
- **NEW LOCATION:** Pens and Showring are moving to Pavilion 2, Northwest Corner. Details to come.
- **NEW TIME:** Show is at 8:30am on Friday, July 19.
- Additional health certificates required showing a negative herd test for PRRS and PEDv.

- Sheep UPDATES:

- Market lambs tagged on Saturday, April 27 between 9am-11am at Stoughton Fairgrounds.
- **NEW TIME:** Show is at 3:00pm on Thursday, July 18 in Pavilion 2, Showring B.

# ANIMAL PROJECTS (1-11, 13) CONT.

- Dairy Goats UPDATES:

- YQCA Required & Education requirements start in 2024.

- Poultry UPDATES:

- Pullorum testing will be required. *Testing opportunities to come soon.*

- Plans for the Meat Animal Sale and Small Animal Market Sale are managed by those respective committees and is independent from the Dane County Fair. Contact them directly with any questions; contact information listed in Premium Book.

- Meat Animal Sale – Friday, July 19 at 6:45pm in Pavilion 2, Showring B
- Small Animal Market Sale – Saturday, July 20 at 7:00pm in Pavilion 2, Showring C



# ANIMAL PROJECTS (1-11, 13) CONT.

- **Master Showman:**

- Details are located in the Premium Book and on the website at [www.danecountyfair.com](http://www.danecountyfair.com).

- **Dress-A-Critter:**

- Sunday, July 21 at 11:30am in Pavilion 2, Showring B.
- 1 entry per club, 1 animal per entry, and up to 4 club members per entry.
- All club entries receive a cash prize.
- Entries are due by 5:00pm on Saturday, July 20; forms will be located in the Fair Office, Mendota 1.
- Details are located in the Premium Book and on the website at [www.danecountyfair.com](http://www.danecountyfair.com).

# ANIMAL PROJECTS (1-11, 13) CONT.

- Rockstars in the Ring

- A livestock show for youth with an intellectual disability to have the opportunity to show swine, a rabbit, or sheep.
- **NEW DAY & TIME:** Saturday, July 20 at 2:00pm (Mentor training at 1:00pm) in Pavilion 2, Showring B.
- Limited to 10 participants + mentors.
- **NEED** Mentors to work with youth participants and education them how to show with their animal (swine, rabbit, sheep).
- Details and forms for Participants and Mentors are located on the Rockstars in the Ring page at [www.danecountyfair.com](http://www.danecountyfair.com). **Deadline to sign-up is June 15.**

# ANIMAL PROJECTS (1-11, 13) CONT.

- **Dane County Farm Bureau Educational Grant** – The Dane County Farm Bureau is offering youth exhibitors the opportunity to apply for an educational grant to create an informative display about their animal project! The display will help educate Fair attendees about the animals at the Fair and the story of agriculture! **[CLICK THIS LINK](#)** to view more information and the application.  
**Deadline to apply is June 7, 2024.**
  
- **AgrAbility Demonstration** – Saturday, July 20 at 3:00pm in Pavilion 2, Showring A.
  - Cattle showing with a track wheelchair demonstration and other equipment demonstrations.
  - More details to come.

# ANIMAL PROJECTS (1-11, 13) CONT.

- **Ag Olympics** – Saturday, July 20 at 5:00pm in Pavilion 2, Showring A.
  - All Exhibitors welcome and free to participate!
  - Each species group will work as a team to complete a relay race against the other species groups. The relay race will be split into grade divisions and include a variety of farm activities. The winning team for each grade division earns bragging rights and a banner to hang in their species area until next year's Ag Olympics.
  - More details to come.



# ANIMAL PROJECTS (1-11, 13) CONT.

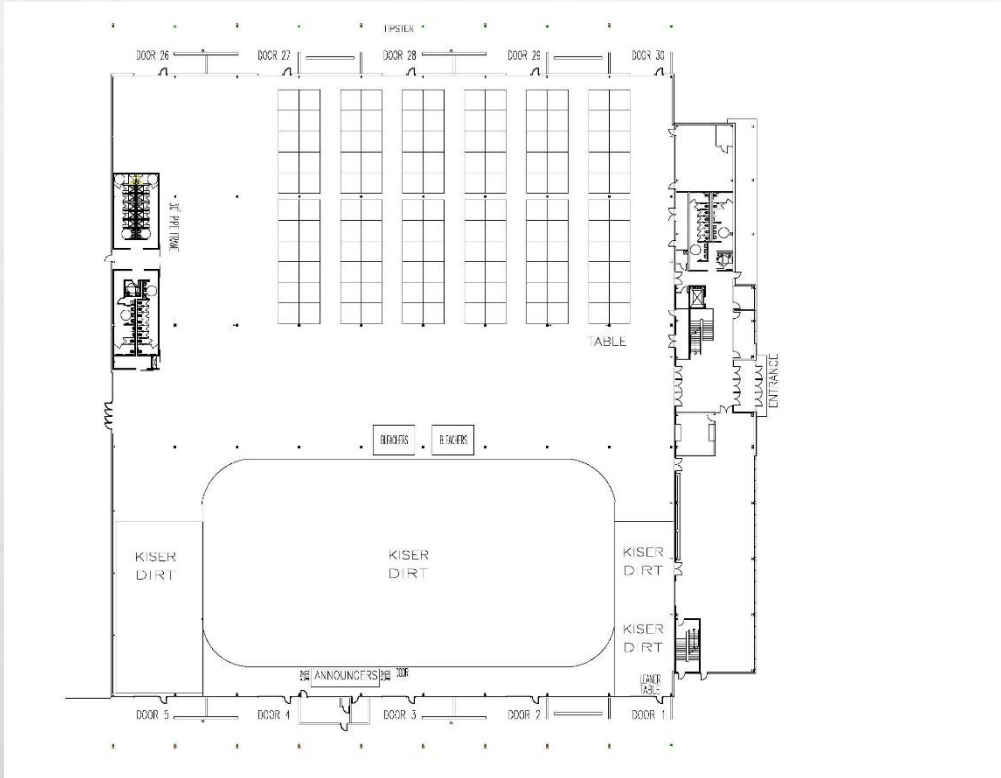

- Pavilion 1 – Horse & Pony

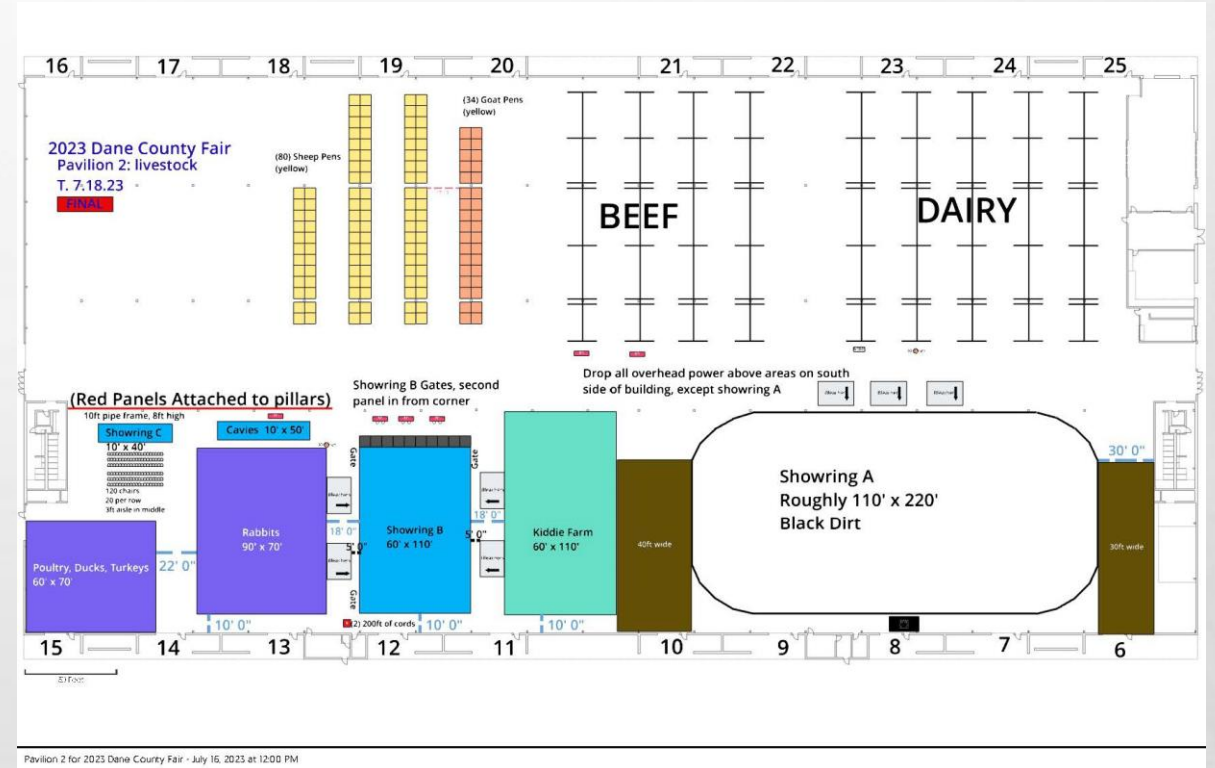

- Pavilion 2 – Swine will be moved to NW Corner

# YOUTH EXHIBITOR PROJECT FLOW (ANIMAL)

## Entries

- Open 4/17/24
- Close 6/1/24 at 11:59pm, Late entries deadline 6/8
- Animal Education requirements due by 6/15/24 via online form – [CLICK HERE](#)
- Packets available June 26 (Leaders only)

## Move-in

- Wednesday, July 17 from 12pm-8pm, market by 7pm (sheep & swine start at 9am)
- Only animal projects will move-in on Wednesday
- Refer to the Department listing in the Premium Book for check-in times

## Judging

- Schedule noted in the Premium Book per Department
- Animals displayed during Fair (July 18-21)

## Move-out

- Sunday, July 21 at 6:30pm (tack 5:30pm) – sale animals earlier (4pm & 4:30pm)
- No overnight stays of exhibitors or guardians are permitted on Sunday night
- Approved Swine may be left overnight to depart by 7:30am on Monday

# NON-ANIMAL PROJECTS (10-34)

- Foods & Nutrition ONLY will be held Monday, July 15 in Exhibit Hall A; view Department information in [Premium Book](#) for check-in and judging times.
- Project check-in & judging will be held Tuesday, July 16 in Exhibit Hall B & C during the times listed for each Department; all but a few departments are 1:00pm-7:00pm.
- **NEW:** Check-out will be held Sunday, July 21 from 4:30pm-6:30pm only.
  - Enter WEST doors from South Parking Lot to access Exhibition Hall, NOT North Doors. Exit through Dock. Animal exhibitors may Exit through North Doors.
- Office hours will be available during check-in/check-out hours via phone to answer any questions.
- Refer to the Fair Premium Book on the [Youth Exhibitors](#) page on [www.danecountyfair.com](http://www.danecountyfair.com) for more department details.

# NON-ANIMAL PROJECTS (10-34)

- Shooting Sports:

- All disciplines will be held this year.
- Fair Shoot –
  - May 18 at Stoughton Conservation Club (Air & .22 Rifle) – **ENTRIES CLOSED MAY 1**
  - June 29 at Stoughton Conservation Club (Archery, 3-D Archery, Shotgun, Muzzle Loading, Air Pistol, and .22 Pistol) – **ENTRIES CLOSE JUNE 1**
  - ALL participants are required to participate in Class I: Wildlife Ecology Knowledge Challenge on May 18 or June 29; see Premium Book for details.



# NON-ANIMAL PROJECTS (10-34)

- Model Horse, Communication Arts Festival, & Clothing, Knitting and Crocheting Revue will occur in-person on Thursday, July 18 during the Fair in the Exhibition Hall.
  - Model Horse – Hall D
  - Communication Arts Festival and Clothing, Knitting and Crocheting Revue – Mendota 6-7
    - Clothing, Knitting, Crocheting Revue items are **required** to be checked-in on Tuesday, July 16 and picked up from the Department area on Thursday for the Revue.
- Danish judging remains the same structure and times are noted under Department listings.
- Post judging, projects will be displayed in the Exhibit Halls B & C.

# YOUTH EXHIBITOR PROJECT FLOW (NON-ANIMAL)

## Entries

- Open 4/17/24
- Close 6/1/24 at 11:59pm
- Late Entries deadline 6/8/24 at 11:59pm
- Packets available June 26 (Leaders only pick up)

## Check-in

- Foods & Nutrition on Monday, July 15
- Rest of the Departments is Tuesday, July 16
- Refer to Premium Book for Department schedule

## Judging

- Foods & Nutrition on Monday, July 15
- Rest on Tuesday, July 16
- Refer to Premium Book for Department schedule
- Projects displayed during Fair in Hall B & C

## Check-out

- Occurs Sun, July 21 between 4:30pm-6:30pm only in Halls B & C
- Ex Hall closes at 4:00pm and Doors open at 4:30pm at WEST DOORS of Ex Hall
- Must have claim ticket to collect projects

# OTHER FAIR UPDATES

- Gates will remain open from 8:00am-8:00pm and physically close at 8:00pm. Attendees may only exit between 8:00pm-11:00pm; Fair closes each day at 11:00pm.
  - Gate 3 (between Pavilions) – Exhibitor ONLY Gate – Youth Exhibitors and Family with wristbands/day tickets are able to access the grounds after 8:00pm through Gate 3 ONLY. Your Fair wristband must be shown to gain access to the grounds at all times. Those without wristbands/day tickets must enter Gates 1 or 2.
    - **Recommend having all Exhibitor Family Members, FFA Kiddie Farm Attendants, and Rockstars in the Ring Participants enter through Gate 3 for ease of entry.**
- The Fair Office will be on the 1<sup>st</sup> Floor of the Exhibition Hall in Mendota 1. The Entries Department will be next door in Mendota 2.
- **NEW** ticketing system & Gates 1 & 2 will be drive-up = online tickets scanned or new tickets purchased (credit card or cash) at gates, attendees receive a day wristband, then park and access the grounds via the security walk-up entrance. All wristbands must be worn in order to enter the Fair.
  - Exhibitor & Exhibitor Family Season Wristbands can be shown to ticket sellers at Gates 1 & 2 if needed.

# OTHER FAIR UPDATES CONT.

- Food vendors, carnival, main stage tent, entertainment areas are similar to 2023. There will be construction in the area outside Pavilion 1, so Entertainment area 2 will move. Entertainment listed below:
  - Canine Stars Stunt Show near the Main Stage Tent (multiple shows daily)
  - KidBuck\$ Game Show near Arena Building (multiple shows daily)
  - Kiddie Farm (daily)
  - Magical Bubbles (Thursday-Sunday)
  - ACME Magic Show (multiple shows daily & strolling)
  - More music and community acts during the day on the Main Stage
  - Music = Madison County (Thu), Totally Neon (Fri), Wisconsin Singers (Sat afternoon), Life 102.5 Concert with ~two artists (Sat), LaMovida contests and bands (Sun)
- Camping – if camping at the DCF, exhibitor camping can be in the North Lot or on Willow Island.



# OTHER FAIR UPDATES CONT.

- Theme Days – Hometown Hero Day (Thu), Kids Day (Fri), Farm Fresh Day (Sat), Family Day (Sun)
  - Thu = Hometown Heroes and guest receive FREE admission, Discount Admission by 5pm, Resource Fair, Madison Roller Derby; Fri = Discount Admission by 5pm discount, Kids Day Activities, Kiddie Tractor Pedal Pull, ESPN; Sat = Tractor Parade/Rides, AgrAbility Demo, Rockstars in the Ring, Ag Olympics; Sun = Master Showman, Dress-A-Critter & Awards Ceremony.
- Carnival will be open until 10:30pm each night. Discount wristbands for youth exhibitors on Friday or Saturday from Noon-5:00pm...coupon included with your entry tags.
- Fair Awards Ceremony & 4H Graduation – Sunday, July 21 at 2:30pm in **Hall A (NEW LOCATION)**.
- 4-H Party – Saturday, July 20 in Pavilion 1 – Mezzanine area starting at 7pm.
- Refer to the Fair website ([danecountyfair.com](http://danecountyfair.com)) for more details on music, entertainment, food vendors, schedule, etc.

# DEPARTMENT NEEDS

---

**Dairy Goats & Exotics** – Dept. 5 & 11  
(Chair/Superintendents)

**Woodworking** – Dept. 22  
(Chair/Superintendents)

Shooting Sports – Dept. 16  
(Chair)

Knitting & Crocheting – Dept. 27  
(Superintendents)

**Cultural Arts** – Dept. 18  
(Chairs/Superintendents) – **starting 2025**

Home Furnishings/Home Environment – Dept. 28  
(Superintendents)

Photography – Dept. 20  
(Superintendents)

Plant & Soil Science – Dept. 14  
(Superintendents)

---

- We need Chairs/Superintendents for these Departments. **BOLD** is an immediate need!
- If you know of anyone who may be willing to assist the Fair in these departments, have them complete the [Chair/Superintendent Application](#) or contact Danielle Ziegler at [info@danecountyfair.com](mailto:info@danecountyfair.com).

# VOLUNTEER AT THE FAIR

- **Fair Gift Shed (merchandise booth)** – Looking for 2-4 people per shift from 4-H Clubs, FFA Chapters or other Youth Organizations to volunteer and work our Fair Gift Shed during the Fair. Hours are in 2-hour shifts – Thursday (2pm-4pm), Friday (12pm-2pm & 5pm-7pm), Saturday (12pm-2pm & 5pm-7pm), and Sunday (12pm-2pm). To sign up, [CLICK HERE](#) (code **DCF2024**) to view our SignUp Genius form. Each volunteer receives an appreciation snack.
- **4-H Volunteering at the Fair** - To sign up for any of the opportunities below, [CLICK HERE](#) to view the 4-H page where all Fair volunteer opportunities through 4-H will be available.
  - [Cloverbud Evaluators](#) – Looking for youth evaluators (8<sup>th</sup> grade and up) to review Cloverbud projects on Tuesday, July 16 from 1pm-7pm at Alliant Energy Center in Exhibition Hall B&C. *Click Cloverbud link to sign up!*
  - [Non-Animal Project Protectors](#) – Looking for volunteers to share information about 4-H and protect the non-animal department projects inside the Exhibition Hall during the Fair. The Hall is open Thu-Sat 8am-8pm and Sun 8am-4pm.
  - **Small Animal Project Protectors** – Looking for volunteers to share information about 4-H and protect the small animal department projects inside Pavilion 2 during the Fair.



**SEE YOU AT THE  
DANE COUNTY FAIR  
JULY 18-21, 2024**

**ALLIANT ENERGY CENTER**

