



KNOXVILLE

CONVENTION CENTER

701 HENLEY STREET, KNOXVILLE, TN 37902

865.522.5669 | INFO@ASMKNOXVILLE.COM

WWW.KCCASM.COM

FLOOR ONE

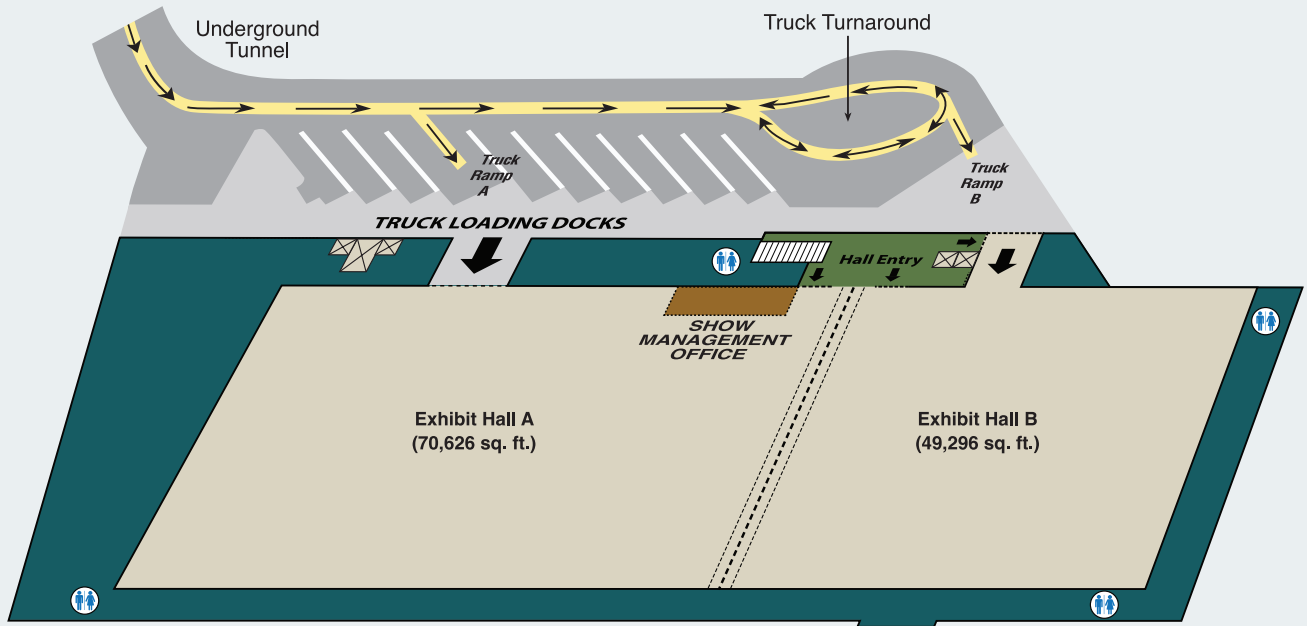

FLOOR TWO

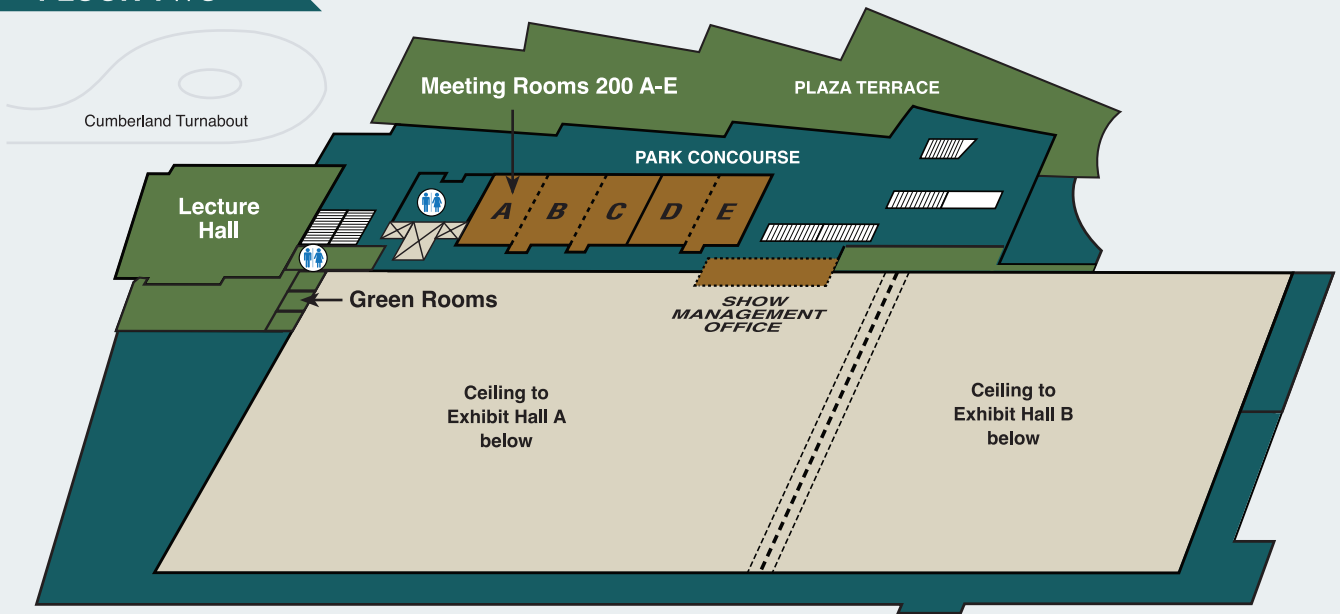

FLOOR THREE

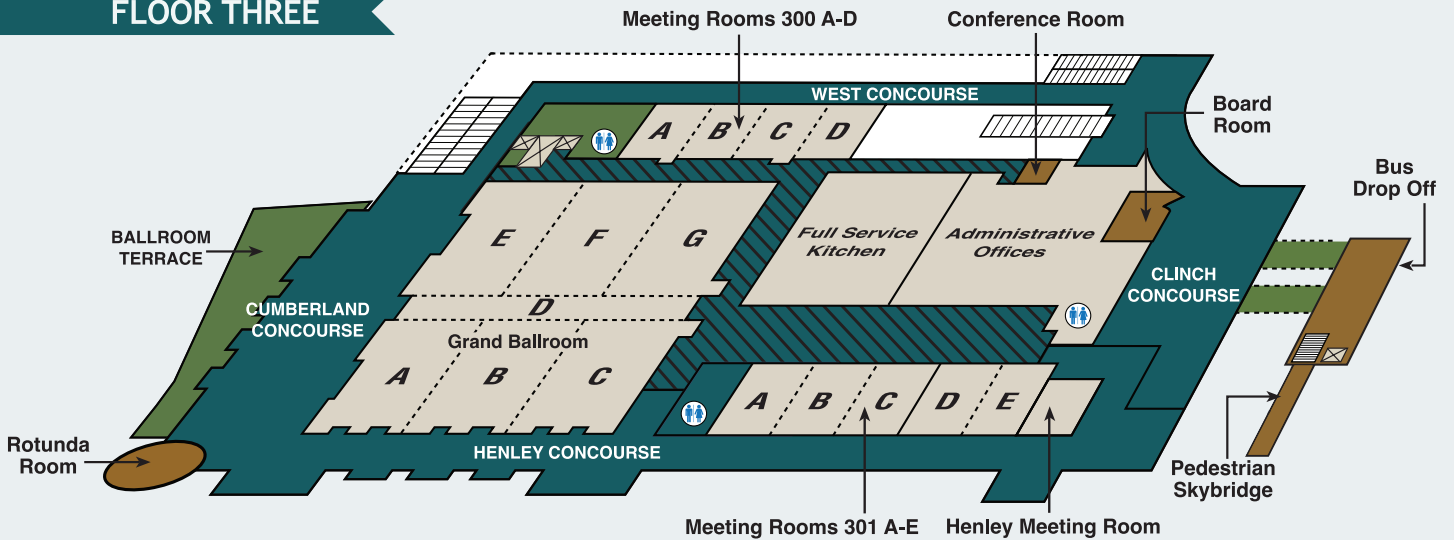

Space Specifications

1st Floor

Space	Gross Sq. Ft.	Dimensions (L x W x H)	Theater	Banquet	Classroom	Booths (10 x 10)	Courts Basketball Volleyball
Exhibit Hall AB	120,000	506' x 237' x 30'	10,115	5,050	5,113	620	10-B / 20-V
Exhibit Hall A	70,626	298' x 237' x 30'	6,285	3,050	3,564	386	6-B / 12-V
Exhibit Hall B	49,296	208' x 237' x 30'	3,996	2,020	2,244	249	3-B / 8-V
Hall A Show Office	1,728	48' x 36' x 12'	-	-	-	-	-
Hall B Show Office	149	9' x 16.5' x 10'5"	-	-	-	-	-
Show Overlook	1,083	19' x 57' x 9'5"	-	50	36	-	-

2nd Floor

Space	Gross Sq. Ft.	Dimensions (L x W x H)	Theater	Banquet	Classroom	Conference	Booths (10 x 10)
Lecture Hall	5,700	15'4" H	460	-	460	-	-
Green Rooms 1-3	100	10' x 10'	-	-	-	-	-

Meeting Rooms 200

200 A	1,457	47' x 31' x 16'	147	60	84	50	-
200 B	1,363	47' x 29' x 16'	147	60	84	50	-
200 C	1,316	47' x 28' x 16'	147	60	70	50	-
200 D	1,410	47' x 30' x 16'	147	60	84	50	-
200 E	1,222	47' x 26' 16'	126	60	70	48	-
200 ABC	4,136	88' x 47' x 16'	400	240	252	112	-
200 DE	2,632	56' x 47' x 16'	260	120	168	80	-

2nd Level Public Function Space

Park Concourse (West)	6,240	240' x 26' x 45'	-	450	-	-	29
Plaza Terrace (West - External)	19,080	360' x 53'	-	-	-	-	-

3rd Floor

Space	Gross Sq. Ft.	Dimensions (L x W x H)	Theater	Banquet	Classroom	Conference	Booths (10 x 10)
Information Center	154	7' x 22' x 13'	-	-	-	-	-
Henley Meeting Room	425	25' x 17' x 11'3"	-	12	12	12	-
Rotunda Room	1100	37' in diameter, 444"	100	60	48	32	-
Board Room	775	31' x 25' x 9'4"	-	32	-	18	-
Conference Room	486	18' x 27' x 11'3"	-	-	-	15	-

Grand Ballroom

Grand Ballroom A-G	27,300	195' x 140' x 28'6"	2,640	1,650	1,860	-	145
Ballroom A	3,864	84' x 46' x 28'6"	400	180	222	96	20
Ballroom B	3,864	84' x 46' x 28'6"	400	180	222	96	20
Ballroom C	3,864	84' x 46' x 28'6"	400	180	222	96	20
Ballroom D	3,500	140' x 25' x 28'6"	-	-	-	-	-
Ballroom E	3,864	84' x 46' x 28'6"	400	180	222	96	20
Ballroom F	3,864	84' x 46' x 28'6"	400	180	222	96	20
Ballroom G	3,864	84' x 46' x 28'6"	400	180	222	96	20
Ballroom ABCD or DEFG	15,092	140' x 109' x 28'6"	1,440	800	966	-	74

Meeting Rooms 300

300 A	972	36' x 27' x 14'4"	95	50	60	32	-
300 B	1,080	36' x 30' x 14'4"	95	50	60	32	-
300 C	972	36' x 27' x 14'4"	95	50	60	32	-
300 D	1,152	36' x 32' x 14'4"	95	50	60	32	-
300 AB	2,052	57' x 36' x 14'4"	192	120	120	64	-
300 CD	2,124	59' x 36' x 14'4"	192	120	120	64	-

Meeting Rooms 301

301 A	1,537	29' x 53' 16'	147	70	88	48	15
301 B	1,537	29' x 53' 16'	147	70	88	48	15
301 C	1,537	29' x 53' 16'	147	70	88	48	15
301 D	1,537	29' x 53' 16'	147	70	88	48	15
301 E	1,537	29' x 53' 16'	147	70	88	64	15
301 ABC	4,611	87' x 53' x 16'	460	260	276	144	34
301 DE	3,074	58' x 53' x 16'	320	150	192	104	25

3rd Level Public Function Space

Clinch Concourse (North)	6,900	138' x 50' x 22'	-	-	-	-	23
Henley Concourse (East)	12,000	400' x 30' x 16'	-	-	-	-	23
Cumberland Concourse (South)	10,500	210' x 50' x 14'	-	-	-	-	31
West Concourse (West)	2,520	180' x 14' x 16'	-	-	-	-	-
Ballroom Terrace (External)	4,250	170' x 25'	-	-	-	-	-

HIGHLIGHTS

Facility

- Adjacent to Multiple Hotels
- Downtown Access via Pedestrian Bridge and Covered Walkways
- Two Exterior Digital Marquees for Prominent Visibility
- \$1 Million Dollar Commissioned Art Collection Representing the Beauty and History of East Tennessee
- Naturally Lighted Concourses Throughout the Building
- Fully ADA Compliant
- Non-Union Facility
- Silver LEED Certified
- Dedicated Internet Provider by In-House IT and Complimentary Wi-Fi in Meeting Rooms and Concourses
- In-House Exclusive Catering Service by SAVOR
- Option to Provide Your Own Audio/Video or Utilize Our In-House Preferred Vendor
- In-House Vendor Services

Exhibit Halls

- Underground Loading Dock with Nine Truck Bays for Easy Off Loading
- Drive-on Access Via Two Ramp Doors with 27'W x 16'H Freight Doors
- Concession Areas and Two Sets of Restrooms Located in Each Hall
- Total of 119,922 Square Feet May Be Subdivided into Hall A (70,626) and Hall B (49,296)
- Electrical Services of 208/120V 3 Phase 5 Wire 100 Amp and 208/120V 3 Phase 30 Amp are Available at Every Floorport
- In-House Service for Electrical, Plumbing, and Communication Service in Floor Ports on 30' Centers

Grand Ballroom

- 27,000 Square Foot Grand Ballroom with 28' 6" Ceilings
- Subdivides For Up to Six Meeting Room Options
- Sound Absorbent Air Walls
- Full Rental Includes Two Beautiful Spacious Concourses and Terrace

Meeting Rooms

- 20 Individual Meeting Rooms
- Natural Light and Individual Lighting Panels for Control of Incandescent/Fluorescent Lighting
- Built-In Sound System Ideal for Public Address
- Digital Signature Outside Meeting Rooms

Specialty Spaces

- 19,080 square feet outdoor Plaza Terrace adjacent to World's Fair Park
- Rotunda with Working Fireplace, Natural Light, and Accommodates up to 100 for events
- Board Room and Conference Rooms Available
- Lecture Hall Seats 460 Theater-Style with Cushioned Seats and Flip-Top Writing Desks

