



EAST

NORTH

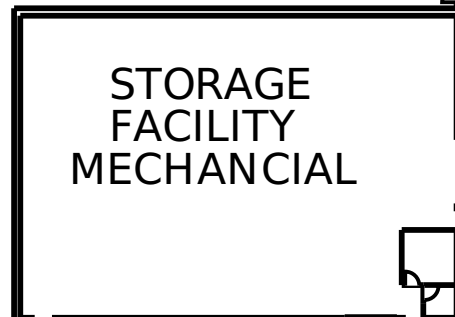

EXHIBIT HALL 3

33,902 SF

211X154

EXHIBIT HALL 2

18,480 SF

120X154

EXHIBIT HALL 1

14,014 SQ

91X154

SOUTH

LOADING DOCK

DOCK RAMP

STORAGE

REST ROOMS

STORAGE

REST ROOMS

CONCESSION

SHOW OFFICE
32'X18'

PROMENADE 4,650 SQ. FT.

HOLIDAY INN
ELEVATOR & ESCALATOR

WEST