

In order to ensure that the Ada Cemetery receives the appropriate care and maintenance, the City of Ada has adopted certain rules and regulations which you should be aware of before purchasing a lot in the cemetery.

- All interments in lots shall be restricted to members of the immediate family of lot owner.
- All caskets must be placed in an outer container constructed of non-deteriorating material.
- No interments may be made until all rules concerning interments have been met and the lot paid for.
- No portion of a cemetery lot may be sold or disposed of except to a relative or to the City of Ada.
- The lot shall only be used for the burial of human remains and the placing of appropriate memorials.
- No monument may be constructed of a non-permanent material such as wood or sandstone.
- All markers in the Cemetery Second Addition shall be of a flat nature and placed flush with the ground.
- No individual may plant trees, plants, shrubs, or place fences or artificial flowers in the Second or Third Addition.
- The planting of trees, plants, shrubs, and the placement of fences and artificial flowers is allowed in the old section with the condition that the care and maintenance shall be the responsibility of the lot owner and the City may remove them if they are diseased, damaged, dead in a state of disrepair or interferes with adjoining lots.
- The lot owner shall be responsible for the settling of grave lots dug within 12 months after burial.
- The purchaser agrees that their rights are subject to reasonable rules and regulations that the City may adopt.
- Other general regulations apply to all visitors on cemetery property.

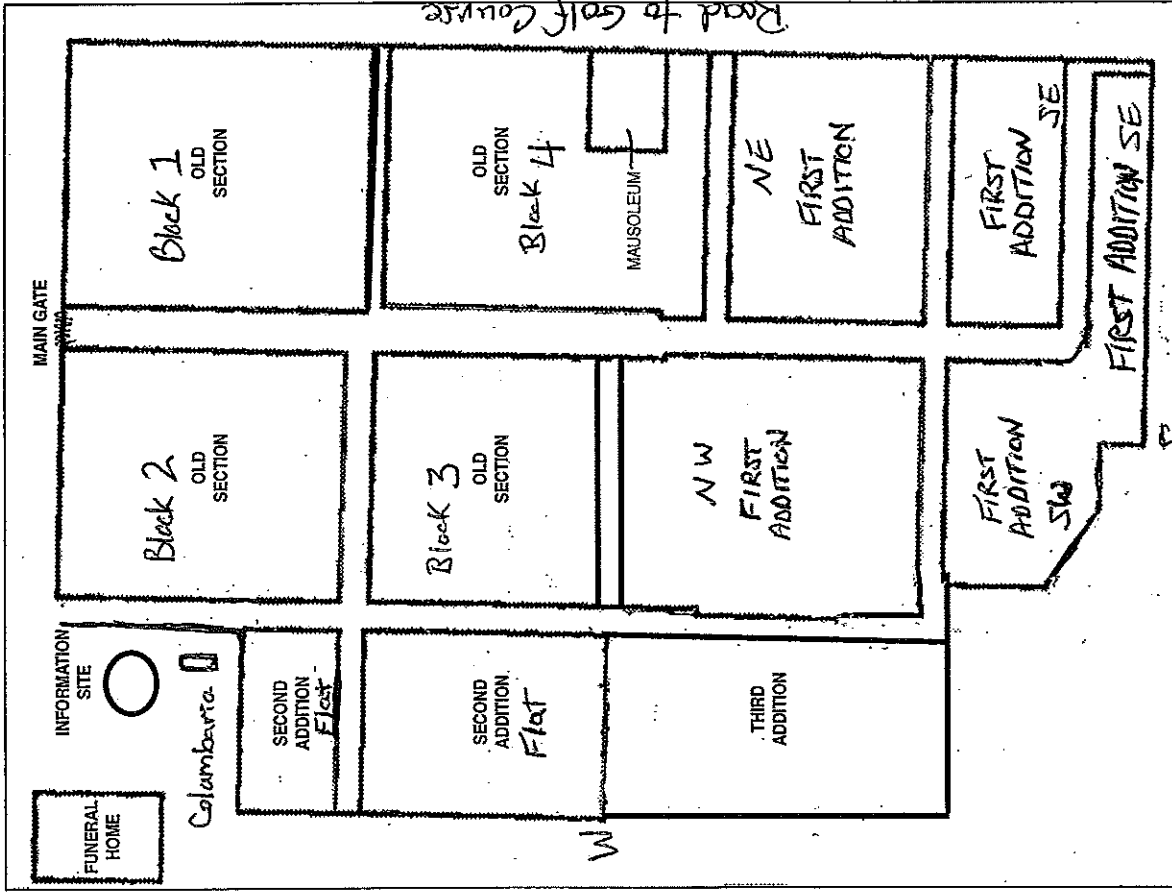

- A copy of all rules and regulations is available to you at the City of Ada offices located at 15 East 4th Avenue, or by calling 218-784-5520.
- Specific questions concerning Cemetery lots should be directed to the City Clerk at the City of Ada offices.