



# 2025 DANE COUNTY FAIR

**JULY 17-20, 2025**

**ALLIANT ENERGY CENTER**

***INFORMATION AS OF APRIL 15, 2025***



# OVERVIEW

- Dates: Thursday, July 17 – Sunday, July 20; celebrating 175 years!
- Schedule, maps, and details will be listed on the Fair's website – [www.danecountyfair.com](http://www.danecountyfair.com)
- Fair Premium Book located on the [Youth Exhibitors](#) page at [www.danecountyfair.com](http://www.danecountyfair.com)
- **Entries Questions** – [entries.danecountyfair@gmail.com](mailto:entries.danecountyfair@gmail.com) or 608-880-0026
- Other Fair questions can be directed to the Fair Office – [info@danecountyfair.com](mailto:info@danecountyfair.com) or 608-291-2900

# OVERVIEW — GROUNDS MAP

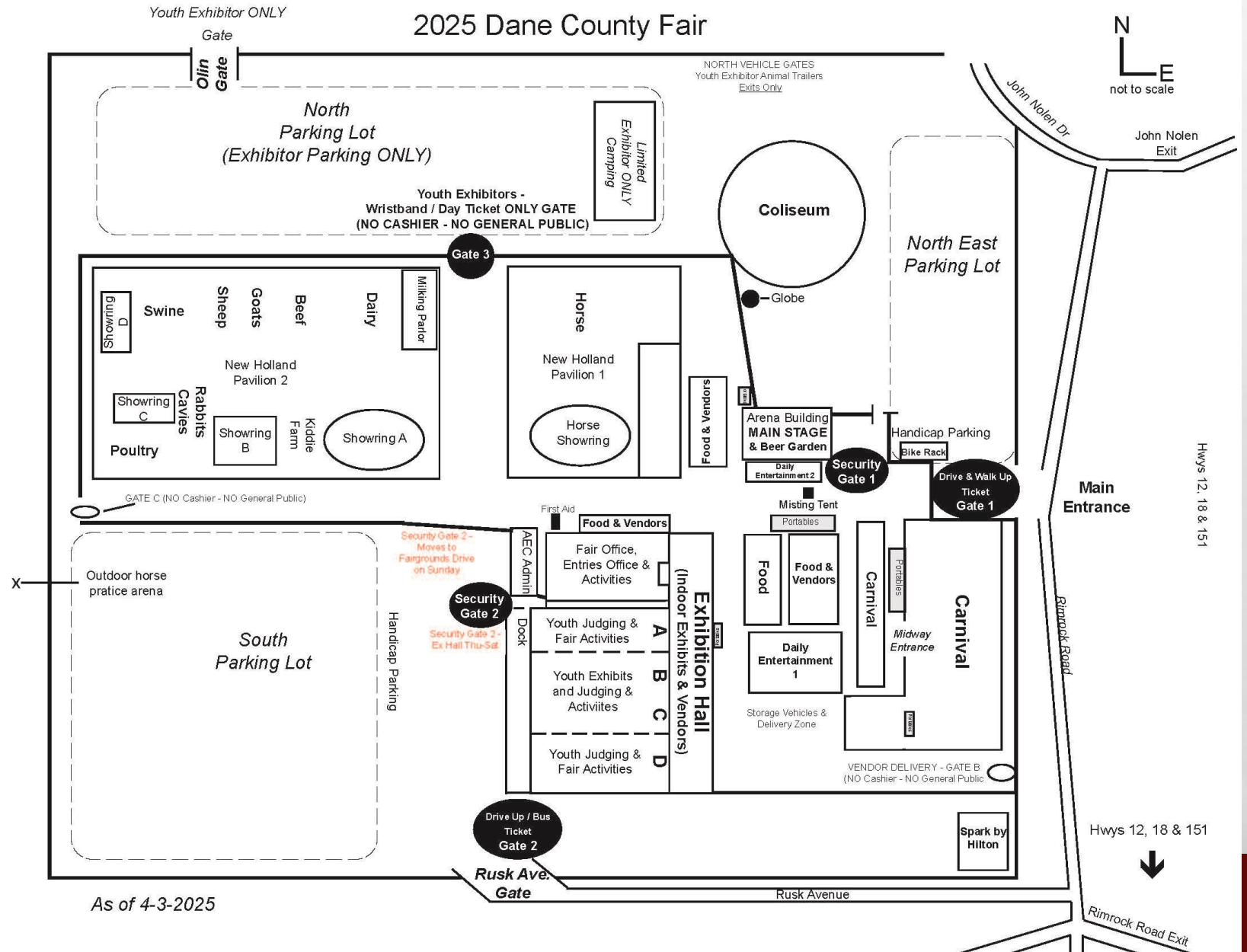

# OVERVIEW – FAIR SHIRT

- Purchase via **NEW Merchandise purchasing link** via credit card located on the [Fair Merchandise](#) page. (*not FairEntry*)
- Shirts will be distributed with packets to Club/Chapter Leaders at pick up on June 25 between 5pm-7pm.
- Color will be Royal Blue
  - \$14/shirt for Youth sizes XS-XL
  - \$14/shirt for S-XL (adult sizes)
  - \$16/shirt for 2XL (adult sizes)
  - \$17/shirt for 3XL and 4XL (adult sizes)



# ENTRIES - FAIRENTRY

- Entry process will remain the same – online through [FairEntry](#).
  - **Closes June 1 at 11:59pm.**
  - Payments processed by credit card via FairEntry or check (by June 9) mailed directly to the Fair Office (PO Box 287, Oregon, WI 53575).
  - Entries, animal fees, shavings/bedding, and Horse & Pony privacy panels all processed through FairEntry.
  - [Family admission wristbands & day tickets](#) may be purchased through our [ticketing system](#) and **not** through FairEntry.
  - **NEW:** [Fair T-shirts and Fair merchandise](#) may be purchased through our [merchandise system](#) and **not** through FairEntry.
  - [Guide to Entries](#) & [Exhibitor Resource](#) – Great reference tool! (website: **Youth Exhibitors/Online Entries-FairEntry**)
  - **Late Entries will be accepted for \$25/submission June 2-8, 11:59pm.** Submission is defined as one or multiple Department/Class/Lot entries in one transaction per exhibitor. Entries will **NOT** be accepted after 6/8.
- Fair Premium Book & FairEntry link is located on the [Youth Exhibitors](#) page at [www.danecountyfair.com](http://www.danecountyfair.com).
- **ALL FairEntry questions - [entries.danecountyfair@gmail.com](mailto:entries.danecountyfair@gmail.com) or 608-889-0026.**

# ENTRIES - FAIRENTRY

- After June 1, Club/Chapter Leaders will receive an email summary of member exhibitors, entries, and fees. **Leaders MUST review and reply to the email with approval by NOON on June 9.**
  - Late entries will be shared as received (June 2-8).
- Club/Chapter Leader entry tag packet pick-up will be on **June 25 (5pm-7pm) at AEC – Exhibition Hall.**
- **REMINDERS/NEW THIS YEAR –**
  - Entry fee is \$8, and ALL youth exhibitors will receive a season wristband to the Fair (including Cloverbuds).
    - Select Exhibitor Entry Fee & Season Wristband (\$8.00) for individual entries – NOT Club/Cloverbud Entry
  - Club/Chapter and Cloverbud entries are FREE.
  - Verify Department Class & Lot in the Premium Book as some have changed or were added.
  - Exhibitors MUST select the Club/Chapter you are submitting the entry under (4-H, FFA, Other Org, etc.)
  - Make sure to register ALL entries for EACH EXHIBITOR in the family **BEFORE** clicking SUBMIT.
    - Once submitted, two emails will be received. Only AFTER the 2<sup>nd</sup> email approving entries, can you add additional items or entries. To remove any item or for any questions, contact the Fair Entries Dept. at [entries.danecountyfair@gmail.com](mailto:entries.danecountyfair@gmail.com) or 608-889-0026 (**NOT 4-H**).

# ENTRIES – FAIRENTRY REMINDERS

- 01-Fair Orders includes options for shavings/bedding, etc. and **NOT T-SHIRTS/MERCH OR FAMILY ADMISSION**
  - **Shavings/Bedding Orders** – ONLY through FairEntry and **due by June 8**.
  - **Fair T-shirts and other merchandise** - purchase through the Fair's **merchandise system** through the link noted in FairEntry. These items cannot be ordered with entries through FairEntry. All merchandise items purchased by the **June 8 DEADLINE** will be included with the Club/Chapter packet in June and will be distributed by Club/Chapter Leader.
  - **Family discounted wristband & day tickets** - purchase through the Fair's **ticketing system** through the link noted in FairEntry. They cannot be ordered with entries through FairEntry. Those with a wristband/day ticket may enter through Gate 3 and park in the North Lot. Wristbands and Day Tickets purchased by the **June 8 DEADLINE** will be included with the Club/Chapter packet in June and will be distributed by Club/Chapter Leader.
    - Youth Season Wristband (\$10) & Day Ticket (\$5) – for youth family members attending the Fair, but NOT exhibiting
    - Adult Season Wristband (\$20) & Day Ticket (\$8) – adult family members attending the Fair

# ENTRIES - FAIRENTRY

- Youth Animal Exhibitor Code of Practice – reference and acknowledgement in FairEntry when processing entries. The Code of Practice for all youth and their family members is listed in the Premium Book and on the website. Make sure to thoroughly read the Code of Practice; it touches on some of the following:
  - Treatment of animals
  - Proof of animal ownership; false ownership is illegal.
  - The use of drugs in animals
  - Any violation of the Code of Practice results in a forfeit of premiums and awards, disqualification for the youth exhibitor for the present Fair year, and a minimum one-year suspension from showing livestock at the Dane County Fair for the youth exhibitor and immediate family members and may result in a loss of eligibility for future shows. Possible civil penalties may be imposed by the proper authorities based on evidence provided by the show of exhibitors in violation of the Federal Food, Drug, and Cosmetic act/or the animal mistreatment, neglect and abandonment laws that apply on the local, state, and national levels.



# ANIMAL PROJECTS (1-11, 13)

- Majority of the schedule is similar to 2024; refer to the Premium Book for Department details.
  - Move-in is Wednesday, July 16 from 12:00pm-8:00pm; swine and sheep start at 9:00am and goats at 4:00pm.
    - All market animals MUST arrive by 7:00pm.
  - Showring Schedule – as of 2/7/25
  - Move-out will be on Sunday, July 20 at 6:30pm (tack at 5:30pm). (Sale Animals – 4pm Sheep, 4:30pm Beef & Swine)
- Additional animal health regulations will be required for some species; refer to the Premium Book.
- Education requirements submission deadline is June 15 via online form. CLICK HERE to view education offerings and Education Requirement Card for Animals and Horse & Pony (separate cards).
  - ALL education cards MUST be submitted through the Dane County Fair by June 15. If you have a question about which education sessions are approved for the Fair, contact the Fair Office at [info@danecountyfair.com](mailto:info@danecountyfair.com)

# ANIMAL PROJECTS (1-11, 13)

- **Cat Updates:**

- Education requirements are required for the 2025 Fair **by June 15** (not YQCA) – click link to view the options available for Cats.
- Cat Show will now occur in **Hall C** in the back near the other projects in the presentation/judging area. See map for the location. All youth exhibitors and cats will enter through Dock C.

- **Dairy Updates:**

- Lactating Dairy Cattle will follow same protocol as 2024 and HPAI testing will be required for the 2025 Fair as of 4/3/25. Details located HERE.

- **Swine UPDATES:**

- Registration is Saturday, April 19 between 9am-11am at 4-H Office.
- Additional health certificates required showing a negative herd test for PRRS and PEDv.

# ANIMAL PROJECTS (1-11, 13)

- **Sheep UPDATES:**

- Market lambs tagged on Saturday, April 26 between 9am-11am at Stoughton Fairgrounds.

- **NO Exotics Department 11:**

- Due to low numbers in the department and no Chair/Superintendent to manage the department, this department is not being offered for the 2025 Fair.
- All exotic birds will be entered under the Poultry Department – Class I. Exotic Birds
- All exotic/non-meat or dairy goats will be entered under the Goat Department – Class C. Other Goats Showmanship & Class D. Other Goat Breeds
- All equine exotics like donkeys will be entered under the Horse & Pony Department - CLASS K. Draft Breed, Any Other Equine & Horseless Horse English Showmanship
- For other exotics, contact the Fair Office at [info@danecountyfair.com](mailto:info@danecountyfair.com) to discuss options.

# ANIMAL PROJECTS (1-11, 13) CONT.

- Goats UPDATES:

- Department 5 is now labeled as Goats and will include Dairy, Meat, and Exotic Goats
- New Chair – Ben Amera (contact information listed in the Premium Book)
- Goats will include Exotic/Other Breed Goats – Class C. Other Goats Showmanship & Class D. Other Goat Breeds
- Education and YQCA requirements are required for the 2025 Fair **by June 15** – click link to view the options available for Goats.

- Poultry UPDATES:

- Pullorum testing will be required. *Testing opportunities to come soon.*
- Poultry will now include Exotic Birds - Class I. Exotic Birds

# ANIMAL PROJECTS (1-11, 13) CONT.

- **Rabbit and Cavy Drawing – NEW**

- Interested in Rabbits or Cavies? The FREE Rabbit/Cavy Drawing is an excellent opportunity for youth interested in exhibiting rabbits or cavies to get involved with the project. This drawing is open to any 4-H or FFA member not in the project or who only has one rabbit/cavy. If you participate in the drawing and are selected for a rabbit/cavy, you agree to show the animal at the 2026 Dane County Fair (July 16-19, 2026).
- Plans for the **Meat Animal Sale** and **Small Animal Market Sale** are managed by those respective committees and is independent from the Dane County Fair. Contact them directly with any questions; contact information listed in Premium Book.
  - Meat Animal Sale – Friday, July 18 at 6:45pm in Pavilion 2, Showring B
  - Small Animal Market Sale – Saturday, July 19 at 7:00pm in Pavilion 2, Showring C
    - **SAMS Education Card requirements due by June 15** – [CLICK HERE](#) for online submission portal.

# ANIMAL PROJECTS (1-11, 13) CONT.

- **Master Showman:**

- With the addition of Meat Goats, Master Showman will feature 8 animals – Dairy, Beef, Sheep, Swine, Dairy Goat, Meat Goat, Poultry, and Rabbit.
- Details are located in the Premium Book.

- **Dress-A-Critter:**

- Sunday, July 20 at 11:30am in Pavilion 2, Showring B.
- 1 entry per club, 1 animal per entry, and up to 4 club members per entry.
- All club entries receive a cash prize.
- Entries are due by 5:00pm on Saturday, July 19; form is online and will be located in the Fair Office, Mendota 1.
- Details are located in the Premium Book and on the website at [www.danecountyfair.com](http://www.danecountyfair.com).

# ANIMAL PROJECTS (1-11, 13) CONT.

- Rockstars in the Ring

- A livestock show for youth with an intellectual disability to have the opportunity to show swine, a rabbit, or sheep.
- **DAY & TIME:** Saturday, July 19 at 2:00pm in Pavilion 2, Showring B.
  - Lunch at Noon (Mezzanine in P1) & Mentor Training at 1:00pm
- Limited to 10 participants + mentors.
- **NEED** Mentors to work with youth participants and education them how to show with their animal (swine, rabbit, sheep).
- Details and forms for Participants and Mentors are located on the Rockstars in the Ring page at [www.danecountyfair.com](http://www.danecountyfair.com). **Deadline to sign-up is June 15.**

# ANIMAL PROJECTS (1-11, 13) CONT.

- **Dane County Farm Bureau Educational Grant** – The Dane County Farm Bureau is offering youth exhibitors the opportunity to apply for an educational grant to create an informative display about their animal project! The display will help educate Fair attendees about the animals at the Fair and the story of agriculture! [CLICK THIS LINK](#) to view more information and the application. **Deadline to apply is June 6, 2025.**
- **AgrAbility Demonstration** – Saturday, July 19 at 3:00pm in Pavilion 2, Showring A.
  - More details to come.



# ANIMAL PROJECTS (1-11, 13) CONT.

- Ag Olympics – Saturday, July 19 at 5:00pm in Pavilion 2, Showring A.
  - All Exhibitors welcome and free to participate!
  - Each species group will work as a team of 5 to complete a relay race against the other species groups. The relay race will be split into grade divisions and include a variety of farm activities. The winning team for each grade division earns bragging rights and a banner to hang in their species area until next year's Ag Olympics.
  - Sign up is on-site in the Dairy Department by Noon on Saturday, July 19. All participants will be required to complete an online waiver form by Noon on 7/19.

# ANIMAL PROJECTS (1-11, 13) CONT.

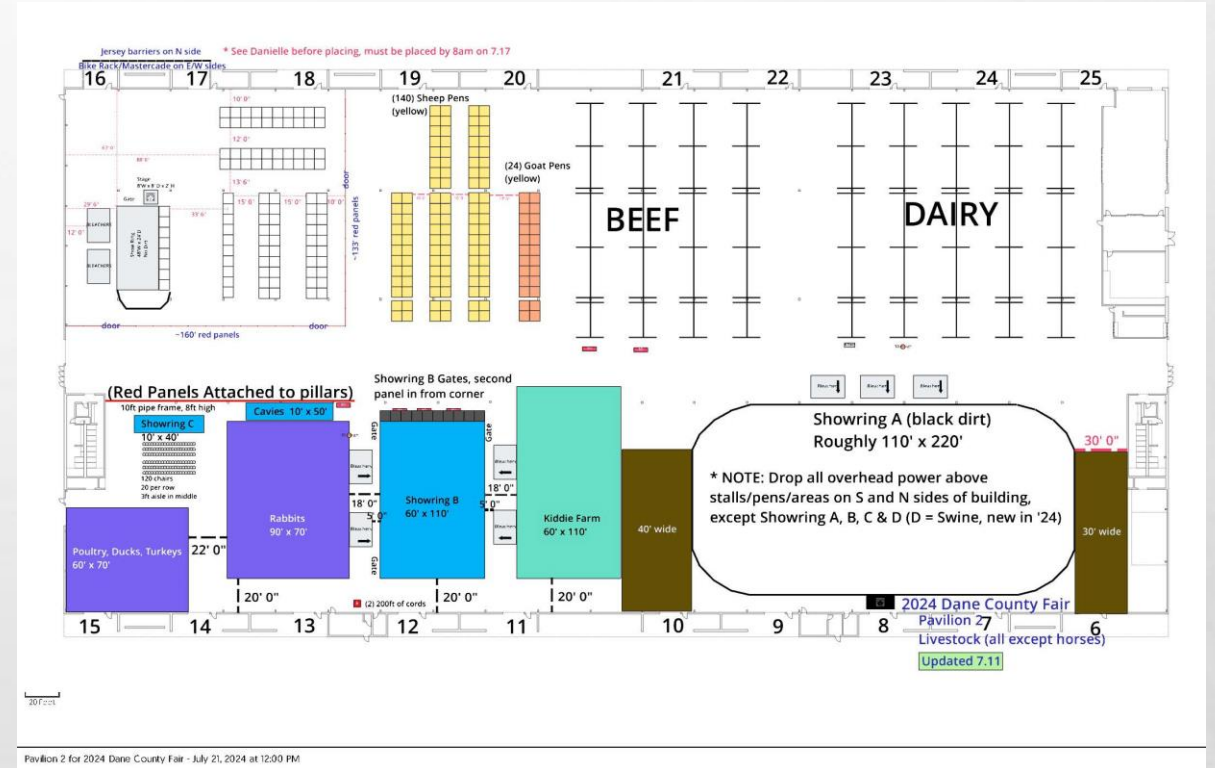
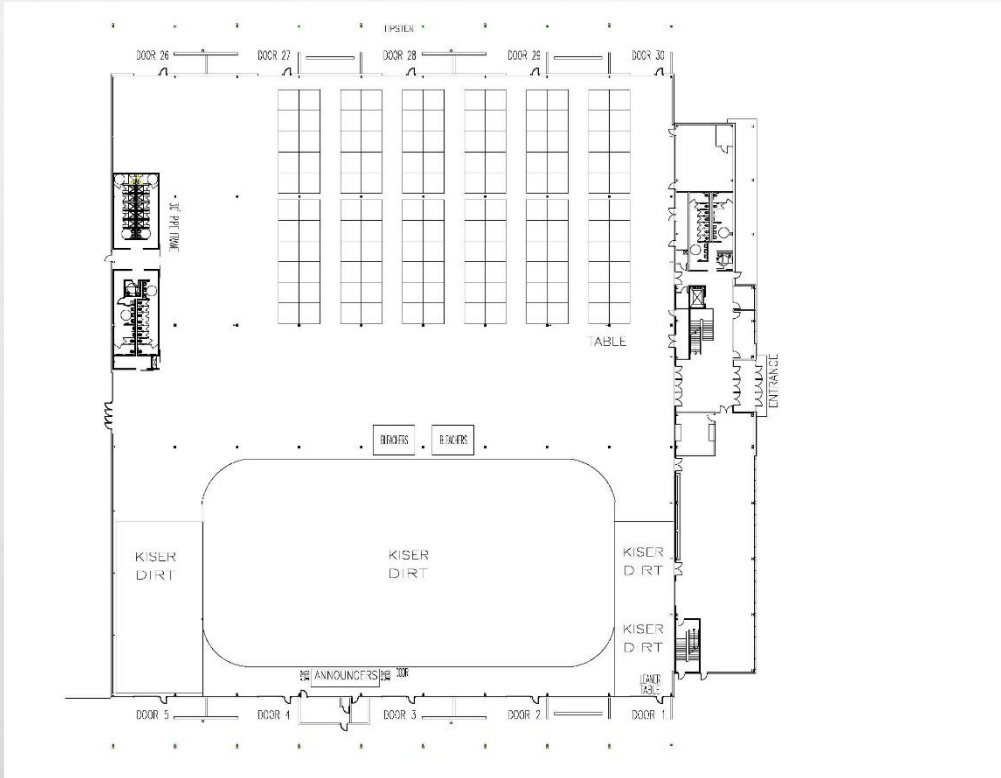

- Pavilion 1 – Horse & Pony (*may have updates*)

- Pavilion 2 – All other Species and Kiddie Farm

# YOUTH EXHIBITOR PROJECT FLOW (ANIMAL)

## Entries

- Open 4/16/25
- Close 6/1/25 at 11:59pm, Late entries deadline 6/8
- Animal Education requirements due by 6/15/25 via online form – [CLICK HERE](#)
- Packets available June 25 (Leaders only)

## Move-in

- Wednesday, July 16 from 12pm-8pm, market by 7pm (sheep & swine start at 9am)
- Only animal projects will move-in on Wednesday
- Refer to the Department listing in the Premium Book for check-in times

## Judging

- Schedule noted in the Premium Book per Department
- Animals displayed during Fair (July 17-20)

## Move-out

- Sunday, July 20 at 6:30pm (tack 5:30pm) – sale animals earlier (4pm & 4:30pm)
- No overnight stays of exhibitors or guardians are permitted on Sunday night
- Approved Swine may be left overnight to depart by 7:30am on Monday

# NON-ANIMAL PROJECTS (10-35)

- **Foods & Nutrition ONLY** will be held Monday, July 14 in Exhibit Hall A; view Department information in [Premium Book](#) for check-in and judging times.
- [Project Check-in & Judging](#) (most) will be held Tuesday, July 15 in Exhibit Hall B & C during the times listed for each Department; all but a few departments are 1:00pm-7:00pm.
- [Project Check-out](#) will be held Sunday, July 20 from 4:30pm-6:30pm only.
  - Enter WEST doors from South Parking Lot to access Exhibition Hall, **NOT North Doors**. Exit through Dock. Animal exhibitors may Exit through North Doors.
- Office hours will be available during check-in/check-out hours via phone to answer any questions.
- Refer to the [Fair Premium Book](#) on the [Youth Exhibitors](#) page on [www.danecountyfair.com](http://www.danecountyfair.com) for more department details.

# NON-ANIMAL PROJECTS (10-35)

- Shooting Sports:

- All disciplines will be held this year.
- Fair Shoot –
  - May 17 at Stoughton Conservation Club (Air & .22 Rifle) – **ENTRIES CLOSE MAY 1**
  - June 12 at Stoughton Conservation Club (Muzzle Loading) – **ENTRIES CLOSE JUNE 1**
  - June 28 at Stoughton Conservation Club (Archery, 3-D Archery, Shotgun, Air Pistol, and .22 Pistol) – **ENTRIES CLOSE JUNE 1**
  - ALL participants are encouraged (NOT required) to participate in Class I: Wildlife Ecology Knowledge Challenge on June 28 (only); see Premium Book for details.

# NON-ANIMAL PROJECTS (10-35)

- Model Horse, Communication Arts Festival, & Clothing, Knitting and Crocheting Revue will occur in-person on Thursday, July 17 during the Fair in the Exhibition Hall.
  - Model Horse – Hall C (NEW)
  - Communication Arts Festival and Clothing, Knitting and Crocheting Revue – Hall A (NEW)
    - Clothing, Knitting, Crocheting Revue items are **required** to be checked-in on Tuesday, July 15 and picked up from the Department area on Thursday for the Revue.
- Danish judging remains the same structure and times are noted under Department listings.
- Post judging, projects will be displayed in the Exhibit Halls B & C.

# NON-ANIMAL PROJECTS (10-35)

## 2025 Dane County Fair Indoor Exhibits

## Exhibition Hall

North →

### CHECK-IN, JUDGING & DISPLAY

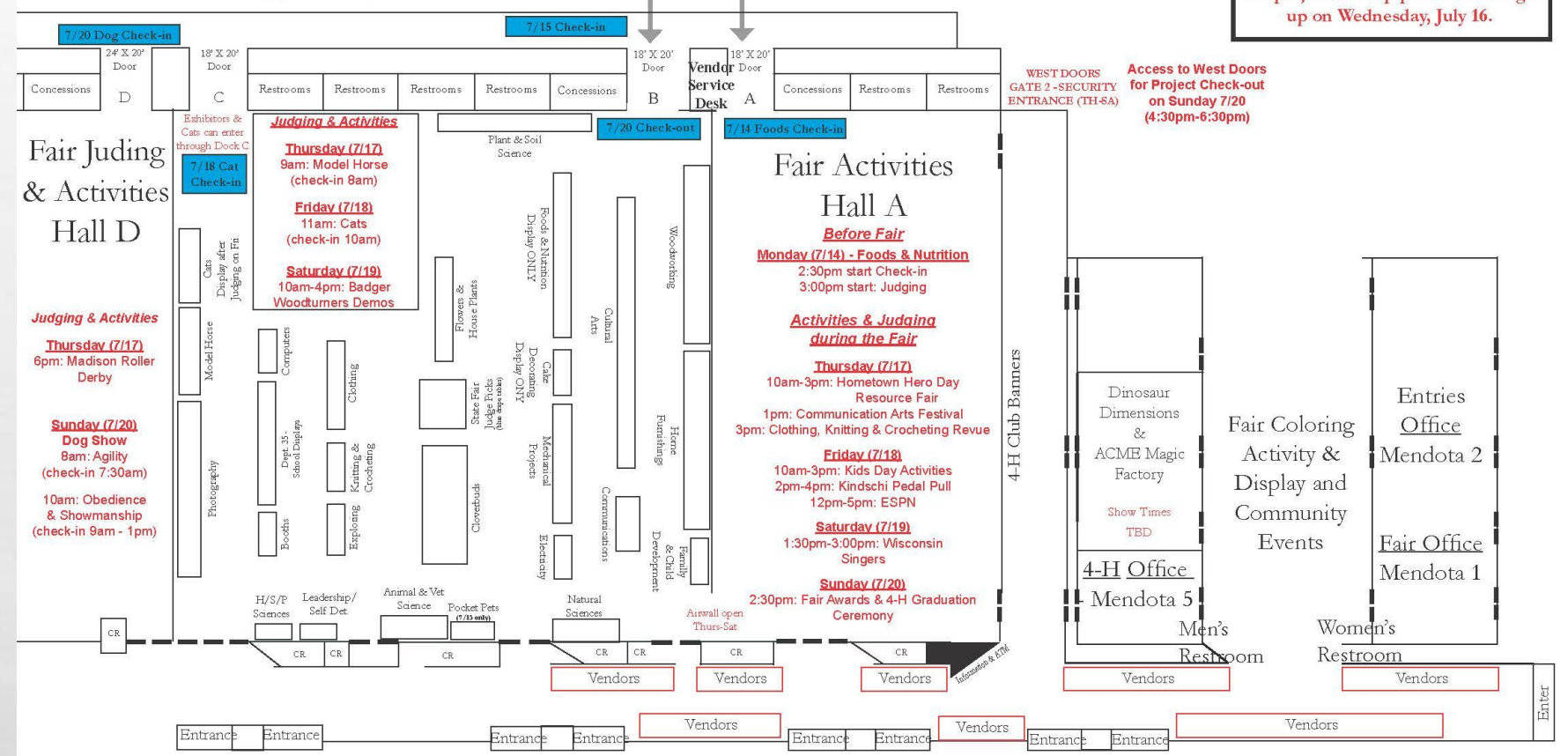

• All areas will be have a pipe barrier to prevent attendees from touching the projects. The pipe barrier will go up on Wednesday, July 16.

As of 4/11/25  
Map is not to scale and subject to change

Outdoor Trade Mall  
(Outdoor Commercial Exhibitors, Food Court and Carnival)

# YOUTH EXHIBITOR PROJECT FLOW (NON-ANIMAL)

## Entries

- Open 4/16/25
- Close 6/1/25 at 11:59pm
- Late Entries deadline 6/8/25 at 11:59pm
- Packets available June 25 (Leaders only pick up)

## Check-in

- Foods & Nutrition on Monday, July 14
- Rest of the Departments is Tuesday, July 15
- Refer to Premium Book for Department schedule

## Judging

- Foods & Nutrition on Monday, July 14
- Rest on Tuesday, July 15
- Refer to Premium Book for Department schedule
- Projects displayed during Fair in Hall B & C

## Check-out

- Occurs Sun, July 20 between 4:30pm-6:30pm only in Halls B & C
- Ex Hall closes at 4:00pm and Doors open at 4:30pm at WEST DOORS of Ex Hall
- Must have claim ticket to collect projects



# OTHER FAIR UPDATES

- Gates will remain open from 8:00am-8:00pm and physically close at 8:00pm. Attendees may only exit between 8:00pm-11:00pm; Fair closes each day at 11:00pm.
  - Gate 3 (between Pavilions) – Exhibitor ONLY Gate – Youth Exhibitors and Family with wristbands/day tickets are able to access the grounds after 8:00pm through Gate 3 ONLY. Your Fair wristband must be shown to gain access to the grounds at all times. Those without wristbands/day tickets must enter Gates 1 or 2.
    - **Recommend having all Exhibitor Family Members, FFA Kiddie Farm Attendants, and Rockstars in the Ring Participants enter through Gate 3 for ease of entry.**
- The Fair Office will be in the Exhibition Hall-Mendota 1. The Entries Department will be next door in Mendota 2.
- Online ticketing system & Gates 1 & 2 will be drive-up = online tickets scanned, or new tickets purchased (credit card or cash) at gates, attendees receive a day wristband, then park and access the grounds via the security walk-up entrance. All wristbands must be worn in order to enter the Fair.
  - Exhibitor & Exhibitor Family Season Wristbands can be shown to ticket sellers at Gates 1 & 2 if needed.

# OTHER FAIR UPDATES CONT.

- Food vendors, carnival, entertainment areas are similar to 2024. The Main Stage will now be in the Arena Building and some food vendors will be located on the Mall/Plaza Area outside the building.

Entertainment listed below:

- Globe of Death Squad Stunt Show near the Food Court (multiple shows daily)
- Dinosaur Dimensions in the Exhibition Hall – Mendota 6 & 7 (multiple shows daily & strolling)
- Kiddie Farm (daily)
- Magical Bubbles (daily)
- ACME Magic Show (multiple shows daily & strolling)
- Tractor Rides (daily)
- The Puzzle Event Company is hosting family and adult puzzle events in the Exhibition Hall on Saturday
- Badger Woodturners providing woodworking demonstrations all day on Saturday
- Other community acts during the day around the Fair
- Music = Ember (Thu), DJ (Fri), Wisconsin Singers (Sat afternoon), Life 102.5 Concert (Sat), LaMovida contests and bands (Sun)

# OTHER FAIR UPDATES CONT.

- Theme Days – Hometown Hero Day (Thu), Kids Day (Fri), Farm Fresh Day (Sat), Family Day (Sun)
  - Thu = Hometown Heroes FREE admission, Hero Resource Fair, Madison Roller Derby, Motorcycle Bike Showcase;
  - Fri = Kids Day Activities, Kiddie Tractor Pedal Pull, ESPN;
  - Sat = Tractor Parade, AgrAbility Demo, Rockstars in the Ring, Ag Olympics;
  - Sun = Master Showman, Dress-A-Critter & Awards Ceremony.
- Carnival will be open until 10:30pm each night. **Discount wristbands for youth exhibitors on Friday or Saturday from Noon-5:00pm...coupon included with your entry tags.**
- Fair Awards Ceremony & 4H Graduation – Sunday, July 20 at 2:30pm in **Hall A**.
- 4-H Kick-off Party – **NEW DATE:** Thursday, July 17 in Pavilion 1 – Mezzanine area starting at **6pm (NEW)**.
- Camping – if camping at the DCF, exhibitor camping can be in the North Lot or on Willow Island.
- Refer to the Fair website ([danecountyfair.com](http://danecountyfair.com)) for more details on music, entertainment, food vendors, schedule, etc.

# DEPARTMENT OR DISPLAY NEEDS

**Woodworking** – Dept. 22  
(Chair/Superintendents) – **NEED 2025**

Plant & Soil Science – Dept. 14  
(Superintendents)

**Exploring** – Dept. 17  
(Chair) – **NEED 2025**

Cultural Arts – Dept. 18  
(Superintendents)

Shooting Sports – Dept. 16  
(Chair)

Photography – Dept. 20  
(Superintendents)

Cats – Dept. 13  
(Superintendents)

- **Historic Display** – The Fair would like to organize a display of historic items celebrating 175 years of the Dane County Fair! If you have any historic Fair items to put on display during Fair Week, please contact the Fair Office at [info@danecountyfair.com](mailto:info@danecountyfair.com).

- We need Chairs/Superintendents for these Departments. **BOLD** is an immediate need!  
*Superintendents are mainly needed during Fair judging.*
- If you know of anyone who may be willing to assist the Fair in these departments, have them complete the [Chair/Superintendent Application](#) or contact the Fair Office at [info@danecountyfair.com](mailto:info@danecountyfair.com).

# VOLUNTEER AT THE FAIR

- **Fair Gift Shed (merchandise booth)** – Looking for 2-4 people per shift from 4-H Clubs, FFA Chapters or other Youth Organizations to volunteer and work our Fair Gift Shed during the Fair. Hours are in 2-hour shifts – Thursday (2pm-4pm), Friday (12pm-2pm & 5pm-7pm), Saturday (12pm-2pm & 5pm-7pm), and Sunday (12pm-2pm). To sign up, [CLICK HERE](#) (code **DCF2025**) to view our SignUp Genius form. Each volunteer receives an appreciation snack.
- **4-H Volunteering at the Fair** - To sign up for any of the opportunities below, [CLICK HERE](#) to view the 4-H page where all Fair volunteer opportunities through 4-H will be available.
  - **Cloverbud Evaluators** – Looking for youth evaluators (8<sup>th</sup> grade and up) to review Cloverbud projects on Tuesday, July 15 from 1pm-7pm at Alliant Energy Center in Exhibition Hall B&C. *Cloverbud link to sign up coming soon!*
  - **Non-Animal Project Protectors** – Looking for volunteers to share information about 4-H and protect the non-animal department projects inside the Exhibition Hall during the Fair. The Hall is open Thu-Sat 8am-8pm and Sun 8am-4pm. *Sign up link coming soon!*
  - **Small Animal Project Protectors** – Looking for volunteers to share information about 4-H and protect the small animal department projects inside Pavilion 2 during the Fair. *Sign up link coming soon!*

# CLUB/CHAPTER MEETINGS AT THE FAIR

- **P1 Mezzanine or 2<sup>nd</sup> Floor of Exhibition Hall** – To sign up for a meeting / lunch space during the Fair in Pavilion 1 Mezzanine Area (2<sup>nd</sup> Floor) or the Exhibition Hall Lounge (2<sup>nd</sup> Floor), contact the Fair Office at [info@danecountyfair.com](mailto:info@danecountyfair.com) on room availability.
- **Current availability (4/15/25) is listed below:**

## Thursday –

P1 Mezzanine – until 4pm

Ex Hall Lounge – until 6pm

## Friday –

P1 Mezzanine – until 8pm

Ex Hall Lounge – until 8pm

## Saturday –

P1 Mezzanine – between 1:30pm-8pm

Ex Hall Lounge – between 4pm-8pm

## Sunday –

P1 Mezzanine – **Not available**

Ex Hall Lounge – **Not available**



**SEE YOU AT THE  
DANE COUNTY FAIR  
JULY 17-20, 2025**

**ALLIANT ENERGY CENTER**

