

2022 EXHIBITOR HANDBOOK

MADERA

DISTRICT FAIR



SEPTEMBER 8-11TH 2022

FREE ONLINE ENTRIES

FOR STILLS & FLORICULTURE UNTIL AUGUST 1st



EXHIBITOR ENTRY FORM

STILL EXHIBITS & FLORICULTURE

LAST NAME:

FIRST NAME:

MIDDLE INITIAL:

ADDRESS:

CITY:

ZIP:

EMAIL:

PHONE:

AGE:

SCHOOL/ORGANIZATION:

GRADE:

	DIVISION NUMBER	CLASS NUMBER	Name, Kind, Variety, Brief Description	ENTRY FEE
1				
2				
3				
4				
5				
6				
7				
8				
Consult Exhibitor's Handbook for Division and Class Numbers, Entry Fees and Closing Dates				TOTAL FEES

The exhibitor agrees to defend, indemnify and hold harmless the Fair, the county and the State of California from and against any liability, claim, loss or expense (including attorney's fees) arising out of any injury or damage which is caused by, arises from or is in any way connected with participation in the program or event, excepting only that caused by the sole active negligence of the Fair. The Fair Management shall not be responsible for accidents or losses that may occur to any of the exhibitors or exhibits at the fair. The exhibitor (or parent or guardian of a minor) is responsible for any injury or damage resulting from the exhibitors participation in the program or event. This includes any injury to others or to the exhibitor or to the exhibitor's property. Exhibitor has read, understands and agrees to abide by all of the rules published in the Fair's Exhibitor Handbook.

EXHIBITOR SIGNATURE: _____

PARENT/GUARDIAN SIGNATURE: _____

I certify that this is the project of the exhibitor and is eligible to be shown in accordance with the rules of this show.

ADVISOR/LEADER/TEACHER SIGNATURE & PHONE NUMBER: _____

CLUB/CHAPTER: _____

Exhibitor Last Name: _____

First Name: _____

FOR FAIR USE ONLY
DATE RECEIVED:

RECEIVED BY:

EXHIBITOR #:

GENERAL INFORMATION

FAIR STAFF

Tom Mitchell	CEO
Richard Sandoval	Deputy Manager
Monica Cardoso	Vendor Coordinator
Barbara Leach	Marketing & PR
Lynnette Jacobsen	Exhibits
Vince Hernandez	Senior Maintenance
Robert Burke	Maintenance
Angelo Prado	Grounds
Terri Collins	Livestock Superintendent
Don Myers	Barn Superintendent
Sandy Vaiarello	Stills and Floriculture Superintendent

FAIR TIME OFFICE HOURS

September 8-11, 2022
Thursday-Sunday
8:00 AM - 6:00 PM

ENTRY CLOSING DAY HOURS

MONDAY and TUESDAY August 22nd and 23rd, 2022
4:00 PM - 8:00 PM
EXHIBIT HALL (HOME ARTS BUILDING)

ADDRESS

Madera District Fair
1850 W. Cleveland Ave.
Madera, CA. 93637
www.maderafair.com

FAIR ADMISSIONS

General Admission at the Gate	\$15
Senior Citizens (62 and up)	\$10
Children 6 years to 12 years	\$5
Children 5 years and under	FREE
Pre-Sale General Admission	\$10

PHONE NUMBERS

MAIN LINE	(559) 674-8511
FAX	(559) 674-4516
Livestock Office	(559) 674-1224

FAIRGROUND HOURS

THURSDAY	5:00 PM - 11:00 PM
FRIDAY	5:00 PM - 11:00 PM
SATURDAY	3:00 PM - 11:00 PM
SUNDAY	3:00 PM - 11:00 PM

REGULAR OFFICE HOURS

Monday-Friday
8:00 AM - 4:30 PM
Closed Holidays

CARNIVAL HOURS

THURSDAY	5:00 PM - 12:00 AM
FRIDAY	5:00 PM - 12:00 AM
SATURDAY	3:00 PM - 12:00 AM
SUNDAY	3:00 PM - 12:00 AM

DATES TO KNOW

ENTRY FORM RECEIVING DATES

DATE	TIME	ENTRY FORM
August 5th		ALL LIVESTOCK MARKET ENTRY FORMS DUE see pg. 42 for more details
Monday or Tuesday, Aug. 22nd or 23rd ENTRY FORM CLOSING	4:00-8:00 PM	FLORICULTURE- Gardens, Potted Plants, Dry Arrangements and Fresh Cut Flowers EXHIBIT HALL- Junior and Adult, AG Mechanics, Special Contests and Classroom LIVESTOCK- Non Market Livestock Entries
Monday, Aug. 29th		Last day for Poultry, Rabbit, Dairy Goat and Pygmy Goat substitutions

STILL and FLORICULTURE ONLINE ENTRIES ARE FREE UNTIL AUGUST 1ST!
ENTRY CLOSING: Monday & Tuesday, August 22nd and 23rd from 4:00 PM to 8:00 PM
RECEIVING: August 22nd or 23rd with your entry forms
OR FINAL RECEIVING DAYS August 29th or 30th, from 4:00 to 8:00 PM

EXHIBIT RECEIVING and CLAIMING DATES

DATE	TIME	EXHIBIT
Monday or Tuesday Aug. 29th or 30th FINAL RECEIVING	4:00-8:00 PM	Exhibit Hall- All Adult and Youth Still Exhibits including preserves. *Save yourself a trip! Bring exhibits on entry closing dates 8/22 or 8/23
Saturday, Aug. 27th	8:30 AM	Livestock- Horse Show
Sunday, Aug. 28th	8:30 AM	Livestock- Gymkhana Horse Show
Saturday, Sept. 3rd-10th	VARIED	Livestock- All Shows
Saturday, Sept. 10th	11:00 AM	Livestock- Buyers Luncheon
Saturday, Sept. 10th	12:00 NOON	Livestock- Auction
Monday, Sept. 5th	6:00AM-6:00PM	Livestock- receiving BEGINS at 6:00 AM or NO later than 6:00 PM
Monday or Tuesday Aug. 29th or 30th FINAL RECEIVING	4:00-8:00 PM	AG Mechanics- receiving information on page 33
Tuesday, Sept. 6th	4:00 PM-8:00 PM	Floriculture- All Gardens, Produce, Nature's Wonders, Potted plants, etc...
Tuesday Sept. 6th	4:00 PM-8:00 PM	Floriculture- Fresh Cut Flowers & Arrangements @Hatfield Hall
Tuesday Sept. 6th	4:00 PM-8:00 PM	Exhibit Hall- Baking & Confections for Adult, Youth and Challenged Division
Thursday Sept 8th	6:30 PM-7:15 PM	The Great American Chocolate Chip Cookie Contest! Judging at 7:30 PM
Friday, Sept. 9th	5:00-5:45 PM	LOCAL Grown Pies! Judging at 6:00 PM
Saturday, Sept. 10th	4:00-4:45 PM	BBQ Ribs! Judging at 5:00 PM
Saturday, Sept. 10th	6:00-6:45 PM	Cupcake Wars Judging at 7:00 PM
Sunday, Sept. 11th	4:00-4:45 PM	Salsa Contest! Judging at 5:00 PM
DATE	TIME	CLAIMING
Tuesday, Sept. 13th	4:00-8:00 PM	FLORICULTURE and EXHIBIT HALL

**FULL LIVESTOCK
dates and times
on pg. 42**

EXHIBITOR INFORMATION

Look for your department or talent in the bold headings across the top. Many DIVISIONS offer Skill Level. Many CLASSES offer "any other", when, what or how you create is not an exact class. Our goal with the exhibitor handbook is to increase competition and interest while making it easy for EVERYONE to enter, even FIRST TIMERS! Competing at Madera Fair is fun for all.

GET A HANDBOOK or VIEW IT ONLINE. Check!

1. Look through the book and find the areas that you are interested in entering. It is easy to look at it this way: WHAT you do and HOW you do it! OR HOW you do it and WHAT it is!
2. This book is published yearly and lists all of the departments, divisions and classes that are available for entry.
3. You'll notice a specific YOUTH CONTEST section in orange. If we do not have a comparable contest in youth, youth are welcome to enter the adult contest section.

SECOND, Fill out your entry form:

1. **ONLINE:** Go to www.maderafair.com and click the link to enter. ONLINE ENTRY will require you create a username and password OR sign-in with your existing one. Follow instructions to enter. Review your cart and confirm that all items have been entered. Select "check-out" to continue to payment screen. ALL STILL and FLORICULTURE ENTRIES ARE FREE until August 1st, 2022.
2. **PAPER ENTRY** forms are available in the handbook, at maderafair.com or from the Fair Office. Special entry forms are required for livestock.
 - a. Sign your form. Youth must include their age, grade and have a parent or leader sign.
 - b. Please include phone number, complete address and email.
 - c. Make sure both the division number and class number are clearly listed on the form.
3. Enter the classes you feel are best suited for your exhibit. The Fair will attempt to enter exhibits in the proper classes when entries are made in error on the form. However, the Fair will not be liable for entries made in error.
4. Refer to rules listed in the department you are entering for further information. If you need help, call the Fair Office at (559)674-8511 or come in and see us Monday through Friday 8:00 AM to 4:30 PM.
5. Complete online OR bring your entry form and fees, if applicable, to the Fair Office by 8 PM on Tuesday, August 23rd, 2022. LATE ENTRIES WILL NOT BE ACCEPTED!

THIRD, Bring your exhibits to the Fairgrounds.

Be sure you have noted the receiving days as listed in the Exhibitor Handbook. Bring your exhibits between the hours listed, to the building indicated.

NOTE: All exhibits must be picked up on the date listed, in most cases the Tuesday following the closure of the Fair. The Fair is not responsible for items not claimed on or after the claiming date. Any remaining exhibits not claimed by October 31st may be donated or discarded.

GLOSSARY OR TERMINOLOGY:

ADULT EXHIBITOR - Persons that are age 19 yrs. & older.

ADVANCED/PROFESSIONAL - Exhibitor who has achieved a marked degree of expertise in the division or who has sold or made money from their work.

AMERICAN SYSTEM OF JUDGING - The judging process to rank exhibits against one another and award one first place, one second place, one third place, etc.

BEGINNER - Exhibitor who has two years or less experience in the division.

CLAIMING - The dates and times that an exhibit is to be claimed (picked up) by the owner. Prize checks and ribbons are issued at the same time, except for livestock and special contests.

CLOSING DATE - The last date on which entry forms can be accepted. The forms can be delivered to the Fair office or postmarked by midnight on closing date.

DANISH SYSTEM OF JUDGING - The judging process to compare each exhibit on its own merit against a scorecard or recognized standard and award as many first place, second place, etc., as merited.

ENTRY FEE - The amount to be paid for each item entered, if required (always listed under the prizes offered).

EXHIBIT - The animal or item, which will be judged.

INTERMEDIATE - Exhibitor who has two years or more experience in the division.

JUDGING - Date and time of the judging. When judging is listed as open or live, it means that special arrangements have been made for a public audience.

POP-UP CONTEST - Exhibit contests that will be announced during FAIR TIME and on the grounds! Visit Facebook and daily schedules for contests, times and locations, September 8th-11th, 2022.

PRIZES OFFERED - The amount awarded for a judged category. Also called PREMIUMS.

RECEIVING - The date and time when the exhibits will be accepted by the departments in which they have been entered. Items are received in the building or area where they will be shown.

UNIQUELY CHALLENGED EXHIBITOR - For persons with learning, developmental or physical disabilities and enrolled in a group facility or Adult Day Program.

YOUTH EXHIBITOR - Persons age 18 years and younger.

RULES, RULES & A FEW MORE RULES.

Specific guidelines per contest will be listed with that contest. Hopefully the **GENERAL RULES** answer ALL of your questions. If not, visit maderafair.com and find the FAQ tab, under Exhibitor Handbook for Frequently Asked Questions. Of course the office is always happy to help, give us a call or stop by!



LOCAL RULES

21-A DISTRICT AGRICULTURAL ASSOCIATION MADERA DISTRICT FAIR

1. To enter an item in the Fair, all entries must be submitted online at maderafair.com OR on paper entry forms furnished by the Madera District Fair. Send or submit all entry forms to:

Madera District Fair
1850 W. Cleveland Ave.
Madera, CA 93637

2. Unless otherwise specified, all classes will be open to legal residents of Madera County only.

3. The Fair is not responsible for items not claimed by published claiming date. Floriculture Entries and Exhibit Hall entries must be claimed on Tuesday, Sept. 13th unless otherwise specified. See Junior Livestock department rules and regulations regarding the release of livestock and tack.

4. It is the intent of the Fair Management to award all Special Awards and or donated prizes to exhibitors as published in the Exhibitor's Handbook. Exhibitors must notify the Fair within 30 days of the end date of fair, for missing awards. Fair Management will not be held responsible for prizes not received from sponsors.

5. Fair management reserves the right to refuse, accept conditionally or cancel any entries, disqualify exhibitors, prohibit exhibition of entries, or cancel awards without claim for damages.

6. The Fair reserves the right to reject any entry if it is deemed objectionable or if it requires excessive space.

7. By signing and submitting an entry form the exhibitor and their agents, parents and leaders acknowledges: *"The exhibitor agrees to defend, indemnify, and hold harmless the fair, the county, and the State of California from and against any liability, claim, loss, or expense (including attorneys' fees) arising out of any injury or damage which is caused by,*

arises from or is in any way connected with participation in the program or event, excepting only that caused by the sole active negligence of the Fair. The Fair Management shall not be responsible for accidents or losses that may occur to any of the exhibitors or exhibits at the fair. The exhibitor (or parent or guardian of a minor) is responsible for any injury or damage resulting from the exhibitor's participation in the program or event. This includes any injury to others or to the exhibitor or to the exhibitor's property." and agrees to read and understand the State Rules and Local Fair Rules; Certify that all information on entry forms is true and accurate; agree to abide by all rules set forth by the Fair; and agree to comply with the Fair's decision regarding any alleged violation of the State or Local Rules.

8. The Fair reserves the right to display exhibits as space permits. There is no guarantee that all items will be displayed.

9. All entries must be received or postmarked by Tuesday, Aug. 23rd and post entries will not be accepted unless otherwise specified.

10. Please note: The Fair makes every effort to ensure that the information provided in the exhibitor handbook is accurate and free of typographical errors regarding the awarding of premiums and prizes. The Fair will not be held responsible for awarding duplicate premiums. The Fair will not be held responsible for items that have been disqualified at the Judge's discretion.

11. The Judge's decision is final. The Judge's book will be used as evidence for payment of premiums or special awards. Ribbons and Tags will not be accepted.

12. ALL STATE RULES APPLY, visit maderafair.com to view or SCAN BELOW:



EXHIBIT HALL RULES

1. All local rules apply.

2. This department is open to Madera County residents only.

3. Exhibitors are responsible for knowing and abiding by local rules found in front of this book and all State Rules for California Fairs. A copy of the State Rules may be obtained at the fairgrounds main office or at: www.cdca.gov/fe/

4. Unless stated otherwise, exhibitors are limited to (2) two entries in any one class.

5. Unless stated otherwise, all entries must have been made or completed by the exhibitor within the last 12 months. Entries shall not have been shown previously at the Madera District Fair.

6. Names must be removed from articles, unless stated otherwise.

7. All entries are entered at the exhibitor's own risk. All possible caution will be taken, but the Fair will not be responsible for loss, damage or theft of any item.

RULES, RULES & A FEW MORE RULES.

8. Any entries that are dirty, dusty or soiled will be disqualified and not displayed.
9. Unless stated otherwise, this department conducts closed judging procedures. No visitors or exhibitors are allowed in the building during judging. No judging results will be given over the telephone.
10. Unless stated otherwise, entry in this department does not entitle exhibitor to free Fair admission.
11. All entries must be clearly marked with the exhibitor's name, address, division, class and title on back.
12. Youth Exhibitors 18 years of age and under may enter any special contest (as an adult) if there is not a comparable one in the YOUTH division.
13. Fair management reserves the right to refuse, accept conditionally or cancel any entries, disqualify exhibitors, prohibit exhibition of entries or cancel awards, without claim for damages.
14. Please note: The Fair makes every effort to ensure that the information provided in the exhibitor handbook is accurate and free of typographical errors. The Fair will not be held responsible for awarding duplicate premiums or special awards. The Fair will not be held responsible for items that have been disqualified at the judge's discretion.
15. The judge's decision is final. The judge's book will be used as evidence for payment of premiums or special awards. Ribbons and Tags will not be accepted. No judging results will be given over the telephone.

PHOTOGRAPHY RULES

1. You can enter (2) entries per class, per person.
2. Any photo may be entered as long as it has never won an award at Madera District Fair.
3. Black & White prints may be entered in any class. However, for judging on Black & White technique, it must be entered in the Black & White class # within your Division.
4. All photos must be taken by exhibitor. However, they may be developed, printed and/or mounted by a professional.
5. Please provide an 8"x10" or 8"x12" print and mount on a **SINGLE** mat. Double or triple mat may be disqualified.
6. All prints must include an adhesive hanger centered on the back and flush with the top edge. Hangers are available at the Fair Office or on receiving day free of charge.
7. All prints must be clearly marked on the back of the mat with the following information:
 - EXHIBITOR'S NAME
 - Address
 - Phone
 - Division & Class

***ADVISEMENT: Our experience shows simply using double sided tape does not work. Often with the humidity in the building it becomes detached. We suggest glue dots or a stronger adhesive.

8. Images are not to be modified in any way that does not display a true representation of the subject matter of which the photo was taken. Minor corrections to enhance the color, contrast and brightness of a photo are allowed, as long as it is done in reasonable increments (as decided by judges) which do not alter the original natural form of the photograph.

Permitted Modifications: (1) image cropping and rotating as necessary (2) Color filters-only if they are used to color correct artificial lights. (3) Red-Eye removal and spot "dust marks" removal. (4) Use of artificial lighting such as flash, studio lights or reflectors used at the time the image was made. (5) Use of corrective functions to improve the natural appearance of the image, such as dodging, burning, levels, contrast, brightness, intensity, tone, saturation, lightness, value, color balance and hue as long as they are done in reasonable increments and have not significantly modified or manipulated the photograph to appear unnatural, or deviate from the original subject matter of which they were taken.

Modifications NOT Permitted: (1) Watermarks, writing, hand markings, hand tinting, or physical modifications. (2) Spray matte, or any physical substance that may be added to alter the texture or appearance of print. (3) Adding or replacing elements or composite images. (4) Cloning or removal, replacing or addition of any elements in a photo. (5) Digital retouching or airbrushing. (6) Artistic filters such as fog, mist, warming, sunbursts or any other special effects filter. (7) Specialized treatments or cross processing of film.



RIBBON, RIBBON WHO HAS A RIBBON?

2022 FEATURED CONTESTS

"You got to get it while you can." -Janis Joplin

Featured Contests are often ONE TIME only contests and have great cash premiums, JUMP IN! American System of Judging for all special contests. **Please read general rules on pg. 8 and any special rules within each contest.**

* Exhibitors 18 years of age and under may enter any special contest (as an adult) if there is not a comparable one in the Youth Division.

THIS IS HOW YOU DO IT!

1. Decide what division(s) and class(es) you are entering.
2. Visit maderafair.com to create a username for entering online and follow the steps to enter. ONLINE STILL and FLORICULTURE entries are FREE until August 1st, 2022.
3. IF you prefer paper entry, a form is in the book, available at maderafair.com OR in the Madera Fair office.
4. Submit online entry OR paper entry form to Madera Fair on or before August 23rd, 2022, pay applicable entry fees.
5. Bring Exhibit on FINAL receiving days, Aug. 29th or 30th, 2022. Unless specific contest states otherwise. For special food contests, see pg.6 for receiving date and time.

ART & CRAFT

DIVISION 1

"TABLE FOR ONE"

Set the mood with a spot at the table in the popular TABLE SETTING contest. Madera Fair will provide (1) 30" round bistro table for up to 6 entries. Your table setting will be decorated for one. Etiquette authorities may be resourced as guidelines, but creativity counts and the judges decision will be final. No real food, plants, flowers, balloons or chair are permitted. Any container used must be clean and empty. What will your special table be set for? Is it for breakfast, lunch, dinner, tea or coffee time? Table settings must be completed on ONE of two receiving days, August 29th or 30th, 2022 between 4:00-8:00 PM in the Exhibit Hall. One entry per person.

PRIZES OFFERED PER CLASS

1st Place	\$30.00
2nd Place	\$20.00
3rd Place	\$10.00

\$1.00 Entry Fee

CLASS

1	"Be My Guest"
---	---------------

DIVISION 2

"COME ON IN!"

Decorate the front door as a welcome scene to your guests! Express your hospitality on a standard 3'x 6'5" door with a porch area floor space of 7' wide x 2' deep. 4 doors available. No electrical provided. Doorscape must be completed on ONE of two receiving days, August 29th or August 30th, 2022 between 4:00-8:00PM. One entry per person.

PRIZES OFFERED PER CLASS

1st Place	\$30.00
2nd Place	\$20.00
3rd Place	\$10.00

\$1.00 Entry Fee

CLASS

1	"Welcome Home"
---	----------------



2022 FEATURED CONTESTS

DIVISION 3

"WRAPPED IN LOVE"

We are proud to partner with DOORS OF HOPE, a parenting and pregnancy resource center in Madera. Your handmade blanket in "Wrapped in Love" is not only a featured exhibit and competition, but your exhibit will be donated to DOORS OF HOPE at the end of the Fair. Let your love wrap up a baby and family in 2022! Enter a tie blanket, quilt, knitted or crocheted exhibit for display and donation. Min. size 25"x30" Max. size 35"x40". All entries become property of Madera Fair for distribution to DOORS OF HOPE.

PRIZES OFFERED PER CLASS

1st Place	\$15.00
2nd Place	\$10.00
3rd Place	\$5.00

NO Entry Fee

CLASS

"Wrapped in Love"



PHOTOGRAPHY

open to any age and experience

PRIZES OFFERED PER CLASS

Divisions 4 and 5

1st Place	\$10.00
2nd Place	\$7.00
3rd Place	\$5.00

Entry Fees: \$1.00 per entry

DIVISION 4

"CALLING ALL CATS"

In the era of selfies and Instagram posts, let's submit a photo of you and your cat! Whether it's a selfie for a social post or even the professional photo shoot, everyone loves to see a shot of the best friendships on earth. "One cat leads to another" -Ernest Hemmingway

CLASS

1

"Here Kitty, Kitty"



DIVISION 5

"MADERA EATS"

LOOK at that! Looks good enough to eat! You know we can't resist to snap that photo, when scrumptious food appears. When the opportunity hits, take a pic! Submit an image that shares enthusiasm for the food from a local restaurant or food truck. See photography rules pg. 9. Please include the NAME of Madera community Restaurant or Food Truck on entry for all to see.

CLASS

1

"Dine In-Madera Restaurants Plate it Up"

2

"Dine Out/Take Home- Madera Food Trucks"

2022 FEATURED CONTESTS

FOOD

PRIZES OFFERED PER CLASS

Divisions 6, 7, 8, 9 & 10

1st Place	\$20.00
2nd Place	\$15.00
3rd Place	\$10.00

Entry Fees: \$2.00 per entry

SPECIAL FOOD GUIDELINES

1. All food entries must be on disposable plates, pans or containers. NO EXCEPTIONS. Please do not provide audience samples.
2. Your food entry becomes the property of the Madera District Fair. A portion of all entries may be on display for the remainder of the Fair. Foods that are no longer presentable due to spoilage will be disposed of.
3. One entry per class per exhibitor. One free Gate 3 Admission will be provided for our Special Food Contest Exhibitor. Letter of Confirmation and Instructions will be given.
4. Recipes must be submitted on a white 5"x 8" recipe card. If they are not, be prepared to copy your recipe onto the correct card at receiving. DO NOT put your name on the card. Your exhibit number will be placed on your recipe at receiving. Special Contest recipes may be published.



SPECIAL FOOD CONTESTS

DIVISION 6

"CHOCOLATE CHIP COOKIE"

THURSDAY, September 8th

Receiving, 6:30-7:15 PM

Judging, 7:30 PM

Contest Sponsored by: THE TIM RICHE FAMILY

1st Place \$75.00

2nd Place \$50.00

3rd Place \$25.00

The Great American Chocolate Chip Cookie Contest has been a dream come true to fairgoers. You may have the greatest chocolate chip cookie ever to be entered and now we will know whose is the best! This is a new contest with an old favorite. Please review special food contest note rule # 4. Enter 10 cookies on a disposable plate.

CLASS

- 1 "The Great American Chocolate Chip Cookies"

DIVISION 7

"LOCAL GROWN PIES"

FRIDAY, September 9th

Receiving, 5:00-5:45 PM

Judging, 6:00 PM

Contest Sponsored by: CREATIVE COPY

1st Place \$75.00

2nd Place \$50.00

3rd Place \$25.00

Our valley is often referred to as the "food basket for the world" due to the incredible number of commodities that are farmed here. This contest will feature the locally grown products that you can get at any local market or farm stand and then made into a pie! Apple, peach, berry or even walnuts, pecans or almonds. Make it unique and make it delicious! Bring out your oldest family recipe or make something entirely new.

Review special contest rules, note rule #4. Enter one pie in a disposable pie plate. Entry becomes property of the Fair. Please provide the name of the farm where you purchased your product.

CLASS

- 1 "Local Grown Pies"

2022 FEATURED CONTESTS

DIVISION 8

"BBQ'D BABY BACK RIBS"

SATURDAY, September 10th

Receiving, 4:00-4:45 PM

Judging, 5:00 PM

Contest Sponsored by: BRIAN'S HEATING & COOLING

1st Place \$75.00

2nd Place \$50.00

3rd Place \$25.00

Who can resist a savory slab of Baby Back Ribs? Who's got the gusto to de-throne Madera District Fair's BBQ Baby Back Rib CHAMP? Bring a plate of 6 of your best to offer up to our judges. Maybe you can take home the prize and 2022 bragging rights! Sauce or rub em', we're looking for the BOSS of the BBQ! Review special food contest rules, note rule #4. Enter (6) Baby Back Ribs.

CLASS

1 "BBQ'D Ribs"

DIVISION 9

"CUPCAKE WARS"

SATURDAY, September 10th

Receiving, 6:00-6:45 PM

Judging, 7:00 PM

*Contest Sponsored by: THE McCANN FAMILY
IN MEMORY OF T. JEAN BURMER*

1st Place \$75.00

2nd Place \$50.00

3rd Place \$25.00

In memory of T. Jean Burner's love for culinary competition, daughter, Chris McCann and family are proud to sponsor the cupcake showdown! Present (6) cupcakes, of any one flavor. Who will hold the title of CUPCAKE CHAMP for Madera Fair's popular CUPCAKE WAR? Review special food contest rules, note rule #4. Live judging: Appearance, Originality and Flavor. Enter (6) Cupcakes.

CLASS

1 "Cupcakes"

DIVISION 10

"SALSA"

SUNDAY, September 11th

Receiving, 4:00-4:45 PM

Judging, 5:00 PM

Contest Sponsored by: WARNOCK FOOD PRODUCTS

1st Place \$75.00

2nd Place \$50.00

3rd Place \$25.00

Salsa turns any food into a party in your mouth! So dig out the old family recipe or concoct your own masterpiece and bring in some down-home palate pleasin' fun SALSA! Hot, medium or mild, whatever tickles your fancy. This salsa ain't from New York City! Review special food contest rules, note rule #4.

CLASS

1 "Salsa"

DIVISION 11

"CATTLE COLORING CONTEST"

Contest Sponsored by: MADERA COUNTY COWBELLES

1st Place \$15.00

2nd Place \$10.00

3rd Place \$ 5.00

Prizes awarded per class. No entry fee.

Get your colors ready and fill in a page in history at the 2022 Madera Fair! Students from Pre-K to 4th Grades can participate. The coloring page can be found at maderafair.com and downloaded, colored and entered OR scanned below!

1. Include exhibitor's full name as listed on entry form on the back of the artwork.
2. Please include grade on the back of the entry form as well.

CLASS

1 Pre-K and Kinder
2 1st and 2nd Grade
3 3rd and 4th Grade



**SCAN FOR
COLOR SHEET!**

2022 FEATURED CONTESTS

"Special Contests"

PRIZES OFFERED in Division 12 and 13

1st Place	\$10.00
2nd Place	\$7.00
3rd Place	\$5.00

Entry Fees: \$1.00 per entry

DIVISION 12

"Unmasked and Repurposed"

Have any unused masks lying around, want to use them again, but in a different fashion? Take a mask or a few and create any style or creation. If you don't have one, you can stop by our office and pick up a mask or two!

CLASS

1	Adult: age 19 and older
2	Junior: age 18 and under



DIVISION 13

"Amelia Earhart's Solo Flight"

Yes, 90 years ago Amelia Earhart started her journey on a solo flight across the Atlantic and completed the journey as the first woman to do so. In honor of her flight, this contest will have you creating your own airplane out of paper. Fold, cut and decorate your best Paper Plane.

CLASS

1	entries for KIDS 12 and under
2	entries for 13 and over



FAIR CAMP

FAIR CAMP is back on the grounds in partnership with City of Madera Parks & Community Services this summer JUNE 20th-24th, with activities emphasizing the best parts of the annual Fair: Livestock, Exhibits, Food, Entertainment and Fun! Visit City of Madera Parks & Community Services or maderafair.com to register and for more details! FAIR CAMP divisions are ONLY for FAIR CAMP participants.



DANISH SYSTEM OF JUDGING

Ribbon awards only

NO ENTRY FEE

DIVISION 14

FAIR CAMP

At our FAIR CAMP EVENTS, you will be introduced to entering a fair entry and becoming an exhibitor. Entries are completed during camp meetings.

CLASS

1	Preserves
2	Crafts
3	STCS

EXHIBIT HALL DATES & TIMES

PHOTOGRAPHY, HOME ARTS AND ARTS & CRAFTS Sandy Vaiarello, Superintendent

SPECIAL FOOD CONTESTS	ENTRY CLOSING	RECEIVING	JUDGING
NEW! Great American Chocolate Chip Cookie	 <p>Monday & Tuesday August 22nd and 23rd between 4:00-8:00 PM</p>	Thurs. - Sept. 8th 6:30-7:15 PM	Sept. 8th 7:30 PM
LOCAL Grown-Pies		Fri. - Sept. 9th 5:00-5:45 PM	Fri. - Sept. 9th 6:00 PM
BBQ Rib Contest		Sat. - Sept. 10th 4:00-4:45 PM	Sat. - Sept. 10th 5:00 PM
CUPCAKE WARS		Sat. - Sept. 10th 6:00-6:45 PM	Sat. - Sept. 10th 7:00 PM
SALSA		Sun. - Sept. 11th 4:00-4:45 PM	Sun. - Sept. 11th 5:00 PM

FOOD, ARTS & CRAFT CONTESTS HELD DURING FAIR HOURS

ENTRY FORM CLOSING, EXHIBIT RECEIVING & CLAIMING DATES FOR:
PHOTOGRAPHY, CLOTHING AND TEXTILES, QUILTING, CREATIVE DECORATING, HOME CRAFTS, FINE ARTS,
PAINTING AND DRAWING, WOODWORKING, YOUTH & ADULT PRESERVED FOODS
and NON-FOOD FEATURED CONTESTS.

****This includes Youth, Adult, Challenged or Assisted and Classroom Projects****

ENTRY CLOSING: Monday and Tuesday, August 22nd and 23rd, by 8:00 PM

RECEIVING: Monday and Tuesday, August 22nd and 23rd with your entry forms
or FINAL RECEIVING DAYS - August 29th and 30th from 4:00 to 8:00 PM

CLAIMING: Tuesday, September 13th, from 4:00 PM to 8:00 PM

ENTRY FORM CLOSING, EXHIBIT RECEIVING & CLAIMING DATES FOR:
AGRICULTURAL MECHANICS

ENTRY CLOSING: Monday and Tuesday, August 22nd and 23rd, by 8:00 PM

RECEIVING: August 29th and 30th from 4:00 to 8:00PM, see page 33 for receiving directions

CLAIMING: Tuesday, September 13th, from 4:00 PM to 8:00 PM

ENTRY FORM CLOSING, EXHIBIT RECEIVING & CLAIMING DATES FOR:
YOUTH, ADULT, CHALLENGED OR ASSISTED BAKING AND CONFECTIONS

ENTRY CLOSING: Monday and Tuesday, August 22nd and 23rd, by 8:00 PM

RECEIVING: Tuesday, September 6th, from 4:00 PM to 8:00 PM

CLAIMING: Tuesday, September 13th, from 4:00 PM to 8:00 PM

CLOTHING and TEXTILE

Sew on and sew forth.

One Best of Division Ribbon will be awarded in each Division with one Best of Show selected from the Division winners. American System of Judging. Please read general rules on page 8 and the guidelines below.

GUIDELINES

1. All entries must have been made or completed by the Exhibitor within the last 24 months.

YOU COULD WIN MONEY!

PRIZES OFFERED PER CLASS

applies to Div. 50-53

1st Place	\$5.00
2nd Place	\$3.00
3rd Place	\$2.00

Entry Fees: \$1.00 per entry per class

THIS IS HOW YOU DO IT!

1. Decide what division(s) and class(es) you are entering.
2. Visit maderafair.com to create a username for entering online and follow the steps to enter. ONLINE STILL and FLORICULTURE entries are FREE until August 1st, 2022.
3. IF you prefer paper entry, a form is in the book, available at maderafair.com OR in the Madera Fair office.
4. Submit online entry OR paper entry form to Madera Fair on or before August 23rd, 2022, pay applicable entry fees.
5. Bring Exhibit on FINAL receiving days, Aug. 29th or 30th, 2022. Unless specific contest states otherwise.



DIVISION 50 CROCHET

CLASS

1	Afghans, Blankets
2	Clothing
3	Accessories
4	Any other not listed, specify

DIVISION 51 KNITTING

CLASS

1	Afghans, Blankets
2	Clothing
3	Accessories
4	Any other not listed, specify

DIVISION 52 NEEDLEWORK

CLASS

1	Any other, specify
---	--------------------

DIVISION 53 GENERAL SEWING & TEXTILE WORK

CLASS

1	Any other, specify
---	--------------------

Free Online Entries
STILL and FLORICULTURE
until August 1st, 2022!

FINE ARTS

"Art is not what you see but what you make others see." -Degas

One Best of Division Ribbon will be awarded in each Division #54-68, with one Best of Show being awarded to each skill level. American System of Judging. Please read general rules on page 8 and the guidelines below.

FINE ART GUIDELINES

1. All fine art entries must be ready to hang with wire and eye hangers securely attached, even on canvas. No sawtooth hangers. Frames and canvas pieces, regardless of size, without wire and eye hangers will not be accepted. No exceptions.
2. All entries must be originals and not stamped patterns or copies. Work must have been done by the exhibitor.
3. No pictures over 48" in any direction, this includes frame and matting. Images under glass are acceptable.

YOU COULD WIN MONEY!

DIV. 54-63 PRIZES OFFERED PER CLASS

1st Place	\$5.00
2nd Place	\$3.00
3rd Place	\$2.00

Entry Fees: \$1.00 per entry per class

DIV. 64-68 PRIZES OFFERED PER CLASS

1st Place	\$10.00
2nd Place	\$7.00
3rd Place	\$4.00

Entry Fees: \$1.00 per entry per class

THIS IS HOW YOU DO IT!

1. Decide what division(s) and class(es) you are entering.
2. Visit maderafair.com to create a username for entering online and follow the steps to enter. **ONLINE STILL and FLORICULTURE** entries are FREE until August 1st, 2022.
3. IF you prefer paper entry, a form is in the book, available at maderafair.com OR in the Madera Fair office.
4. Submit online entry OR paper entry form to Madera Fair on or before August 23rd, 2022, pay applicable entry fees.
5. Bring Exhibit on FINAL receiving days, Aug. 29th or 30th, 2022. Unless specific contest states otherwise.

Determine your SKILL LEVEL:

Beginner = Exhibitor with two years or less experience in the division.

Intermediate = Exhibitor who has two or more years experience in the division.

Advanced/Pro = Exhibitor who has achieved a marked degree of expertise in the division and/or has sold or made money from their work.

CHOOSE DIVISION FINE ART

Division 54	BEGINNER Oil or Acrylic
Division 55	BEGINNER Charcoal, Pastels, Conte Crayon
Division 56	BEGINNER Water Color
Division 57	BEGINNER Pen & Ink or Pencil
Division 58	BEGINNER Any other, specify
Division 59	INTERMEDIATE Oil or Acrylic
Division 60	INTERMEDIATE Charcoal, Pastels, Conte Crayon
Division 61	INTERMEDIATE Water Color
Division 62	INTERMEDIATE Pen & Ink or Pencil
Division 63	INTERMEDIATE Any other, specify
Division 64	ADVANCED/PRO Oil or Acrylic
Division 65	ADVANCED/PRO Charcoal, Pastels, Conte Crayon
Division 66	ADVANCED/PRO Water Color
Division 67	ADVANCED/PRO Pen & Ink or Pencil
Division 68	ADVANCED/PRO Any other, specify

CLASS

1	Animal, Bird
2	Architecture
3	Floral, Still Life
4	Landscape, Seascape
5	Portrait
6	Any other, specify

FOOD-BAKING & CONFECTIONS

"Cooking well doesn't mean cooking fancy." -Julia Child

One Best of Division Ribbon will be awarded in each Division with one Best of Show being chosen from division winners in Baking & Confections. American System of Judging. Please read general rules on page 8 and Baking & Confection rules below.

BAKING & CONFECTION GUIDELINES

1. Your recipe must be submitted with each entry. Please clearly print or type the recipe on one side of a white 5"x 8" recipe card. On the back of the card please print the exhibitor's name, division and class.
2. All entries must be made from scratch and entered on a disposable plate or container in a zip lock bag. Entries will not be returned.
3. Enter one whole loaf or 7 muffins or rolls.
4. Enter one whole pie in a disposable pie pan.
5. Enter one whole cake on a disposable plate. No cupcakes.
6. Enter seven pieces of confections.
7. Enter seven cookies.
8. Enter two cups trail mix in a disposable container or zip lock bag.
9. Enter 7 pieces of dehydrated foods in a snack-size zip lock bag.

YOU COULD WIN MONEY!

PRIZES OFFERED PER CLASS

1st Place	\$5.00
2nd Place	\$3.00
3rd Place	\$2.00

Entry Fees: \$1.00 per entry per class

THIS IS HOW YOU DO IT!

1. Decide what division(s) and class(es) you are entering.
2. Visit maderafair.com to create a username for entering online and follow the steps to enter. ONLINE STILL and FLORICULTURE entries are FREE until August 1st, 2022.
3. IF you prefer paper entry, a form is in the book, available at maderafair.com OR in the Madera Fair office.
4. Submit online entry OR paper entry form to Madera Fair on or before August 23rd, 2022, pay applicable entry fees. Entry fees, if applicable can be found at each Division.
5. Bring Exhibit on TUESDAY, Sept. 6th, 2022 from 4-8 PM. Unless specific contest states otherwise. For special food contests, see pg. 6 for receiving date and time.

DIVISION 69 BREAD

CLASS

1	Bread-Machine Made
2	Muffins, specify
3	Quick Breads, fruit or vegetable
4	Quick Breads, nut or grain
5	Yeast Breads or Rolls
6	Any other, specify

DIVISION 70 PIE

CLASS

1	Berry
2	Fruit other than berry
3	Nut
4	Refrigerated (Cream or Custard)
5	Any other, specify

DIVISION 71 COBBLER

CLASS

1	Berry
2	Fruit



FOOD-BAKING & CONFECTIONS

DIVISION 72 CHEESECAKE

CLASS

- | | |
|---|-------------------|
| 1 | Any type, specify |
|---|-------------------|

DIVISION 73 CAKE

CLASS

- | | |
|---|--------------------|
| 1 | Bundt cake |
| 2 | Layer cake |
| 3 | Pound or Loaf cake |
| 4 | Any other, specify |

DIVISION 74 CONFECTIONS

CLASS

- | | |
|---|---------------------|
| 1 | Fudge |
| 2 | Nut Brittle, Toffee |
| 3 | Any other, specify |

PIE vs. COBBLER...

What Is Pie?

Pie is a baked dish featuring a fruit filling encased in dough, which is called a pie crust or pie shell once baked. Pies can have a double-crust (filling is fully encased in pie dough), single-crust (open top, with a single, blind-baked bottom crust), or somewhere in between (think fancy lattice tops). Pies can be sweet or savory or steak and ale pie, anyone?

What Is Cobbler?

A cobbler is a freeform dessert consisting of a fruit base and a slightly sweet biscuit topping. The biscuit dough is traditionally dropped over the top of the fruit to create a cobbled together crust in a baking dish.

While the sheer enjoyment resulting from either fruit dessert is about equal (and both play quite nicely with a scoop of vanilla ice cream or fluffy dollop of whipped cream), pie and cobbler require different levels of finesse. Cobblers are rougher and perhaps more rustic, while an expert pie dough takes a bit of practice to get just right. A cobbler recipe can be whipped up in roughly an hour, whereas a pie can take all day.
-masterclass.com

DIVISION 75 COOKIES

CLASS

- | | |
|---|--------------------|
| 1 | Bar Cookies |
| 2 | Drop Cookies |
| 3 | Molded Cookies |
| 4 | Any other, specify |

DIVISION 76 GLUTEN FREE

CLASS

- | | |
|---|--------------------|
| 1 | Bread |
| 2 | Cake |
| 3 | Cookies |
| 4 | Any other, specify |



See 2022 FEATURED EVENTS
for special baking contests pg. 12-13

"LOCAL GROWN PIES"
"CUPCAKE WARS"
"SALSA"
"BABY BACK RIBS"

and NEW this year...

"THE GREAT AMERICAN CHOCOLATE
CHIP COOKIE CONTEST"

For youth baking see pg. 31 in
YOUTH CONTESTS.

FOOD-PRESERVES

"You are the peanut butter to my jelly." - Bread

One Best of Division Ribbon will be awarded in each Division with one Best of Show being chosen from division winners in Preserved Foods. American System of Judging. Please read general rules on page 8 and Preserve rules below.

PRESERVED FOOD

GUIDELINES

1. All entries must be labeled with the following: product name, processing method and length of processing time. All entries must have been prepared and canned within the last year and include the date of preparation.
2. Two standard jars, specifically for canning purposes, same size and shape are required for each entry. **All jars must be thoroughly cleaned.** They must have clean, standard canning lids, sealed tightly, with loosened rings. Please no rusty rings and no paraffin seals.
3. Enter 7 pieces of dehydrated foods in a snack size zip lock bag.
4. One container will be opened for judging. The other container will remain on display for duration of the fair. The opened jar may be picked up the day after judging.
5. *****NOTE***** If you are entering as an organized youth participant, please include your age, grade and club information including your leader's phone number.

YOU COULD WIN MONEY!

PRIZES OFFERED PER CLASS

1st Place	\$5.00
2nd Place	\$3.00
3rd Place	\$2.00

Entry Fees: \$1.00 per entry per class

THIS IS HOW YOU DO IT!

1. Decide what division(s) and class(es) you are entering.
2. Visit maderafair.com to create a username for entering online and follow the steps to enter. ONLINE STILL and FLORICULTURE entries are FREE until August 1st, 2022.
3. IF you prefer paper entry, a form is in the book, available at maderafair.com OR in the Madera Fair office.
4. Submit online entry OR paper entry form to Madera Fair on or before August 23rd, 2022, pay applicable entry fees.
5. Bring Exhibit on FINAL receiving days, Aug. 29th or 30th, 2022. Unless specific contest states otherwise. For special food contests, see pg. 6 for receiving date and time.

DIVISION 77

CANNED FRUITS & VEGGIES

CLASS

1	Apples, Applesauce
2	Apricots, Peaches
3	Pears
4	Any other fruit, specify
5	Corn
6	Beans (any)
7	Tomatoes
8	Any other vegetable, specify

DIVISION 78

PICKLES, RELISH, SAUCES

CLASS

1	Pickles, Cucumber
2	Pickles, other
3	Relishes
4	Any other, specify



DIVISION 79
JAMS, JELLIES & SPREADS

CLASS

- | | |
|---|--------------------|
| 1 | Apricot, Peach |
| 2 | Berry, other |
| 3 | Strawberry |
| 4 | Vegetable, Pepper |
| 5 | Butters |
| 6 | Marmalade |
| 7 | Preserves |
| 8 | Any other, specify |

DIVISION 80
DRIED FOODS

CLASS

- | | |
|---|--------------------|
| 1 | Fruit |
| 2 | Jerky |
| 3 | Vegetable |
| 4 | Trail Mix |
| 5 | Any other, specify |

For youth preserves see pg. 32 in
YOUTH CONTESTS



FOOD-PRESERVES



In 1937, the division CANNED FRUIT had 15 classes to enter. JAMS, PRESERVES and MARMALADES had 18, including watermelon preserve and tomato marmalade! The JELLY division had 15 classes. The SPICEFRUIT and PICKLES division included sweet cucumber, sour cucumber, dill pickles, bread and butter pickles, mixed pickles and MUSTARD pickles... makes your mouth pucker!

The time honored skill of preserving, pickling and canning lives on in 2022. Who do you owe your skills to?

HOBBIES & CRAFTS

"Happy is the man who is living by his hobby." G. Bernard Shaw

One Best of Division Ribbon will be awarded in each Division with one Best of Show being awarded overall in Hobbies & Crafts from each Division winner. American System of Judging. Please read general rules on page 8 and the guidelines below.

GUIDELINES

1. All entries must have been made or completed by the exhibitor within the last 24 months.

THIS IS HOW YOU DO IT!

1. Decide what division(s) and class(es) you are entering.
2. Visit maderafair.com to create a username for entering online and follow the steps to enter. ONLINE STILL and FLORICULTURE entries are FREE until August 1st, 2022.
3. IF you prefer paper entry, a form is in the book, available at maderafair.com OR in the Madera Fair office.
4. Submit online entry OR paper entry form to Madera Fair on or before August 23rd, 2022, pay applicable entry fees.
5. Bring Exhibit on FINAL receiving days, Aug. 29th or 30th, 2022. Unless specific contest states otherwise.

YOU COULD WIN MONEY!

PRIZES OFFERED PER CLASS

applies to Div. 81-84

1st Place	\$5.00
2nd Place	\$3.00
3rd Place	\$2.00

Entry Fees: \$1.00 per entry

Beginner = Exhibitor who has two years or less experience in the division.

Intermediate and Advanced = Exhibitor who has two or more years experience in the division.

CHOOSE DIVISION CRAFTS

Division 81	BEGINNER-Adult Crafts
Division 82	INTERMEDIATE and ADVANCED-Adult Crafts

CLASS

1	Centerpiece, Table Decoration
2	Shadowbox
3	Wall Hanging, any medium
4	Ornament, any
5	Pillow, Table Runner
6	Christmas (i.e. tree skirt, stocking, etc)
7	Sculpture- Clay, Pottery

8	Sculpture - Metal
9	Woodcarving, Woodwork (Kit, Beginner or Intermediate only)
10	Woodcarving, Woodworking
11	Jewelry
12	Tole and Decorative painting, any medium
13	Scrapbooking (1-2 page spread)
14	Any other not listed, specify

DIVISION 83

"SIGN SAYS..."

ALL SKILL LEVELS

Grab a piece of wood, chalkboard or other and express yourself with a creative single word or notion. Size not to exceed 12"x 24".

CLASS

1	Simple Single Word
---	--------------------

DIVISION 84

"SECOND TIME AROUND"

ALL SKILL LEVELS

Have you ever said to yourself, "Why are they getting rid of that?!" I could turn it into a ____!" Well now is your chance. Repurpose that household item, flea market or thrift store find into something useful and beautiful again. Let your imagination run wild!

PRIZES OFFERED PER CLASS

1st Place	\$15.00
2nd Place	\$10.00
3rd Place	\$7.00

Entry Fees: \$1.00 per entry per class

CLASS

1	Trash to Treasure (cans, glass, plastic, cardboard)
2	Market, Thrift Store clothing upcycle
3	Refurbished Household Item
4	Any other not listed, specify

PHOTOGRAPHY

"You don't take a photograph. You make it." -Ansel Adams

Go for it! Let your photo do the talkin'! One Best of Division Ribbon will be awarded in each Division with one Best of Show selected from the Division winners. American System of Judging. Please read general rules on page 8 and the photography rules below.

PHOTOGRAPHY GUIDELINES

1. Two entries per class per person may be entered.
2. Any photo may be entered as long as it has never won an award at Madera District Fair.
3. Black & White prints may be entered in any class. However, for judging on Black & White technique, it must be entered in Black & White class # within your Division.
4. All photos must be taken by exhibitor.
5. Please provide an 8"x10" or 8"x12" print and mount on a **SINGLE** mat. Double or triple mat will be disqualified. We suggest glue dots or a strong adhesive when mounting your print.
6. All prints must include an adhesive hanger centered on the back and flush with the top edge. Hangers are available at the Fair Office or on receiving day free of charge.
7. All prints must be clearly marked with the exhibitors name, address, division, class and title on the back of the mat or mount.

YOU COULD WIN MONEY!

PRIZES OFFERED PER CLASS

1st Place	\$6.00
2nd Place	\$4.00
3rd Place	\$2.00

Entry Fees: \$1.00 per entry per class

THIS IS HOW YOU DO IT!

1. Decide what division(s) and class(es) you are entering.
2. Visit maderafair.com to create a username for entering online and follow the steps to enter. ONLINE STILL and FLORICULTURE entries are FREE until August 1st, 2022.
3. IF you prefer paper entry, a form is in the book, available at maderafair.com OR in the Madera Fair office.
4. Submit online entry OR paper entry form to Madera Fair on or before August 23rd, 2022, pay applicable entry fees.
5. Bring Exhibit on FINAL receiving days, Aug. 29th or 30th, 2022. Unless specific contest states otherwise.

Determine your SKILL LEVEL based on your experience in competing with your photography print(s). You'll choose the DIVISION accordingly.

Beginner = Exhibitor who has two years or less experience in the division.

Intermediate = Exhibitor who has two or more years experience in the division.

Advanced/Pro = Exhibitor who has achieved a marked degree of expertise in the division or has sold or made money from their work.

CHOOSE DIVISION PRINTS

Division 85	BEGINNER-Prints
Division 86	INTERMEDIATE-Prints
Division 87	ADVANCED/PRO-Prints

CLASS

What or who is the subject of your print? If a class does not reflect your subject, please choose CLASS 21, any other subject.

1	Abstract, Patterns, Shadows
2	Action, Sports
3	Agriculture
4	Animals, Pets
5	Architectural, Buildings
6	Birds, Fowl
7	Bridges, Fences
8	Children
9	Flowers, Plants
10	Historical
11	Humor
12	Landscape, Trees
13	Night Photo
14	People
15	Portrait
16	Seasons
17	Still Life
18	Sky: Clouds, Sunrise, Sunset
19	Water: Ocean, Marine, Lake
20	"Back To Simpler Time"
21	Any other subject not listed, specify
22	Black & White Technique, any subject
23	Photo Manipulation, any subject
24	Aerial Photos

PHOTOGRAPHY

How to mount your photo entry.

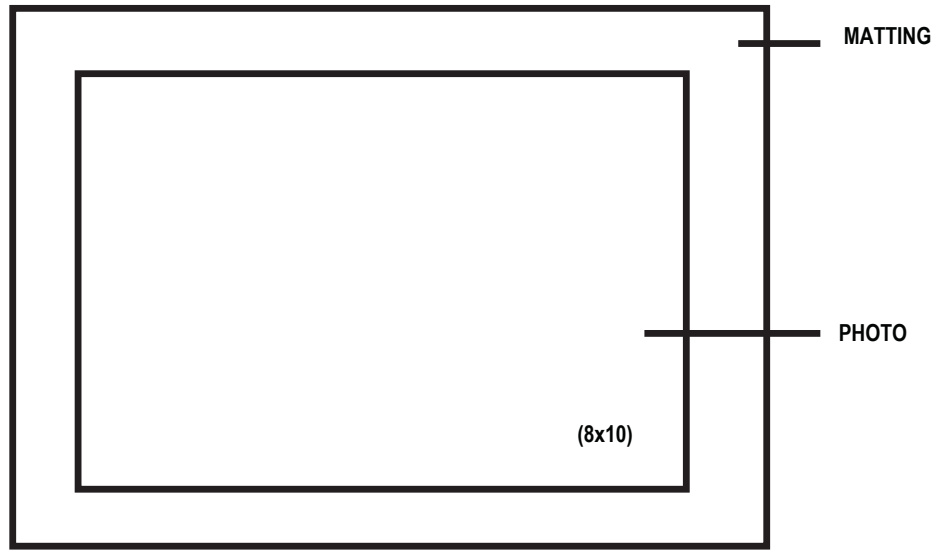

FRONT

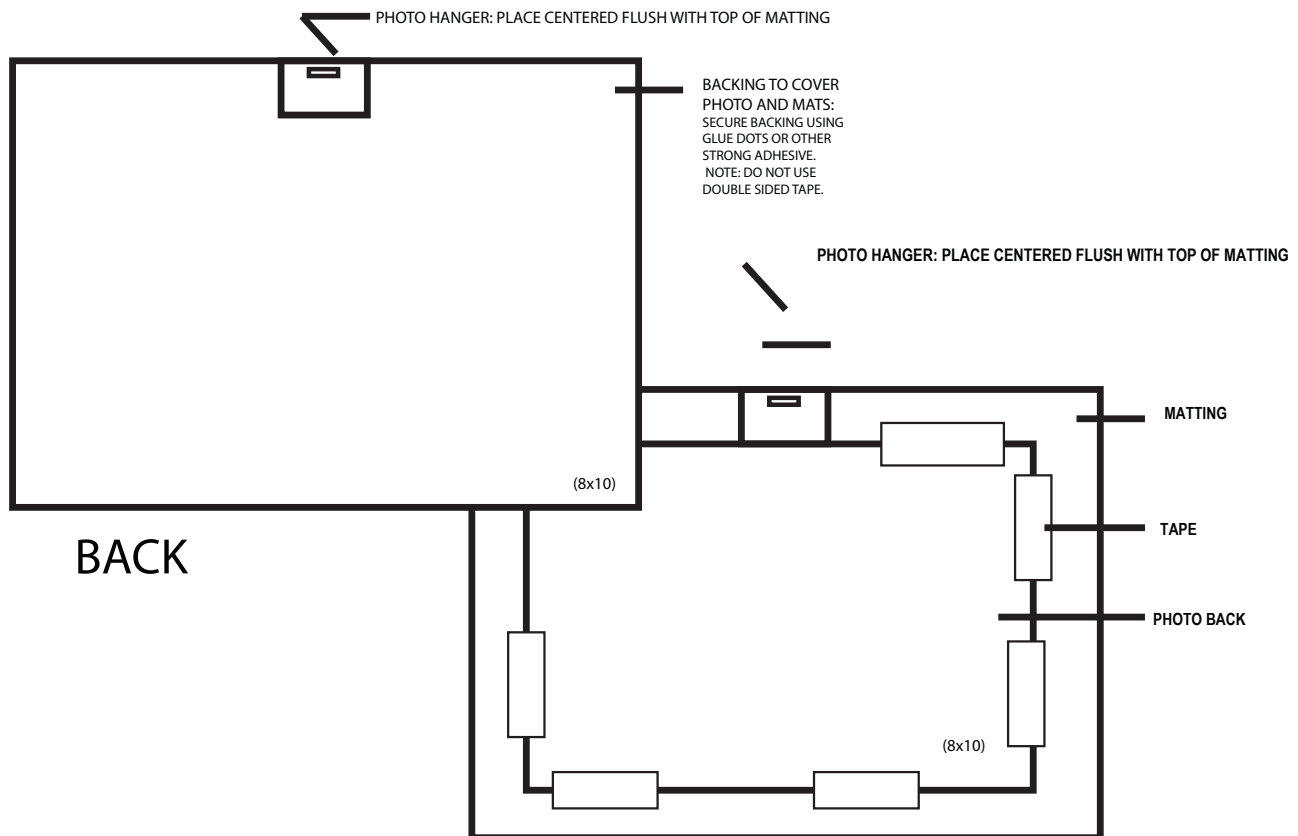

BACK

QUILTING

"When life gives you scraps, make a quilt!"

One Best of Division Ribbon will be awarded in each Division with one Best of Show being awarded to each skill level. American System Judging. Please read general rules on page 8 and the photography rules below.

QUILTING GUIDELINES

1. Quilts will not be accepted without a 4" sleeve to accommodate a pole for displaying. Sleeve directions: Prepare a strip of fabric 9" wide by width of your quilt; this strip may be pieced if necessary. Fold in half RST to form a long tube. Stitch a lengthwise 1/2" seam. Hem the sleeve ends 1". Turn the sleeve right side out. Position the sleeve, seam side down, on the back of the quilt, 1" below the top edge and 1" in from both sides. Baste or blind stitch sleeve into place, along BOTH folded edges, not sewing through the front.
2. All entries must have been made or completed by the exhibitor within the last 24 months.
3. KIT, defined as "ready to assemble".

THIS IS HOW YOU DO IT!

1. Decide what division(s) and class(es) you are entering.
2. Visit maderafair.com to create a user name for entering online and follow the steps to enter. ONLINE STILL and FLORICULTURE entries are FREE until August 1st, 2022.
3. IF you prefer paper entry, a form is in the book, available at maderafair.com OR in the Madera Fair office.
4. Submit online entry OR paper entry form to Madera Fair on or before August 23rd, 2022, pay applicable entry fees.
5. Bring Exhibit on FINAL receiving days, Aug. 29th or 30th, 2022 Unless specific contest states otherwise.

Determine your SKILL LEVEL based on your experience in competing with your finished products. You'll choose the DIVISION accordingly.

Beginner = Exhibitor who has two years or less experience in the division.

Intermediate = Exhibitor who has two or more years experience in the division.

Advanced/Pro = Exhibitor who has achieved a marked degree of expertise in the division or has sold or made money from their work.

YOU COULD WIN MONEY!

PRIZES OFFERED PER CLASS

1st Place	\$5.00
2nd Place	\$3.00
3rd Place	\$2.00

Entry Fees: \$1.00 per entry per class

CHOOSE DIVISION QUILTING

Division 88	BEGINNER- Hand Tied
Division 89	BEGINNER- Hand Quilted
Division 90	BEGINNER- Machine Quilted by other
Division 91	BEGINNER- Machine Quilted by maker
Division 92	BEGINNER- Baby Quilt (max. 45"x60")
Division 93	BEGINNER- Wall Hanging
Division 94	BEGINNER- Table Topper
Division 95	INTRMD- Hand Tied
Division 96	INTRMD- Hand Quilted
Division 97	INTRMD- Machine Quilted by other
Division 98	INTRMD- Machine Quilted by maker
Division 99	NTRMD- Baby Quilt (max. 45"x60")
Division 100	INTRMD- Wall Hanging
Division 101	INTRMD- Table Topper
Division 102	ADV/PRO - Hand Tied
Division 103	ADV/PRO- Hand Quilted
Division 104	ADV/PRO- Machine Quilted by other
Division 105	ADV/PRO- Machine Quilted by maker
Division 106	ADV/PRO- Baby Quilt (max. 45"x60")
Division 107	ADV/PRO- Wall Hanging
Division 108	ADV/PRO- Table Topper

CLASS

1	Appliqued by hand
2	Appliqued by machine
3	Made by two or more people
4	Pieced by hand
5	Pieced by machine
6	KIT, defined as "ready to assemble"
7	Any other not listed, specify

UNIQUELY CHALLENGED OR ASSISTED

"Different but not less." -Temple Grandin

One Best of Division Ribbon will be awarded in each Division. American System of Judging. Please read general rules on page 8 and guidelines below.

Uniquely Challenged or Assisted is for persons with learning disabilities, developmental or physical disabilities and enrolled in a group facility or adult day program such as, but not limited to: Heartland, CIWP, Star Center, ATP etc...

Exhibitors meeting these qualifications are not limited to this section. You are encouraged to participate in the entirety of the Handbook at your will!

Only (2) entries per class per exhibitor in this department.

THIS IS HOW YOU DO IT!

1. Decide what division(s) and class(es) you are entering.
2. Visit maderafair.com to create a username for entering online and follow the steps to enter.
3. IF you prefer paper entry, a form is in the book, available at maderafair.com OR in the Madera Fair office.
4. Submit online entry OR paper entry form to Madera Fair on or before August 23rd, 2022, pay applicable entry fees.
5. Bring Exhibit on FINAL receiving days, Aug. 29th or 30th, 2022. Unless specific contest states otherwise.

YOU COULD WIN MONEY!

PRIZES OFFERED PER CLASS in DIVs. 109-113.

1st Place	\$5.00
2nd Place	\$3.00
3rd Place	\$2.00

NO Entry Fees

DIVISION 109 CRAFTS

CLASS

1	Beads, Jewelry
2	Ceramics, Clay
3	Knitting, Crocheting, Sewing
4	Wood
5	Any other, specify

DIVISION 110

PAINTING & DRAWING

Artwork cannot exceed 12"x18"

CLASS

1	Markers, Crayons and/or Colored Pencils
2	Paint by Number
3	Tempera Paints
4	Watercolor
5	Any other, specify

DIVISION 111

BAKING

1. (7) muffins, cookies or bar cookies to be entered.
2. Include 5"x8" recipe card.
3. Food items received on Tuesday, September, 6th.

CLASS

1	Cookies, Bar Cookies
2	Any other, specify

DIVISION 112

PHOTOGRAPHY

Photos may be 5"x7" or 8"x10". Prints must be SINGLE matted or mounted, see pg. 24. NO frames. NO glass.

CLASS

1	People, Portraits, Animals, Birds
2	Any other not listed, specify

DIVISION 113

FLORICULTURE - GARDENING

A dish garden is a container in which (3) different plants are rooted and growing. see pg. 34 for floriculture receiving date(s).

CLASS

1	Dish Garden
---	-------------

YOUTH CONTESTS

"Think left, think right and think low and think high.
Oh, the things you can think up only if you try!" -Dr. Suess

This includes all contests open for YOUTH exhibitors AND school exhibitors. Please read general rules on page 8 and specific guidelines for each contest where applicable.

CLASSROOM GUIDELINES

No entry fees - Ribbon Award only

DANISH SYSTEM OF JUDGING

1. Classroom projects are for **TEACHERS ONLY** entering for each student in their classroom, either as individuals or one entry created by many. Each student will receive a ribbon for his/her accomplishment.
2. **DIV. 114 and 115 MUST have student's full name, school, grade and teacher's name labeled on the FRONT of each child's entry. EXHIBITS MAY NOT BE RECEIVED IF THIS STEP IS NOT COMPLETED. THIS IS THE ONLY IDENTIFYING ELEMENT on students work.**
3. Include a legible classroom list with each child's name recorded as it appears on the FRONT of their entry. If you choose to photocopy your roll sheet, please clearly note any name changes so that the names will match the names on the front of each child's entry.
4. All work must have been done by Madera County students within the last 12 months.
5. Maximum 2 entries per student may be entered in Div. 114. Artwork should not exceed 12"x18".
6. Maximum 1 entry per classroom may be entered in Div. 115.

Entry Forms due: TUES. AUGUST 23rd by 8 PM

Exhibits due: TUES. AUGUST 30th by 8 PM

CHOOSE DIVISION CLASSROOM PROJECT

Madera Fair is honoring the past and "Back to the Memories!" You are welcome to incorporate these ideas OR enter any wonderful artwork your students create! ALL classroom projects are welcome. Use one or many forms of media, the sky's the limit.

Division 114	Same project, individually created
Division 115	One item/exhibit created by many

CLASS

1	Pre-School - Kinder
2	Grade 1-3
3	Grade 4-6
4	Grade 7-8
5	Grade 9-12
6	SPED Classes

GENERAL YOUTH GUIDELINES

1. The American System of Judging will be used.
2. All food entries must be on a disposable plates, pans or containers. NO EXCEPTIONS.
3. Your entry becomes the property of the Madera District Fair. A portion of all entries may be on display for the remainder of the Fair. Foods that are no longer presentable due to spoilage will be disposed.
4. One entry per class per exhibitor. One free gate admission will be provided for Special Food Contest Exhibitor to deliver their food entry.
5. Recipes must be submitted on a white 5"x8" recipe card. If they are not, be prepared to copy your recipe onto the correct card at receiving. DO NOT put your name on the card. Your exhibit number will be placed on your recipe at receiving. Special contest recipes may be published.
6. Exhibitors 18 years of age and under may enter any FEATURED CONTEST (as an adult) if there is not a comparable one in the Youth Division.

SEE PG. 15 for EXHIBIT DATES AND TIMES

THIS IS HOW YOU DO IT!

1. Decide what division(s) and class(es) you are entering.
2. Visit maderafair.com to create a username for entering online and follow the steps to enter.
3. IF you prefer paper entry, a form is in the book, available at maderafair.com OR in the Madera Fair office.
4. Submit online entry OR paper entry form to Madera Fair on or before August 23rd, 2022, pay applicable entry fees.
5. Bring Exhibit on FINAL receiving days, Aug. 29th or 30th, 2022. Unless specific contest states otherwise.



YOUTH CONTESTS

HOBBY, CRAFT, PAINTING & DRAWING GUIDELINES

1. Exhibitors limited to (2) entries per class.
2. All entries must have been made or completed by the exhibitor within the last 12 months.
3. Include exhibitor's full name as listed on entry form on the back of the artwork.
4. Please note age and grade on entry form.
5. Construction paper matting on paintings and drawings is encouraged. Total size of artwork not to exceed 12"x18".
6. Large structures must be secured on a surface that can be easily moved. Mounting boards are not to exceed 18"x18".
7. ***NOTE*** If you are entering as an organized youth participant, please include your age, grade, and club information including your leader's phone number.

Free Online Entries
STILLS and FLORICULTURE
 until August 1st, 2022!

AMERICAN SYSTEM OF JUDGING

One Best of Division Ribbon will be awarded in DIV. 116 & 117

YOU COULD WIN MONEY!

PRIZES OFFERED PER CLASS

1st Place	\$7.00
2nd Place	\$5.00
3rd Place	\$3.00

NO Entry Fees

DIVISION 116

"LET'S RIDE in LEGOS"

That's right, let's build our ride to the fair. You can create the best form of transportation, spinning out of LEGOS! Show off your builder skills with a creation not exceeding 12" in any one direction. Entry must be one unit. KRAGLE or NOT TO KRAGLE is up to you. WINNER receives a LEGO set. 1 prize per class.

CLASS

1	Grade K-3 or Ages 5-8
2	Grade 4-6 or Ages 9-12
3	Grade 7-12 or Ages 13-18



DIVISION 117

"HIP, HIP HOORAY"

Pennants are a sign of support, celebration and pride. Sports teams, cities, schools and life's moments. Let us display your spirit. Pennant can be crafted out of any media. Not longer than 18" or wider than 10". Finished pennants will be hung in a banner display.

CLASS

1	Grade K-3 or Ages 5-8
2	Grade 4-6 or Ages 9-12
3	Grade 7-12 or Ages 13-18

YOUTH CONTESTS

Pre-School and Elementary HOBBY, CRAFT, PAINTING & DRAWING

DANISH SYSTEM OF JUDGING

NO entry fees
Ribbon only

DIVISION

Division 118	Preschool-K
Division 119	Grade 1-3
Division 120	Grade 4-6

CLASS

1	Ceramics, Pottery
2	Finger Painting
3	Pinewood Derby
4	Jewelry, Beading
5	Woodburning
6	Model, Kit
7	Mosaic, Collage
8	Sewing-Craft
9	Acrylic, Oil Paint
10	Color Crayon
11	Charcoal, Chalk
12	Markers
13	Pencil, Colored Pencil
14	Tempera Paint
15	Watercolor
16	Any other, specify

AMERICAN SYSTEM OF JUDGING

One Best of Division Ribbon will be awarded DIV. 121-132

YOU COULD WIN MONEY!

PRIZES OFFERED PER CLASS

1st Place	\$3.00
2nd Place	\$2.00
3rd Place	\$1.00

NO Entry Fees

Jr. High & High School HOBBY and CRAFT

DIVISION

Division 121	Grade 7-8 Hobby & Craft
Division 122	Grade 9-12 Hobby & Craft

CLASS

1	Clay, Ceramics, Pottery
2	Collage, Mosaic
3	Jewelry, Beading
4	Leatherwork
5	Small items, tool box, stool
6	Papier Mache'
7	Sewing
8	Scrapbooking (3pgs)
9	Sculpture
10	Carved items, pens
11	Any other, specify

Jr. High & High School PAINTING and DRAWING

DIVISION

Division 123	Grade 7-8	Oil & Acrylic
Division 124	Grade 7-8	Charcoal, Pastels or Conte Crayon
Division 125	Grade 7-8	Water Color
Division 126	Grade 7-8	Pen & Ink or Pencil
Division 127	Grade 7-8	Any other, specify
Division 128	Grade 9-12	Oil & Acrylic
Division 129	Grade 9-12	Charcoal, Pastels or Conte Crayon
Division 130	Grade 9-12	Water Color
Division 131	Grade 9-12	Pen & Ink or Pencil
Division 132	Grade 9-12	Any other, specify

CLASS

1	Abstract
2	Animal, Bird
3	Floral, Still Life
4	Landscape, Seascape
5	Portrait, People
6	Any other, specify

YOUTH CONTESTS

PHOTOGRAPHY GUIDELINES

1. Youth prints may be 5"x7" or 8"x10" only.
2. All prints must include an adhesive hanger centered on the back and flush with the top edge. Madera Fair can provide free of charge.
3. Two entries per class per person may be entered.
4. Please read general rules on pg. 8 and photography rules on pg. 9.
5. Black & White prints may be entered in any class. However, for judging on Black & White technique, it must be entered in Black & White class # within your Division.

*****NOTE***** If you are entering as an organized youth participant, please include your age, grade, and club information including your leader's phone number.

AMERICAN SYSTEM OF JUDGING

One Best of Division Ribbon will be awarded in each Division

YOU COULD WIN MONEY!

PRIZES OFFERED PER CLASS

1st Place	\$3.00
2nd Place	\$2.00
3rd Place	\$1.00

CHOOSE DIVISION PRINTS

Division 133	Prints-Grade K-3
Division 134	Prints-Grade 4-6
Division 135	Prints-Grade 7-12

CLASS

1	Animals, Birds
2	Digital Manipulation
3	Mother Nature
4	People, Portrait
5	Oh, So Happy!!
6	Water Play
7	Black & White Technique, any subject
8	Photoshopped
9	Any subject not listed, specify

SEWING & NEEDLEWORK GUIDELINES

1. *****NOTE***** If you are entering as an organized youth participant, please include your age, grade, and club information including your leader's phone number.
2. All entries must have been made or completed by the exhibitor within the last 24 months.
3. Please read general rules on pg. 8.

AMERICAN SYSTEM OF JUDGING

One Best of Division Ribbon will be awarded in each Division

YOU COULD WIN MONEY!

PRIZES OFFERED PER CLASS

1st Place	\$3.00
2nd Place	\$2.00
3rd Place	\$1.00

CHOOSE DIVISION SEWING & NEEDLEWORK

Division 136	Grade K-6th
Division 137	Grade 7-12th

CLASS

1	Embroidery, Latch Work
2	Knitting, Crocheting
3	Sewing Garment, specify
4	Sewing, Large Item (quilt, wall hanging)
5	Sewing, Small Item (tote bag, pillow)
6	Any other, specify



FREE RIDES AT MADERA DISTRICT FAIR!

For every 2 BOOKS you read, get 1 FREE ride ticket.
www.maderafair.com

YOUTH CONTESTS

BAKING & CONFECTION GUIDELINES

1. Your recipe must be submitted with each entry.
Please clearly print or type the recipe on one side of a white 5"x 8" recipe card. On the back of the card please print the exhibitor's name, division and class.
2. All entries must be made from scratch and entered on a disposable plate or container in a zip lock bag. Entries will not be returned.
3. Enter one whole loaf or 7 muffins or rolls.
4. Enter whole cake on a disposable plate or (7) cupcakes.
5. Enter seven pieces of candy.
6. Enter seven cookies.
7. A total of 2 entries per class.

*****NOTE***** If you are entering as an organized youth participant, please include your age, grade, and club information including your leader's phone number.

DANISH SYSTEM OF JUDGING

One Best of Division Ribbon will be awarded in each Division

YOU COULD WIN MONEY!

BAKING & CONFECTION SWEEPSTAKES AWARD

Sponsored by Randy & Sheryl Berry

\$25.00 will be awarded to the top points receiver in Junior Baking and Confections. All junior exhibitors, entering independently or with an organized youth group are eligible for this award. (Divisions 138 -145) The sweepstakes point system is scored as follows: First Place = 3 points, Second Place = 2 points, and Third Place = 1 point. The junior exhibitor with the highest accumulated score will be awarded the sweepstakes.

ADDITIONAL PRIZES OFFERED PER CLASS

1st Place	\$3.00
2nd Place	\$2.00
3rd Place	\$1.00

NO Entry Fees

CHOOSE DIVISION CAKES OR CUPCAKES

Division 138	Grade K-6
Division 139	Grade 7-12

CLASS

1	Bundt Cake
2	Cupcake
3	Layer or Loaf Cake
4	Any other, specify

CHOOSE DIVISION BREAD

Division 140	Grade K-6
Division 141	Grade 7-12

CLASS

1	Fruit or Vegetable
2	Muffins, specify
3	Yeast breads, Rolls
4	Any other, specify

CHOOSE DIVISION COOKIES

Division 142	Grade K-6
Division 143	Grade 7-12

CLASS

1	Bar Cookies
2	Drop Cookies
3	Molded Cookies
4	Any other, specify

CHOOSE DIVISION CONFECTIONS

Division 144	Grade K-6
Division 145	Grade 7-12

CLASS

1	Fudge
2	Any other, specify

YOUTH CONTESTS

PRESERVES GUIDELINES

1. All entries must be labeled with the following: Product name, processing method and length of processing time. All entries must have been prepared and canned within the last year and include the date of preparation.
2. Two standard jars, specifically for canning purposes, same size and shape are required for each entry. All jars must be thoroughly cleaned. They must have clean, standard canning lids, sealed tightly, with loosened rings. Please no rusty rings and no paraffin seals.
3. Enter 7 pieces of dehydrated foods in a snack size zip lock bag.
4. A total of (12) items total may be entered per division.
5. One container will be opened for judging. The other container will remain on display for duration of the fair. The opened jar may be picked up the day after judging.

*****NOTE***** If you are entering as an organized youth participant, please include your age, grade and club information including your leader's phone number.

DANISH SYSTEM OF JUDGING

One Best of Division Ribbon will be awarded in each Division

YOU COULD WIN MONEY!

\$50 SPECIAL AWARD

The Lorraine Tune-Hartley Canning Award Sponsored by Gary & Pam Tune

One Best of Division winner will be chosen from Divisions 146 or 147. Youth Preserved Foods will receive a \$50.00 special award
In Loving Memory of Lorraine Tune-Hartley.

\$25 SPECIAL AWARD

Sponsored by Randy & Sheryl Berry

\$25.00 will be awarded to the top points receiver in Youth Food Preservation. All youth exhibitors, entering independently or with an organized youth group are eligible for this award. (Divisions 146 & 147) The sweepstakes point system is scored as follows: First Place = 3 points, Second Place = 2 points, and Third Place = 1 point. The youth exhibitor with the highest accumulated score will be awarded the sweepstakes.

ADDITIONAL PRIZES OFFERED PER CLASS

1st Place	\$3.00
2nd Place	\$2.00
3rd Place	\$1.00

NO Entry Fees

CHOOSE DIVISION PRESERVES

Division 146

Grade K-6

Division 147

Grade 7-12

CLASS

- | | |
|---|--|
| 1 | Fruit, Canned, any variety, specify |
| 2 | Vegetable, Canned, any variety, specify |
| 3 | Soft Spreads, (jams, jelly, etc.) any, specify |
| 4 | Pickles, any variety, specify |
| 5 | Dried Foods, any item, specify |
| 6 | Any other preserved item not listed, specify |

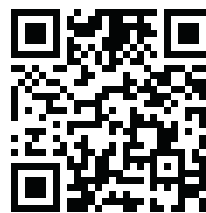

Buy Pre-Sale
CARNIVAL COUPONS & SAVE!
online at maderafair.com

AG MECHANICS

"A dream doesn't become a reality through magic, it takes sweat, determination and hard work." -Colin Powell

One best of Division winner will be awarded in each Division, with one Best of Show being chosen from the winners. American system of judging. Please read general rules on page 8 and specific guidelines below.

AG MECHANIC GUIDELINES

1. LEADERS/ADVISORS email: lynnette@maderafair.com to schedule receiving between Aug. 29th and 30th, 2022. Exhibitors are limited to ONE entry per class. "Any Other Items" must be identified on the entry form.
2. FFA members entering exhibits in Agricultural Mechanics must be regularly enrolled in a high school that is following the California State plan for vocational agriculture.
3. Although the exhibits need not be owned by the exhibitor, all must be the products of the students as a regular part of their instruction in Agricultural Mechanics. The student exhibitor must have been at least the major contributor to the building or repairing of the exhibit. No entry may be shown for more than one calendar year. An article may not be entered in more than one class and each exhibitor may not enter more than one article from the same pattern. Display cards must be filled out and attached to each exhibit in this department, correctly labeling the exhibit and giving a brief summary of the student exhibitor's project.

DIVISION 148 and 149 CONSTRUCTION PROJECTS

PRIZES OFFERED PER CLASS

1st Place	\$20.00
2nd Place	\$15.00
3rd Place	\$10.00
NO entry fee	

Division 148 - SMALL PROJECTS

Small Projects constructed in which the material costs do not exceed \$50.00.

Division 149 - MEDIUM PROJECTS

Medium Projects constructed in which material costs are more than \$50.00 but do not exceed \$150.00.

CLASS

1	Cold Metal
2	Welding, Forging
3	Electrical
4	Woodwork
5	Rope Work
6	Combination
7	Sheet Metal
8	Any other, specify
9	Created by group, specify material

DIVISION 150 FARM EQUIPMENT REPAIRED

PRIZES OFFERED PER CLASS

1st Place	\$20.00
2nd Place	\$15.00
3rd Place	\$10.00
NO entry fee	

CLASS

1	Simple Repairs (\$50.00 or less)
2	Complex Repairs (\$50.00 or more)

DIVISION 151 and 152 FARM EQUIPMENT CONSTRUCTED

PRIZES OFFERED PER CLASS

1st Place	\$25.00
2nd Place	\$15.00
3rd Place	\$10.00
NO entry fee	

Division 151 - INDIVIDUAL Farm Equipment Construction
Division 152- GROUP (2 or more) Farm Equipment Construction

CLASS

1	Small projects, such as BBQ, hydraulic press, welding or cutting table, etc.
2	Medium projects, such as general purpose trailer (2-wheel), 4-wheel trailer, nut trailer, etc.
3	Large projects, such as equipment carriers, goose-neck type trailer, etc.



TABLE MOUNTAIN CONCERT SERIES

presented by ESTRELLA  JALISCO
ALL FREE WITH PAID GATE ADMISSION

Back to the Music



MADERA
DISTRICT FAIR

THANK YOU TO OUR SPONSORS!



**RANCHO
SAN MIGUEL**
100% EMPLOYEE OWNED MARKETS

ESTRELLA  JALISCO



**United
Rentals**



Vulcan
Materials Company

**MADERA
Tribune**

T-Mobile



NES



Fresno Madera Farm Credit

 **MADERA
COMMUNITY
COLLEGE**