



*All American*  
**PARTY**

STILLS *and* FLORICULTURE

SEPTEMBER 10-13TH 2026  
**FREE ONLINE ENTRIES**  
*Til August 1st*

# 2026 Madera District Fair Directors



**Rosanne Bonilla**  
**PRESIDENT**



**Billie Jelks-Hood**  
**VICE PRESIDENT**



**Isabel Barreras**



**Lois Leonard**



**Patty Manfredi**

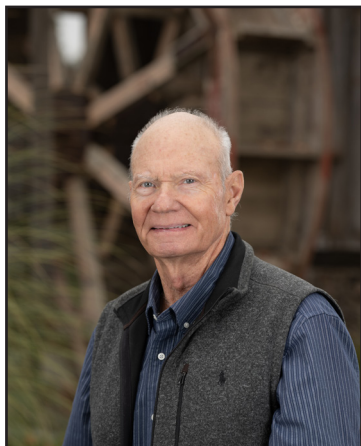

**Harvey "Skip" Pettit**



**Stephanie Simonian**



**Sheryl Sisil**

# TABLE OF CONTENTS

## GENERAL INFORMATION

	Page
Entry Form	4
Dates to Know	6
Exhibitor Information	7
Glossary of Terms	7
Local Rules	8
Exhibit Dates and Times	16
Floriculture Dates and Times	33

## FEATURED CONTESTS

2026 FEATURED Contests - Arts and Crafts	
“Alice in Wonderland”	10
“Collections”	10
Wrapped in Love with DOORS of HOPE	10
2026 FEATURED Contests - Photography	
All American Photos	11
Friends	11
2026 FEATURED Contests - Foods	
Great American Chocolate	
Chip Cookie Contest	11
Homemade Fruit Pies	11
BBQ Ribs	12
Cupcake Wars	12
All American Lemonade Contest	12
Salsa	12
2026 COLORING CONTEST	13/14
2026 SPECIAL Contests	
Pride of the Family	14
American Hero Display	14
2026 FAIR CAMP Contest	14
2026 Adult Lego Competition	15
Decorated Eggs	15
2026 All American Fashion Show	15
Beard & Mustache Contest	15

## ADULT CONTESTS (19 years and older)

Clothing and Textile	17
Fine Arts - Painting and Drawing	18
Foods	
Baking & Confections	19
Preserves	20
Hobbies and Crafts	21
Photography	22
Quilting	24
Uniquely Challenged or Assisted	
Arts and Crafts	25
Baking	25
Photography	25
Floriculture-Home Gardening	25

## YOUTH CONTESTS (18 years & younger)

Classroom Projects FOR TEACHERS ONLY (Pre-School - High School and SPED)	26
Arts and Crafts	27
Photography	28
Sewing and Needlework	29
Baking and Confections	30
Preserves	30
AG Mechanics	31

## FLORICULTURE-HOME GARDENING

Gardens	34
Home and Yard	35
Home Gardening - Produce	36
Arrangements	36
Plants	36
Cactus and Succulents	37
Classroom Floriculture Project	39
Youth Floriculture	39

## LIVESTOCK

Livestock Dates and Times	42
Auction Rules	47
Local Rules	47
Exhibitor Conduct	49
4H, FFA and Independents	50
Beef	51
Swine	55
Sheep	57
Goats	59
Dairy Goats	62
Pygmy Goats	64
Rabbits	65
Cavy	67
Poultry	68
Dog	72
Horse	73
Poster Contest	75
Barnyard Dress Up Contest	76
PeeWee Showmanship	77
Lad & Lassie	77
Adult Showmanship	78
Master Showmanship	78
Outstanding Exhibitor	78

A tall, illuminated tower with a glowing sphere at the top, and a large, illuminated sign for the 'VIPER' roller coaster. The sign features the word 'VIPER' in large, glowing letters, each letter inside a circular frame with a border of small lights. The background is dark, suggesting a night scene at a fair or carnival.

*save time*

**BUY**

**ONLINE**

**WWW.MADERAFAIR.COM**

ADMISSION AND CARNIVAL COUPONS



# EXHIBITOR ENTRY FORM

STILL EXHIBITS & FLORICULTURE

LAST NAME: \_\_\_\_\_ FIRST NAME: \_\_\_\_\_ MIDDLE INITIAL: \_\_\_\_\_

ADDRESS: \_\_\_\_\_ CITY: \_\_\_\_\_ ZIP: \_\_\_\_\_

EMAIL: \_\_\_\_\_ PHONE: \_\_\_\_\_ AGE: \_\_\_\_\_

SCHOOL/ORGANIZATION: \_\_\_\_\_ GRADE: \_\_\_\_\_

	DIVISION NUMBER	CLASS NUMBER	Name, Kind, Variety, Brief Description	ENTRY FEE
1				
2				
3				
4				
5				
6				
7				
8				

**Consult Exhibitor's Handbook for Division and Class Numbers, Entry Fees and Closing Dates** **TOTAL FEES**

The exhibitor agrees to defend, indemnify and hold harmless the Fair, the county and the State of California from and against any liability, claim, loss or expense (including attorney's fees) arising out of any injury or damage which is caused by, arises from or is in any way connected with participation in the program or event, excepting only that caused by the sole active negligence of the Fair. The Fair Management shall not be responsible for accidents or losses that may occur to any of the exhibitors or exhibits at the fair. The exhibitor (or parent or guardian of a minor) is responsible for any injury or damage resulting from the exhibitors participation in the program or event. This includes any injury to others or to the exhibitor or to the exhibitor's property. Exhibitor has read, understands and agrees to abide by all of the rules published in the Fair's Exhibitor Handbook.

**EXHIBITOR SIGNATURE:** \_\_\_\_\_ **PARENT/GUARDIAN SIGNATURE:** \_\_\_\_\_

I certify that this is the project of the exhibitor and is eligible to be shown in accordance with the rules of this show.

**ADVISOR/LEADER/TEACHER SIGNATURE & PHONE NUMBER:** \_\_\_\_\_ **CLUB/CHAPTER:** \_\_\_\_\_

**Exhibitor Last Name:** \_\_\_\_\_ **First Name:** \_\_\_\_\_

**FOR FAIR USE ONLY**

**DATE RECEIVED:** \_\_\_\_\_

**RECEIVED BY:** \_\_\_\_\_

**EXHIBITOR #:** \_\_\_\_\_

# GENERAL INFORMATION

## FAIR STAFF

Barbara Leach	CEO
Melissa Fornof	Deputy Manager
Lynnette Jacobsen	Exhibits Representative
Tina Sepulveda	Office Assistant
Jessie Quintero	Office Assistant
Vince Hernandez	Senior Maintenance
Robert Burke	Maintenance
Angelo Prado	Grounds
Anne Deniz	Livestock Superintendent
Don Myers	Livestock Operations Manager
Sandy Vaiarello	Stills and Floriculture Superintendent

## ADDRESS

Madera District Fair  
1850 W. Cleveland Avenue  
Madera, CA 93637  
[www.maderafair.com](http://www.maderafair.com)

## PHONE NUMBERS

MAIN LINE (559) 674-8511  
Livestock Office (559) 674-1224

## REGULAR OFFICE HOURS

Monday-Friday  
9:00 AM - 4:00 PM  
Closed Holidays

## FAIR TIME OFFICE HOURS

September 10-13, 2026  
Thursday-Sunday  
9:00 AM - 8:00 PM

## ENTRY CLOSING DAY HOURS

TUESDAY  
August 25th, 2026  
4:00 PM - 8:00 PM  
EXHIBIT HALL (HOME ARTS BUILDING)

## FAIR ADMISSIONS

General Admission at the Gate	\$15
Senior Citizens (62 and up)	\$10
Children 12 years and under	FREE
Pre-Sale General Admission	\$10

## FAIRGROUND HOURS

THURSDAY	5:00 PM - 11:00 PM
FRIDAY	5:00 PM - 11:00 PM
SATURDAY	3:00 PM - 11:00 PM
SUNDAY	3:00 PM - 11:00 PM

## CARNIVAL HOURS

THURSDAY	5:00 PM - 12:00 AM
FRIDAY	5:00 PM - 12:00 AM
SATURDAY	3:00 PM - 12:00 AM
SUNDAY	3:00 PM - 12:00 AM



# DATES TO KNOW

## ENTRIES and RECEIVING DATES

DATE	TIME	ENTRY FORM
August 7th		ALL LIVESTOCK ENTRIES DUE
Tuesday, August 25th <b>ENTRY FORM CLOSING</b>	4:00-8:00 PM	FLORICULTURE- Gardens, Potted Plants, Dry Arrangements, Florals, Cactus and Succulents EXHIBIT HALL- Junior, Adult, AG Mechanics, Special Contests and Classroom
August 25th August 25th September 1st		Last day for Poultry substitutions Last day for Rabbit and Cavy substitutions Last day for Dairy Goat and Pygmy Goat substitutions

**STILL and FLORICULTURE ONLINE ENTRIES ARE FREE UNTIL AUGUST 1ST!**

## EXHIBIT RECEIVING and CLAIMING DATES

DATE	TIME	EXHIBIT
Tuesday Aug. 31st & Sept 1st FINAL RECEIVING	4:00-8:00 PM	<b>Exhibit Hall</b> - All Adult and Youth Still Exhibits including Preserves <b>Floriculture</b> - Dry Arrangements, Wreaths and Yard Art *Save yourself a trip! Bring exhibits on entry closing date 8/25
Tuesday September 8th	4:00-8:00 PM	AG Mechanics- receiving information on page 31
Aug. 29th - Sept 11th	VARIED	Livestock- All Shows
Saturday, Sept. 12th	10:00 AM	<b>Livestock</b> - Auction
Monday, Sept. 7th	until 5:00 PM	Floriculture- Gardens Completed
Tuesday, Sept. 8th	4:00-8:00 PM	<b>Floriculture</b> - Potted Plants, Produce, Nature's Wonders, Fresh Arrangements
Tuesday, Sept. 8th	4:00-8:00 PM	<b>Exhibit Hall</b> - Baking & Confections for Adult, Youth Challenged Division
Thursday Sept 10th	5:45-6:15 PM	Beard and Mustache Contest! Judging at 6:30 PM
Thursday Sept 10th	6:00-6:45 PM	The Great American Chocolate Chip Cookie Contest! Judging at 7:00 PM
Friday, Sept. 11th	5:00-5:45 PM	Homemade Fruit Pies! Judging at 6:00 PM
Saturday, Sept. 12th	4:00-4:45 PM	BBQ Ribs! Judging at 5:00 PM
Saturday, Sept. 12th	5:00-5:45 PM	Cupcake Wars! Judging at 6:00 PM
Saturday, Sept. 12th	6:00-6:45 PM	All American Lemonade Contest! Judging at 7:00 PM
Sunday, Sept. 13th	4:00-4:45 PM	Salsa Contest! Judging at 5:00 PM
<b>DATE</b>	<b>TIME</b>	<b>CLAIMING YOUR EXHIBIT</b>
Tuesday, Sept. 15th	4:00-8:00 PM	<b>FLORICULTURE and EXHIBIT HALL</b>

**See  
FULL LIVESTOCK  
Book for more  
information**

# EXHIBITOR INFORMATION

Look for your department or talent in the bold headings across the top. Many DIVISIONS offer Skill Levels. Many CLASSES offer "any other", when, what or how you create is not an exact class. Our goal with the exhibitor handbook is to increase competition and interest while making it easy for EVERYONE to enter, even FIRST TIMERS! Competing at Madera Fair is fun for all.

Look through the book and find the areas that you are interested in entering. WHAT you do and HOW you do it! OR, HOW you do it and WHAT it is! This book is published yearly and lists all of the departments, divisions and classes that are available for entry. Notice the YOUTH CONTEST section! If we do not have a comparable contest in youth, then youth are welcome to enter the adult contest section. Please note: Livestock entries are online only.

## SECOND, Fill out your entry form.

Go to [maderafair.com/entry](http://maderafair.com/entry) and click the link to enter. ONLINE ENTRY will require you to create a user name and password OR sign-in with your existing one. Follow instructions to enter. Review your cart and confirm that all items have been entered. Select "check-out" to continue to payment screen. ALL STILL and FLORICULTURE ENTRIES ARE FREE until August 1st, 2026. PAPER ENTRY forms are available in the handbook, at [www.maderafair.com](http://www.maderafair.com) or from the Fair Office. Youth must include their age, grade and have a parent or leader sign. Please include phone number, complete address and email. Make sure both the division number and class number are clearly listed on the form. Enter the classes you feel are best suited for your exhibit. The Fair will attempt to enter exhibits in the proper classes when entries are made in error. However, the Fair will not be liable for entries made in error. Refer to rules listed in the department you are entering for further information. If you need help, call the Fair Office at 1 (559) 674-8511 or come in and see us Monday through Friday 9:00 AM to 4:00 PM. Complete online or bring your entry form and fees, by 8 PM on Tuesday, August 25th, 2026. LATE ENTRIES WILL NOT BE ACCEPTED!

## THIRD, Bring your exhibits to the Fairgrounds.

Be sure you have noted the receiving days as listed in the Exhibitor Handbook. Bring your exhibits between the hours listed, to the building indicated.

NOTE: All exhibits must be picked up on the date listed, in most cases the Tuesday following the closure of the Fair. The Fair is not responsible for items not claimed on or after the claiming date. Any remaining exhibits not claimed by October 30th may be donated or discarded.

## GLOSSARY OR TERMINOLOGY

**ADULT EXHIBITOR** - Persons that are age 19 years & older.

**ADVANCED/PROFESSIONAL** - Exhibitor who has achieved a

marked degree of expertise in the division or who has sold or made money from their work.

**AMERICAN SYSTEM OF JUDGING** - The judging process to rank exhibits against one another and award one first place, one second place, one third place, etc

**BEGINNER** - Exhibitor who has two years or less experience in the division.

**CLAIMING** - The dates and times that an exhibit is to be claimed (picked up) by the owner. Prize checks and ribbons are issued at the same time, except for livestock and special contests.

**CLOSING DATE** - The last date on which entry forms can be accepted. The forms can be delivered to the Fair office or postmarked by midnight on closing date.

**DANISH SYSTEM OF JUDGING** - The judging process to compare each exhibit on its own merit against a scorecard or recognized standard and award as many first place, second place, etc., as merited.

**ENTRY FEE** - The amount to be paid for each item entered, if required (always listed under the prizes offered).

**EXHIBIT** - The animal or item, which will be judged.

**INTERMEDIATE** - Exhibitor who has two years or more experience in the division.

**JUDGING** - Date and time of the judging. When judging is listed as open or live, it means that special arrangements have been made for a public audience.

**POP-UP CONTEST** - Exhibit contests that will be announced during FAIR TIME and on the grounds! Follow on Social Media for daily schedules and contests, times and locations, September 10th-13th, 2026.

**PRIZES OFFERED** - The amount awarded for a judged category. Also called PREMIUMS.

**RECEIVING** - The date and time when the exhibits will be accepted by the departments in which they have been entered. Items are received in the building or area where they will be shown.

**UNIQUELY CHALLENGED EXHIBITOR** - For persons with learning, developmental or physical disabilities and enrolled in a group facility or Adult Day Program.

**YOUTH EXHIBITOR** - Persons age 18 years and younger.

# RULES, RULES & A FEW MORE RULES.

## LOCAL RULES

### 21-A DISTRICT AGRICULTURAL ASSOCIATION MADERA DISTRICT FAIR

To enter an item in the Fair, all entries must be submitted online at [maderafair.com/entry](http://maderafair.com/entry) OR on paper entry forms furnished by the Madera District Fair.

Unless otherwise specified, all classes will be open to legal residents of Madera County only.

The Fair is not responsible for items not claimed by published claiming date. Floriculture Entries and Exhibit Hall entries must be claimed on Tuesday, Sept. 15th unless otherwise specified. See Junior Livestock department rules and regulations regarding the release of livestock and tack.

It is the intent of the Fair Management to award all Special Awards and or donated prizes to exhibitors as published in the Exhibitor's Handbook. Exhibitors must notify the Fair within 30 days of the end date of fair, for missing awards. Fair Management will not be held responsible for prizes not received from sponsors.

Fair management reserves the right to refuse, accept conditionally or cancel any entries, disqualify exhibitors, prohibit exhibition of entries, or cancel awards without claim for damages.

The Fair reserves the right to reject any entry if it is deemed objectionable or if it requires excessive space.

By signing and submitting an entry form the exhibitor and their agents, parents and leaders acknowledges: "The exhibitor agrees to defend, indemnify, and hold harmless the fair, the county, and the State of California from and against any liability, claim, loss, or expense (including attorneys' fees) arising out of any injury or damage which is caused by, arises from or is in any way connected with participation in the program or event, excepting only that caused by the sole active negligence of the Fair. The Fair Management shall not be responsible for accidents or losses that may occur to any of the exhibitors or exhibits at the fair. The exhibitor (or parent or guardian of a minor) is responsible for any injury or damage resulting from the exhibitor's participation in the program or event. This includes any injury to others or to the exhibitor or to the exhibitor's property." and agrees to read and understand the State Rules and Local Fair Rules;

Certify that all information on entry forms is true and accurate; agree to abide by all rules set forth by the Fair; and agree to comply with the Fair's decision regarding any alleged violation of the State or Local Rules.

In compliance with the Americans with Disabilities Act of 1990, exhibitors requesting disability-related accommodations need to contact their respective fair office prior to the fair event.

The Fair reserves the right to display exhibits as space permits. There is no guarantee that all items will be displayed.

All entries must be received or postmarked by Tuesday, Aug. 25th and post entries will not be accepted unless otherwise specified.

Please note: The Fair makes every effort to ensure that the information provided in the exhibitor handbook is accurate and free of typographical errors regarding the awarding of premiums and prizes. The Fair will not be held responsible for awarding duplicate premiums. The Fair will not be held responsible for items that have been disqualified at the Judge's discretion.

The Judge's decision is final. The Judge's book will be used as evidence for payment of premiums or special awards. Ribbons and Tags will not be accepted.

ALL STATE RULES APPLY, visit: <https://www.maderafair.com/p/fair/exhibitor-handbook>

### EXHIBIT HALL RULES All local rules apply.

This department is open to Madera County residents only. Exhibitors are responsible for knowing and abiding by local rules found in front of this book and all State Rules for California Fairs. A copy of the State Rules may be obtained at the fairgrounds or at: [www.cdfa.ca.gov/fe/](http://www.cdfa.ca.gov/fe/)

Unless stated otherwise, exhibitors are limited to (2) two entries in any one class. Unless stated otherwise, all entries must have been made or completed by the exhibitor within the last 12 months. Entries shall not have been shown previously at the Madera District Fair.

Names must be removed from articles, unless stated otherwise.

All entries are entered at the exhibitor's own risk. All possible caution will be taken, but the Fair will not be responsible for loss, damage or theft of any item. Any entries that are dirty, dusty or soiled will be disqualified and not displayed.

# RULES, RULES & A FEW MORE RULES

Unless stated otherwise, this department conducts closed judging procedures. No visitors or exhibitors are allowed in the building during judging. No judging results will be given over the telephone.

All entries must be clearly marked with the exhibitor's name, address, division, class and title on back.

Youth Exhibitors 18 years of age and under may enter any special contest (as an adult) if there is not a comparable one in the YOUTH division.

Fair management reserves the right to refuse, accept conditionally or cancel any entries, disqualify exhibitors, prohibit exhibition of entries or cancel awards, without claim for damages.

Please note: The Fair makes every effort to ensure that the information provided in the exhibitor handbook is accurate and free of typographical errors. The Fair will not be held responsible for awarding duplicate premiums or special awards. The Fair will not be held responsible for items that have been disqualified at the judge's discretion.

The judge's decision is final. The judge's book will be used as evidence for payment of premiums or special awards. Ribbons and Tags will not be accepted. No judging results will be given over the telephone.

## PHOTOGRAPHY RULES

1. Black & White prints may be entered in any class. However, for judging on Black & White technique, it must be entered in the Black & White class # within your Division.

2. All prints must be clearly marked on the back of the mat with the following information:

EXHIBITOR'S NAME  
Address  
Division & Class

\*\*\*ADVISEMENT: Our experience shows simply using double sided tape does not work. Often with the humidity in the building it becomes detached. We suggest glue dots or a stronger adhesive.

3. Images are not to be modified in any way that does not display a true representation of the subject matter of which the photo was taken. Minor corrections to enhance the color, contrast and brightness of a photo are allowed, as long as it is done in reasonable increments (as decided by judges) which do not alter the original natural form of the photograph.

Permitted Modifications: (1) image cropping and rotating as necessary (2) Color filters-only if they are used to color correct artificial lights. (3) Red-Eye removal and spot "dust marks" removal. (4) Use of artificial lighting such as flash, studio lights or reflectors used at the time the image was made. (5) Use of corrective functions to improve the natural appearance of the image, such as dodging, burning, levels, contrast, brightness, intensity, tone, saturation, lightness, value, color, balance and hue as long as they are done in reasonable increments and have not significantly modified or manipulated the photograph to appear unnatural, or deviate from the original subject matter of which they were taken.

Modifications **NOT** Permitted: (1) Watermarks, writing, hand markings, hand tinting, or physical modifications. (2) Spray matte, or any physical substance that may be added to alter the texture or appearance of print. (3) Adding or replacing elements or composite images. (4) Cloning or removal, replacing or addition of any elements in a photo. (5) Digital retouching or airbrushing. (6) Artistic filters such as fog, mist, warming, sunbursts or any other special effects filter. (7) Specialized treatments or cross processing of film.

Please see Photography section for more information.

*Free Online Entries*

**STILL and FLORICULTURE  
until August 1st, 2026!**

# 2026 FEATURED CONTESTS

Featured Contests are often ONE TIME only contests and have great cash premiums. American System of Judging for all special contests. **Please read general rules on pg. 8 and any special rules within each contest.**

\* Exhibitors 18 years of age and under may enter any special contest (as an adult) if there is not a comparable one in the Youth Division.

## THIS IS HOW YOU DO IT!

1. Decide what division(s) and class(es) you are entering.
2. Visit [maderafair.com/entry](http://maderafair.com/entry) to create a user name to enter online. ONLINE STILL and FLORICULTURE entries are FREE until August 1st, 2026.
3. Submit online entry on or before August 25th, 2026 pay applicable entry fees.
5. Bring Exhibit on FINAL receiving days, Aug. 31st or Sept 1st, 2026. Unless specific contest states otherwise. For special food contests, see pg.6 for receiving date and time.

## ART & CRAFT

### DIVISION 1

#### "A table set for "ALICE IN WONDERLAND"

Step into a world of whimsy and wonder with our Alice in Wonderland Contest, where imagination runs delightfully wild! Each table transforms into a fantastic scene filled with curious teacups, playful clocks, vibrant florals, and a touch of magic. From the Mad Hatter's tea party to the Queen of Hearts' it's a celebration of artistry, storytelling, and the joy of stepping through the looking glass! This is a formal affair. No plastic dinnerware or settings. We will provide (1) 30" square cocktail table with a white linen covering draped to the floor. Only room for 6 entries. Etiquette authorities may be resourced as guidelines, but creativity counts! No real food, plants, flowers, balloons or chairs are permitted. Any container used must be clean and empty. Table setting must be completed on ONE DAY ONLY September 1st, 2026 between 4:00-7:00 PM in the Exhibit Hall. One entry per person.

#### PRIZES OFFERED PER CLASS

1st Place	\$30.00
2nd Place	\$20.00

3rd Place	\$10.00
	\$1.00 Entry Fee

#### CLASS 1 "Alice"

### DIVISION 2 "COLLECTIONS"

What is your collection? May it be stamps, keys, marbles, or tickets. This is your chance to show it off. Please bring in on ONE of the two receiving days, August 31st or September 1st, 2026 between 4:00-8:00 PM. Please have your collection fit in a 21"x21" square. One entry per person.

#### PRIZES OFFERED PER CLASS

1st Place	\$30.00
2nd Place	\$20.00
3rd Place	\$10.00

\$1.00 Entry Fee

#### CLASS 1 "My Collection"

### DIVISION 3

#### "WRAPPED IN LOVE"

We are proud to partner with DOORS OF HOPE, a parenting and pregnancy resource center in Madera. Your handmade blanket in "Wrapped in Love" is not only a featured exhibit and competition, but your exhibit will be donated to DOORS OF HOPE at the end of the Fair. Let your love wrap up a baby and family in 2026! Enter a tie blanket, quilt, knitted or crocheted exhibit for display and donation. Minimum size 25"x 30" Maximum size 35"x 40". All entries become property of Madera Fair for distribution to DOORS OF HOPE.

#### PRIZES OFFERED PER CLASS

1st Place	\$15.00
2nd Place	\$10.00
3rd Place	\$5.00

NO Entry Fee

#### CLASS 1 "Wrapped in Love"

# 2026 FEATURED CONTESTS

## PHOTOGRAPHY

### PRIZES OFFERED PER CLASS

Divisions 4 and 5

1st Place	\$10.00
2nd Place	\$7.00
3rd Place	\$5.00

Entry Fees: \$1.00 per entry

### DIVISION 4

#### "ALL AMERICAN PHOTOS"

As we look at celebrating 250 years of great American life, let's showcase the best! Bring in your 8 X 10 photos and let's see the photographer in YOU! Please refer to photography rules.

#### CLASS 1 "All American Life"

### DIVISION 5

#### "FRIENDS"

Let's celebrate you and your friends this year! Share your best photo and show it at the Fair. This can be your best friend or your best friends! Photos must have been taken within the last 12 months. See photography rules.

#### CLASS 1 "Exhibitors 12 and under"

#### CLASS 2 "Exhibitors 13 and up"

## FOOD

Entry Fees: \$2.00 per entry

### SPECIAL FOOD GUIDELINES

1. All food entries must be on disposable plates, pans or containers. NO EXCEPTIONS. Please do not provide audience samples.
2. Your food entry becomes the property of the Madera District Fair. A portion of all entries may be on display for the remainder of the Fair. Foods that are no longer presentable due to spoilage will be disposed of.
3. One entry per class per exhibitor. One free gate admission will be provided for our Special Food Contest Exhibitor (except Thurs, Free Admission to all). Letter of confirmation and instructions will be given.
4. Recipes must be submitted on a white 5"x 8" recipe card. If they are not, be prepared to copy your recipe onto the correct card at receiving. DO NOT put your name on the card. Your exhibit number will be placed on your recipe at receiving. Special Contest recipes may be published.

### DIVISION 6

#### "CHOCOLATE CHIP COOKIE"

THURSDAY, September 10th

Receiving, 6:00-6:45 PM

Judging, 7:00 PM

Contest Sponsored by: THE TIM RICHE FAMILY

1st Place \$75.00

2nd Place \$50.00

3rd Place \$25.00

The Great American Chocolate Chip Cookie Contest has been a dream come true to fair goers. You may have the greatest chocolate chip cookie ever to be entered. This is a popular contest of an old favorite cookie! Please review special food contest note rule # 4. Enter 12 cookies on a disposable plate.

#### CLASS 1 "The Great American Chocolate Chip Cookie"

By popular demand, we are offering a People's Choice Award, voted on by 25 fair guests following the official judging of the Chocolate Chip Cookie Contest in Home Arts.

### DIVISION 7

#### "HOMEMADE FRUIT PIE"

FRIDAY, September 11th

Receiving, 5:00-5:45 PM

Judging, 6:00 PM

Contest Sponsored by: CREATIVE COPY

1st Place \$75.00

2nd Place \$50.00

3rd Place \$25.00

Who makes the best fruit pie in Madera County? This year, we will showcase the famous Fruit pie. May it be an old fashioned pie, or even a new rendition of an old favorite. Who has the best Homemade Fruit Pie? Is it YOU? Please review special contest rules, note rule #4. Enter one pie on a disposable pie plate. Entry becomes property of the Fair.

#### CLASS 1 "Homemade Fruit Pie"

# 2026 FEATURED CONTESTS

## DIVISION 8 "BBQ'D BABY BACK RIBS"

SATURDAY, September 12th  
Receiving, 4:00-4:45 PM  
Judging, 5:00 PM  
Contest Sponsored by: BRIAN'S HEATING  
& COOLING

1st Place \$75.00  
2nd Place \$50.00  
3rd Place \$25.00

Who can resist a savory slab of Baby Back Ribs? Who's got the gusto to de-throne Madera District Fair's BBQ Baby Back Rib CHAMP? Bring a plate of 6 of your best to offer up to our judges. Maybe you can take home the prize and 2026 bragging rights! Sauce or rub em'! We're looking for the BOSS of the BBQ!  
Review special food contest rules, note rule #4.  
Enter (6) Baby Back Ribs.

### CLASS 1 "BBQ'D Baby Back Ribs"

## DIVISION 9 "CUPCAKE WARS"

SATURDAY, September 12th  
Receiving, 5:00-5:45 PM  
Judging, 6:00 PM  
Contest Sponsored by: THE McCANN FAMILY  
IN MEMORY OF T. JEAN BURMER

1st Place \$75.00  
2nd Place \$50.00  
3rd Place \$25.00

In memory of T. Jean Burmer's love for culinary competition, daughter, Chris McCann and family are proud to sponsor the cupcake showdown! Present (6) cupcakes, of any one flavor. Who will hold the title of CUPCAKE CHAMP for Madera Fair's popular CUPCAKE WAR? Review special food contest rules, note rule #4. Live judging: Appearance, Originality and Flavor. Enter (6) Cupcakes.

### CLASS 1 "Cupcakes"

*New!*

## DIVISION 10 "ALL AMERICAN LEMONADE CONTEST"

FRIDAY, September 11th  
Receiving, 6:15-6:45 PM  
Judging, 7:00 PM  
Contest Sponsored by: TACO MAN RESTURANT  
AND CATERING

1st Place \$75.00  
2nd Place \$50.00  
3rd Place \$25.00

Prizes awarded per class.  
No entry fee.

Lemonade who wants lemonade? It all starts there, maybe in the kitchen, at a stand, but with warm summer nights who can't resist that sweet lemonade! From classic sweet to wildly creative blends, all is welcome to give it a whirl. Please no ice, we will provide for judging and no alcohol. Peoples Choice Award TBA after Live Judging. Review special food contest rules, note rule #4. Please bring at least 32 oz. of lemonade in a disposable container.

### CLASS 1 "Lemonade"

## DIVISION 11 "SALSA"

SUNDAY, September 13th  
Receiving, 4:00-4:45 PM  
Judging, 5:00 PM  
Contest Sponsored by: SAL'S MEXICAN RESTURANT  
IN MADERA

1st Place \$75.00  
2nd Place \$50.00  
3rd Place \$25.00

Salsa turns any food into a party! Find the old family recipe or concoct your own masterpiece and bring in some down-home palate pleasin' SALSA! Hot, medium or mild, whatever tickles your fancy. This salsa ain't from New York City! Review special food contest rules, note rule #4.

### CLASS 1 "Salsa"

# 2026 FEATURED CONTESTS



Madera County Cattlewomen  
**COWBELLES**  
**MADERA**  
DISTRICT FAIR

# 2026 FEATURED CONTESTS

## DIVISION 12 "CATTLE COLORING CONTEST"

Contest Sponsored by: MADERA COUNTY  
COWBELLES

1st Place \$15.00  
2nd Place \$10.00  
3rd Place \$ 5.00

Prizes awarded per class.  
No entry fee.

Get your colors ready and fill in a page of history at the 2026 Madera Fair! Students from Pre-K to 4th grades can participate. The coloring page can be found at [maderafair.com](http://maderafair.com) and downloaded, printed, colored and entered!

1. Include exhibitor's full name as listed on entry form on the back of the artwork.
2. Please include grade on the back of the entry form as well.

**CLASS 1** Pre-K and Kinder  
**CLASS 2** 1st and 2nd Grade  
**CLASS 3** 3rd and 4th Grade

## SPECIAL CONTESTS

### PRIZES OFFERED in Division 13 and 14

1st Place	\$10.00
2nd Place	\$7.00
3rd Place	\$5.00

Entry Fees: \$1.00 per entry

## DIVISION 13 "PRIDE OF THE FAMILY"

Do you have a family or friend from out of town that is an aspiring artist? Here is an opportunity to enter THEIR creations. Any drawing, painting, doodling or otherwise must be no larger than 8.5 x 11.

**Please include your name, the artist's name and age on back of the artwork.**

**CLASS 1** Pre-K and Kinder  
**CLASS 2** 1st and 2nd Grade  
**CLASS 3** 3rd and 4th Grade

## DIVISION 14 "IN HONOR OF MY AMERICAN HERO DISPLAY"

Create a meaningful and visually compelling tribute recognizing the courage, sacrifice, and service of military veterans throughout the history of the United States of America. In celebration of 250 years of American freedom, displays should respectfully highlight the legacy of those who have served—from the era of the American Revolutionary War to present-day service members. Entries will be judged on creativity, historical significance, and overall presentation. There will be a 19 X 12 X 9 inches wood crate for your items to be showcased in and on. Each exhibitor needs to bring 1) A photo of your loved one, 2) Share a story that highlights their life, accomplishments, or what made them special. 3) Include an item that holds significance to your loved one (Please note: Do not bring heirlooms or valuable objects, as the exhibit will be open to the public).

**CLASS 1** ADULT: age 19 and older  
**CLASS 2** JUNIOR: age 18 and under

## MADERA FAIR CAMP

FAIR CAMP is in partnership with Madera Unified School District this summer with activities emphasizing the best parts of our annual Fair: Livestock, Exhibits, Food, Entertainment and Fun! FAIR CAMP divisions are ONLY for FAIR CAMP participants.

### DANISH SYSTEM OF JUDGING

Ribbon awards only  
NO ENTRY FEE

## DIVISION 15 "FAIR CAMP"

At our FAIR CAMP EVENTS, you will be introduced to entering a fair entry and becoming an exhibitor. Entries are completed during camp meetings.

**CLASS 1** Campers Craft Project

# 2026 FEATURED CONTESTS

## ADULT LEGO COMPETITION

### PRIZES OFFERED in Division 16

Ribbons will be awarded for 1st through 3rd in each class.

1st Place	\$10.00
2nd Place	\$7.00
3rd Place	\$5.00

Entry Fees: \$1.00 per entry

Here is your chance to show your lego skills. There will be a 19" X 12" X 9" wood crate for your items to be showcased in and on. We will have a unique space made just for you (19 years and older) to showcase your Hometown USA. This could be your home, your street, your favorite store, your park, your restaurant or even your first responder station. This is a limited space exhibit. No kits allowed.

### DIVISION 16 "HOMETOWN USA"

**CLASS 1** My Favorite Place in Town

## DECORATED EGG SHOW

AMERICAN SYSTEM OF JUDGING

RECEIVING on August 31st or September 1st, 2026  
In the Annex

### DIVISION 17 DECORATED EGGS

Open to all Ages, all Exhibitors. Examples of adornment are beads, paper, shells, or plants. Whatever designs chosen, the outline of the egg must be maintained.

**CLASS 1** Painted or Inked

**CLASS 2** Decorated. May also be painted.

### DIVISION 18 ALL AMERICAN FASHION SHOW

Special Ribbons for 1st - 3rd Place

Join us for a fabulous runway event that celebrates style at every stage of life- from pint sized trendsetters to silver haired stunners!

Friday, September 11th @ 7PM on the PATIO STAGE. Register ahead of time online OR even on Patio Stage, right side @ 6:30PM.

Dress Code: The more creative the better. We kindly ask that everyone follow these dress code guidelines:

- No revealing clothing.
- No offensive language, symbols, or imagery on clothing.
- Just be sure your outfit is suitable for a diverse, all-ages audience. Fair management has the right to disqualify contestants for indecent attitude and attire.

**CLASS 1** Little Trend Setters (ages 5-11) Cute, quirky and full of attitude!

**CLASS 2** All ages Runway Stars (ages 12-60) From casual chic to full glam, show us what you've got!

**CLASS 3** Silver Foxes (ages 61+) Grace, glitter and all the grown-up sparkle!

### DIVISION 19 BEARD AND MUSTACHE CONTEST

THURSDAY, September 10th

Receiving, 5:45-6:15 PM

Judging, 6:30 PM

Contest Sponsored by: BIG VALLEY NEWS

1st Place \$75.00

2nd Place \$50.00

3rd Place \$25.00

Prizes awarded per class.

No entry fee.

Do you have your full or partial beard ready to show? Come on out to see where those whiskers rank. You can enter online or at ringside from 5:45-6:15PM.

**CLASS 1** Full Beard

**CLASS 2** Partial Beard

# EXHIBIT HALL DATES & TIMES

## PHOTOGRAPHY, HOME ARTS AND ARTS & CRAFTS

Sandy Vaiarello, Superintendent

SPECIAL FOOD CONTESTS	ENTRY CLOSING	RECEIVING	JUDGING
Great American Chocolate Chip Cookie	Tuesday AUGUST 25th between 4:00-8:00 PM	Thurs. - Sept. 10th 6:00-6:45 PM	Thurs. - Sept. 10th 7:00 PM
Homemade Fruit Pie		Fri. - Sept. 11th 5:00-5:45 PM	Fri. - Sept. 11th 6:00 PM
BBQ Rib Contest		Sat. - Sept. 12th 4:00-4:45 PM	Sat. - Sept. 12th 5:00 PM
CUPCAKE WARS		Sat. - Sept. 12th 5:00-5:45 PM	Sat. - Sept. 12th 6:00 PM
All American Lemonade Contest		Sat.-Sept. 12 <sup>th</sup> 6:15-6:45 PM	Sat.-Sept. 12 <sup>th</sup> 7:00 PM
SALSA		Sun. - Sept. 13th 4:00-4:45 PM	Sun. - Sept. 13 <sup>th</sup> 5:00 PM

## FOOD, ARTS & CRAFT CONTESTS HELD DURING FAIR HOURS

**ENTRY FORM CLOSING, EXHIBIT RECEIVING & CLAIMING DATES FOR:  
PHOTOGRAPHY, CLOTHING AND TEXTILES, QUILTING, CREATIVE DECORATING, HOME CRAFTS, FINE ARTS,  
PAINTING AND DRAWING, WOODWORKING, YOUTH & ADULT PRESERVED FOODS  
and NON-FOOD FEATURED CONTESTS.**

**\*\*This includes Youth, Adult, Challenged or Assisted and Classroom Projects\*\***

**ENTRY CLOSING:** Tuesday, August 25th, by 8:00 PM

**FINAL RECEIVING** - August 31st or September 1st from 4:00 to 8:00 PM

**CLAIMING:** Tuesday, September 15th, from 4:00 PM to 8:00 PM

**ENTRY FORM CLOSING, EXHIBIT RECEIVING & CLAIMING DATES FOR:**

### AGRICULTURAL MECHANICS

**ENTRY CLOSING:** Tuesday, August 25th, by 8:00 PM

**RECEIVING:** August 31st or September 1st from 4:00 to 8:00 PM

**CLAIMING:** Tuesday, September 15th, from 4:00 PM to 8:00 PM

**ENTRY FORM CLOSING, EXHIBIT RECEIVING & CLAIMING DATES FOR:**

### YOUTH, ADULT, CHALLENGED OR ASSISTED BAKING AND CONFECTIONS

**ENTRY CLOSING:** Tuesday, August 25th, by 8:00 PM

**RECEIVING:** Tuesday, September 8th, from 4:00 PM to 8:00 PM

**CLAIMING:** Tuesday, September 15th, from 4:00 PM to 8:00 PM

# CLOTHING and TEXTILE

One Best of Division Ribbon will be awarded in each Division with one Best of Show selected from the Division winners. American System of Judging. Please read general rules on page 8 and the guidelines below.

## GUIDELINES

1. All entries must have been made or completed by the exhibitor within the last 24 months.

### PRIZES OFFERED PER CLASS

applies to Div. 50-53

1st Place	\$5.00
2nd Place	\$3.00
3rd Place	\$2.00

Entry Fees: \$1.00 per entry per class

### THIS IS HOW YOU DO IT!

1. Decide what division(s) and class(es) you are entering.
2. Visit [maderafair.com/entry](http://maderafair.com/entry) to create a username to enter online. ONLINE STILL and FLORICULTURE entries are FREE until August 1st, 2026.
3. Submit online entry on or before August 25th, 2026, pay applicable entry fees.
4. Bring Exhibit on FINAL receiving days, Aug. 31st or September 1st, 2026. Unless specific contest states otherwise.

## DIVISION 50 CROCHET

- CLASS 1** Afghans, Blankets  
**CLASS 2** Clothing  
**CLASS 3** Accessories  
**CLASS 4** Any other not listed, specify

## DIVISION 51 KNITTING

- CLASS 1** Afghans, Blankets  
**CLASS 2** Clothing  
**CLASS 3** Accessories  
**CLASS 4** Any other not listed, specify

## DIVISION 52 NEEDLEWORK

**CLASS 1** Any other, specify

## DIVISION 53 GENERAL SEWING & TEXTILE WORK

**CLASS 1** Any other, specify

*Free Online Entries*  
**STILL and FLORICULTURE**  
**until August 1st, 2026!**



# FINE ARTS

One Best of Division Ribbon will be awarded in each Division #54-68, with one Best of Show being awarded to each skill level. American System of Judging. Please read general rules on page 8 and the guidelines below.

## FINE ART GUIDELINES

1. All fine art entries must be ready to hang with wire and eye hangers securely attached, even on canvas. No sawtooth hangers. Frames and canvas pieces, regardless of size, without wire and eye hangers will not be accepted. No exceptions.
2. All entries must be originals and not stamped patterns or copies. Work must have been done by the exhibitor.
3. Any photo may be entered as long as it has never won an award at Madera District Fair.
3. No pictures over 48" in any direction, this includes frame and matting. Images under glass are acceptable.

### DIV. 54-63 PRIZES OFFERED PER CLASS

1st Place	\$5.00
2nd Place	\$3.00
3rd Place	\$2.00

Entry Fees: \$1.00 per entry per class

### DIV. 64-68 PRIZES OFFERED PER CLASS

1st Place	\$10.00
2nd Place	\$7.00
3rd Place	\$5.00

Entry Fees: \$1.00 per entry per class

### THIS IS HOW YOU DO IT!

1. Decide what division(s) and class(es) you are entering.
2. Visit [maderafair.com/entry](http://maderafair.com/entry) to create a username to enter online. ONLINE STILL and FLORICULTURE entries are FREE until August 1st, 2026.
3. Submit online entry on or before August 25th, 2026, pay applicable entry fees.
4. Bring Exhibit on FINAL receiving days, August 31st or September 1st, 2026. Unless specific contest states otherwise.

Determine your SKILL LEVEL based on your experience.

**Beginner** = Exhibitor with two years or less experience in the division.

**Intermediate** = Exhibitor who has two or more years experience in the division.

**Advanced/Pro** = Exhibitor who has achieved a marked degree of expertise in the division and/or has sold or made money from their work.

## CHOOSE DIVISION FINE ART

**DIVISION 54** BEGINNER Oil or Acrylic

**DIVISION 55** BEGINNER Charcoal, Pastels, Conte, Crayon

**DIVISION 56** BEGINNER Water Color

**DIVISION 57** BEGINNER Pen & Ink or Pencil

**DIVISION 58** BEGINNER Any other, specify

**DIVISION 59** INTERMEDIATE Oil or Acrylic

**DIVISION 60** INTERMEDIATE Charcoal, Pastels, Conte Crayon

**DIVISION 61** INTERMEDIATE Water Color

**DIVISION 62** INTERMEDIATE Pen & Ink, Pencil

**DIVISION 63** INTERMEDIATE Any other, specify

**DIVISION 64** ADVANCED/PRO Oil or Acrylic

**DIVISION 65** ADVANCED/PRO Charcoal, Pastels, Conte Crayon

**DIVISION 66** ADVANCED/PRO Water Color

**DIVISION 67** ADVANCED/PRO Pen & Ink, Pencil

**DIVISION 68** ADVANCED/PRO Any other, specify

**CLASS 1** Animal, Bird

**CLASS 2** Architecture

**CLASS 3** Floral, Still Life

**CLASS 4** Landscape, Seascape

**CLASS 5** Portrait

**CLASS 6** Any other, specify

# FOOD-BAKING & CONFECTIONS

One Best of Division Ribbon will be awarded in each Division with one Best of Show being chosen from division winners in Baking & Confections. American System of Judging. Please read general rules on page 8 and Baking & Confection rules below.

## BAKING AND CONFECTION GUIDELINES

1. Your recipe must be submitted with each entry. Please clearly print or type the recipe on one side of a white 5"x 8" recipe card. On the back of the card please print the exhibitor's name, division and class.
2. All entries must be made from scratch and entered on a disposable plate or container in a zip lock bag. Entries will not be returned.
3. Enter one whole loaf or 7 muffins or rolls.
4. Enter one whole pie in a disposable pie pan.
5. Enter one whole cake on a disposable plate. No cupcakes.
6. Enter 7 pieces of confections.
7. Enter 7 cookies.
8. Enter two cups trail mix in a disposable container or zip lock bag.
9. Enter 7 pieces of dehydrated foods in a snack-size zip lock bag.

### PRIZES OFFERED PER CLASS

1st Place	\$5.00
2nd Place	\$3.00
3rd Place	\$2.00

Entry Fees: \$1.00 per entry per class

### THIS IS HOW YOU DO IT!

1. Decide what division(s) and class(es) you are entering.
2. Visit [maderafair.com/entry](http://maderafair.com/entry) to create a username to enter online. ONLINE STILL and FLORICULTURE entries are FREE until August 1st, 2026.
3. Submit online entry on or before August 25th, 2026, pay entry fees. Entry fees, if applicable can be found in each Division.
4. Bring Exhibit on TUESDAY, Sept. 8th, 2026 from 4-8PM. Unless specific contest states otherwise. For special food contests, see pg. 16 for receiving date and time.

## DIVISION 69 BREAD

- CLASS 1 Bread-Machine Made
- CLASS 2 Muffins, specify
- CLASS 3 Quick Breads, fruit or vegetable
- CLASS 4 Quick Breads, nut or grain
- CLASS 5 Yeast Breads or Rolls
- CLASS 6 Any other, specify

## DIVISION 70 PIE

- CLASS 1 Berry
- CLASS 2 Fruit Other Than Berry
- CLASS 3 Nut
- CLASS 4 Refrigerated (Cream or Custard)
- CLASS 5 Any other, specify

## DIVISION 71 COBBLER

- CLASS 1 Berry
- CLASS 2 Fruit Other Than Berry

## DIVISION 72 CHEESECAKE

- CLASS 1 Any type, specify

## DIVISION 73 CAKE

- CLASS 1 Bundt cake
- CLASS 2 Layer cake
- CLASS 3 Pound or Loaf cake
- CLASS 4 Any other, specify

# FOOD-CONFECTIONS & PRESERVES

## DIVISION 74 CONFECTIONS

- CLASS 1** Fudge
- CLASS 2** Nut Brittle, Toffee
- CLASS 3** Any other, specify

## DIVISION 75 COOKIES

- CLASS 1** Bar Cookies
- CLASS 2** Drop Cookies
- CLASS 3** Molded Cookies
- CLASS 4** Any other, specify

## DIVISION 76 GLUTEN FREE

- CLASS 1** Bread
- CLASS 2** Cake
- CLASS 3** Cookies
- CLASS 4** Any other, specify

## PRESERVED FOOD GUIDELINES

1. All entries must be labeled with the following: product name, processing method and length of processing time. All entries must have been prepared and canned within the last year and include the date of preparation.
2. Two standard jars, specifically for canning purposes, same size and shape are required for each entry. All jars must be thoroughly cleaned. They must have clean, standard canning lids, sealed tightly, with loosened rings. Please no rusty rings and no paraffin seals.
3. One container will be opened for judging. The other container will remain on display for duration of the fair. The opened jar may be picked up the day after judging.
4. Enter 7 pieces of dehydrated foods in a snack size zip lock bag.
5. \*\*\*NOTE\*\*\* If you are entering as an organized youth participant, please include your age, grade and club information including your leader's phone number.

### PRIZES OFFERED PER CLASS

1st Place	\$5.00
2nd Place	\$3.00
3rd Place	\$2.00

Entry Fees: \$1.00 per entry per class

## DIVISION 77 CANNED FRUITS & VEGGIES

- CLASS 1** Apples, Applesauce
- CLASS 2** Apricots, Peaches
- CLASS 3** Pears
- CLASS 4** Any other fruit, specify
- CLASS 5** Corn
- CLASS 6** Beans (any)
- CLASS 7** Tomatoes
- CLASS 8** Any other vegetable, specify

## DIVISION 78 PICKLES, RELISH, SAUCES

- CLASS 1** Pickles, Cucumber
- CLASS 2** Pickles, other
- CLASS 3** Relishes
- CLASS 4** Any other, specify

## DIVISION 79 JAMS, JELLIES & SPREADS

- CLASS 1** Apricot, Peach
- CLASS 2** Berry, other
- CLASS 3** Strawberry
- CLASS 4** Vegetable, Pepper
- CLASS 5** Butters
- CLASS 6** Marmalade
- CLASS 7** Preserves
- CLASS 8** Any other, specify

## DIVISION 80 DRIED FOODS

- CLASS 1** Fruit
- CLASS 2** Jerky
- CLASS 3** Vegetable
- CLASS 4** Trail Mix
- CLASS 5** Any other, specify

# HOBBIES & CRAFTS

One Best of Division Ribbon will be awarded in each Division with one Best of Show being awarded overall in Hobbies & Crafts from each Division winner. American System of Judging. Please read general rules on page 8 and the guidelines below.

## GUIDELINES

1. All entries must have been made or completed by the exhibitor within the last 24 months.

### THIS IS HOW YOU DO IT!

1. Decide what division(s) and class(es) you are entering.
2. Visit [maderafair.com/entry](http://maderafair.com/entry) to create a username to enter online. ONLINE STILL and FLORICULTURE entries are FREE until August 1st, 2026.
3. Submit online entry on or before August 25th, 2026, pay applicable entry fees.
4. Bring Exhibit on FINAL receiving days, August 31st or September 1st 2026. Unless specific contest states otherwise.

### PRIZES OFFERED PER CLASS applies to Div. 81-84

1st Place	\$5.00
2nd Place	\$3.00
3rd Place	\$2.00

Entry Fees: \$1.00 per entry

**Beginner** = Exhibitor who has two years or less experience in the division.

**Intermediate and Advanced** = Exhibitor who has two or more years experience in the division.

## CHOOSE DIVISION- CRAFTS

**Division 81 BEGINNER-Adult Crafts**

**Division 82 INTERMEDIATE and ADVANCED-Adult Crafts**

- CLASS 1** Center Piece, Table Decoration
- CLASS 2** Shadowbox
- CLASS 3** Wall Hanging, any medium
- CLASS 4** Ornament, any
- CLASS 5** Pillow, Table Runner
- CLASS 6** Christmas (i.e. tree skirt, stocking, etc)
- CLASS 7** Sculpture- Clay, Pottery
- CLASS 8** Sculpture - Metal
- CLASS 9** Woodcarving, Woodwork (Kit, Beginner or Intermediate only)

**CLASS 10** Woodcarving, Woodworking

**CLASS 11** Jewelry

**CLASS 12** Toile and Decorative painting, any medium

**CLASS 13** Scrap Booking (1-2 page spread)

**CLASS 14** Any other not listed, specify

## DIVISION 83 "THE SIGN SAYS..."

### ALL SKILL LEVELS

Grab a piece of wood, chalkboard or other wooden pieces and create a saying or notion. Size not to exceed 12"x 24".

**CLASS 1** Custom Sign Work

## DIVISION 84 "THRIFT FLIPS"

### ALL SKILL LEVELS

Have you ever seen an up-cycled quilt, or a re-purposed household item? How about a flea market or thrift store find that can be used again in a different way? Let your imagination run wild and utilize your eco-friendly skills.

### PRIZES OFFERED PER CLASS

1st Place	\$15.00
2nd Place	\$10.00
3rd Place	\$7.00

Entry Fees: \$1.00 per entry per class

**CLASS 1** Up-cycled Outfit or Textile

**CLASS 2** Refurbished Household Item

**CLASS 3** Any other not listed, specify

# PHOTOGRAPHY

Go for it! Let your photo do the talkin'! One Best of Division Ribbon will be awarded in each Division with one Best of Show selected from the Division winners. American System of Judging. Please read general rules on page 8 and the photography rules below.

## PHOTOGRAPHY GUIDELINES

1. Two entries per class per person may be entered.
2. Any photo may be entered as long as it has never won an award at Madera District Fair.
3. Black & White prints may be entered in any class. However, for judging on Black & White technique, it must be entered in Black & White class # within your Division.
4. All photos must be taken by exhibitor. However, they may be developed, printed and/or mounted by a professional.
5. Please provide an 8"x 10" for Beginner or Intermediate exhibitors mount on a SINGLE mat (WHITE MAT PREFERRED). AdvancedPro may use the 8"x 12" print and mount on a SINGLE mat w/ color of choice. Single mat with finished size of 11x14. Double or Triple mats may be disqualified.
6. We suggest glue dots or a strong adhesive when mounting your print.
- 7 All prints must include an adhesive hanger centered on the back and flush with the top edge. Hangers are available at the Fair Office or on receiving day free of charge.
8. All prints must be clearly marked with the exhibitors name, address, division, class and title on the back of the mat or mount.

## PRIZES OFFERED PER CLASS

1st Place	\$6.00
2nd Place	\$4.00
3rd Place	\$2.00

Entry Fees: \$1.00 per entry per class

## THIS IS HOW YOU DO IT!

1. Decide what division(s) and class(es) you are entering.
2. Visit [maderafair.com/entry](http://maderafair.com/entry) to create a username to enter online. ONLINE STILL and FLORICULTURE entries are FREE until August 1st, 2026.
3. Submit online entry on or before August 25th, 2026, pay applicable entry fees.
4. Bring Exhibit on FINAL receiving days, Aug. 31st or September 1st, 2026. Unless specific contest states otherwise.

Determine your **SKILL LEVEL** based on your experience in competing with your photography print(s). You'll choose the DIVISION accordingly.

**Beginner** = Exhibitor who has two years or less experience in the division.

**Intermediate** = Exhibitor who has two or more years experience in the division.

**Advanced/Pro** = Exhibitor who has achieved a marked degree of expertise in the division or has sold or made money from their work.

## CHOOSE DIVISION- PRINTS

<b>DIVISION 85</b>	BEGINNER-Prints
<b>DIVISION 86</b>	INTERMEDIATE-Prints
<b>DIVISION 87</b>	ADVANCED/PRO-Prints

What/Who is the subject of your print? If a class does not reflect your subject, choose CLASS 18, "Any other subject" not listed, specify.

<b>CLASS 1</b>	Abstract, Patterns, Shadows
<b>CLASS 2</b>	Action, Sports
<b>CLASS 3</b>	Agriculture
<b>CLASS 4</b>	Animals, Pets
<b>CLASS 5</b>	Architectural, Buildings
<b>CLASS 6</b>	Birds, Fowl
<b>CLASS 7</b>	Bridges, Fences
<b>CLASS 8</b>	Children
<b>CLASS 9</b>	Flowers, Plants
<b>CLASS 10</b>	Landscape, Trees
<b>CLASS 11</b>	Night Photo
<b>CLASS 12</b>	People
<b>CLASS 13</b>	Seasons
<b>CLASS 14</b>	Still Life
<b>CLASS 15</b>	Sky: Clouds, Sunrise, Sunset
<b>CLASS 16</b>	Water: Ocean, Marine, Lake
<b>CLASS 17</b>	Black & White Technique, any subject
<b>CLASS 18</b>	Any other subject not listed, specify

# PHOTOGRAPHY

How to mount your photo entry.

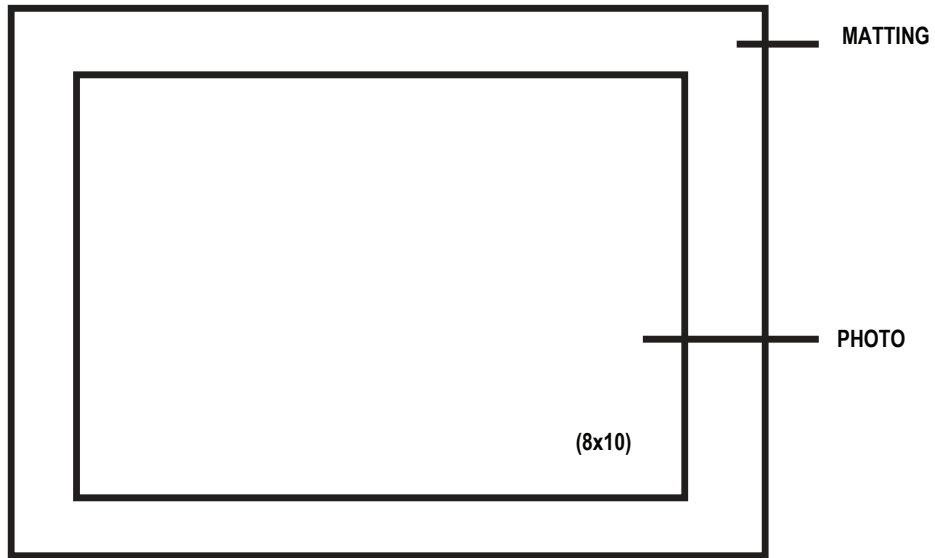

FRONT

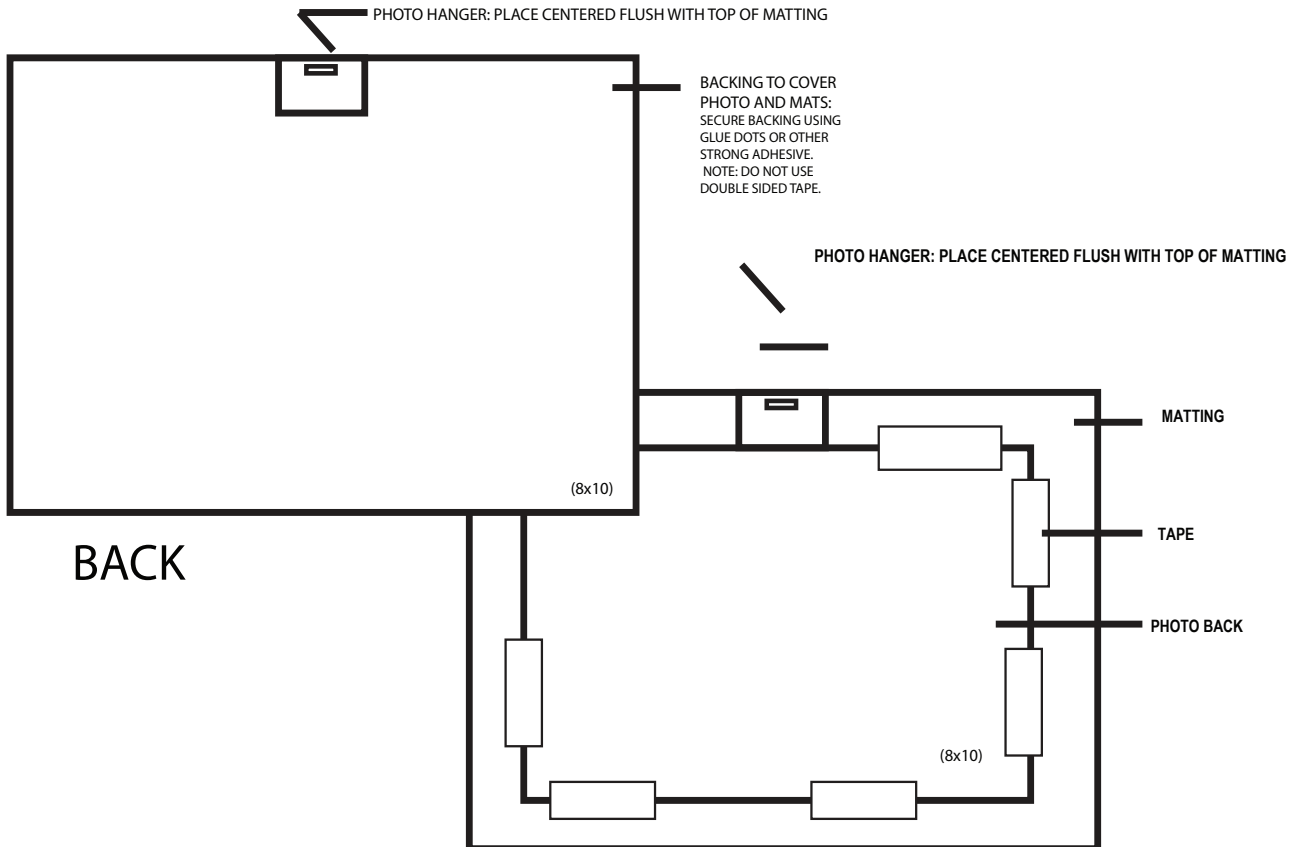

BACK

# QUILTING

One Best of Division Ribbon will be awarded in each Division with one Best of Show being awarded to each skill level. American System Judging. Please read general rules on page 8 and the quilting rules below.

## QUILTING GUIDELINES

1. Quilts will not be accepted without a 4" sleeve to accommodate a pole for displaying. Sleeve directions: Prepare a strip of fabric 9" wide by width of your quilt; this strip may be pieced if necessary. Fold in half RST to form a long tube. Stitch a lengthwise 1/2" seam. Hem the sleeve ends 1". Turn the sleeve right side out. Position the sleeve, seam side down, on the back of the quilt, 1" below the top edge and 1" in from both sides. Baste or blind stitch sleeve into place, along BOTH folded edges, not sewing through the front.
2. All entries must have been made or completed by the exhibitor within the last 24 months.
3. KIT, defined as "ready to assemble".

### THIS IS HOW YOU DO IT!

1. Decide what division(s) and class(es) you are entering.
2. Visit [maderafair.com/entry](http://maderafair.com/entry) to create a username to enter online. ONLINE STILL and FLORICULTURE entries are FREE until August 1st, 2025
3. Submit online entry OR paper entry on or before August 25th, 2026, pay applicable entry fees.
4. Bring Exhibit on FINAL receiving days, Aug. 31st or September 1st, 2026. Unless specific contest states otherwise.

**\*My First Quilt "Class 1" in each Division:** Exhibitor who has made their first quilt and wants to enter with other beginners.

### PRIZES OFFERED PER CLASS

1st Place	\$5.00
2nd Place	\$3.00
3rd Place	\$2.00

Entry Fees: \$1.00 per entry per class

## CHOOSE DIVISION QUILTING

### DIVISION 88 QUILTS up to 48" -Width/Length

- \*CLASS 1 My First Quilt- Any Style
- CLASS 2 Patchwork/Pieced Quilt
- CLASS 3 Applique (Stitched Quilt)
- CLASS 4 Embroidery or Cross Stitch
- CLASS 5 Art or Crazy Quilt (Original Design)
- CLASS 6 TOP by Exhibitor, professional quilted
- CLASS 7 Any other not listed, specify

### DIVISION 89 QUILTS 49"- 74" -Width/Length

- \*CLASS 1 My First Quilt- Any Style
- CLASS 2 Patchwork/Pieced Quilt
- CLASS 3 Applique (Stitched Quilt)
- CLASS 4 Embroidery or Cross Stitch
- CLASS 5 Art or Crazy Quilt (Original Design)
- CLASS 6 TOP by Exhibitor, professional quilted
- CLASS 7 Any other not listed, specify

### DIVISION 90 QUILTS 74" & ABOVE -Width-Length

- \*CLASS 1 My First Quilt- Any Style
- CLASS 2 Patchwork/Pieced Quilt
- CLASS 3 Applique (Stitched Quilt)
- CLASS 4 Embroidery or Cross Stitch
- CLASS 5 Art or Crazy Quilt (Original Design)
- CLASS 6 TOP by Exhibitor, professional quilted
- CLASS 7 Any other not listed, specify

# UNIQUELY CHALLENGED OR ASSISTED

American System of Judging. Please read general rules on page 8 and guidelines below.

## GUIDELINES

Uniquely Challenged or Assisted is for persons with learning disabilities, developmental or physical disabilities and enrolled in a group facility or adult day program such as, but not limited to: Heartland, CIWP, Star Center, ATP, etc... Exhibitors meeting these qualifications are not limited to this section. You are encouraged to participate in the entirety of the Handbook at your will! Only (2) entries per class per exhibitor in this department.

### THIS IS HOW YOU DO IT!

1. Decide what division(s) and class(es) you are entering.
2. Visit [maderafair.com/entry](http://maderafair.com/entry) to create a username to enter online. ONLINE STILL and FLORICULTURE entries are FREE until August 1st, 2026.
3. Submit online entry OR paper entry form on or before August 25th, 2026, pay applicable entry fees.
4. Bring Exhibit on FINAL receiving days, August 31st or September 1st, 2026. Unless specific contest states otherwise.

### PRIZES OFFERED PER CLASS in DIVs. 91-95.

1st Place	\$5.00
2nd Place	\$3.00
3rd Place	\$2.00

**NO Entry Fees**

## DIVISION 91 CRAFTS

- CLASS 1** Beads, Jewelry
- CLASS 2** Ceramics, Clay
- CLASS 3** Knitting, Crocheting, Sewing
- CLASS 4** Wood
- CLASS 5** Any other, specify

## DIVISION 92 PAINTING & DRAWING

Artwork cannot exceed 12"x 18"

- CLASS 1** Markers, Crayons and/or Colored Pencils
- CLASS 2** Paint by Number
- CLASS 3** Tempera Paints
- CLASS 4** Watercolor
- CLASS 5** Any other, specify

## DIVISION 93 BAKING

1. (7) muffins, cookies or bar cookies to be entered.
2. Include 5"x 8" recipe card.
3. Food items received on Tuesday, September, 8th.

- CLASS 1** Cookies, Bar Cookies
- CLASS 2** Any other, specify

## DIVISION 94 PHOTOGRAPHY

Photos may be 5"x 7" or 8"x 10". Prints must be SINGLE, white matted see page. 23. NO frames. NO glass.

- CLASS 1** People, Portraits, Animals, Birds
- CLASS 2** Any other not listed, specify

## DIVISION 95 FLORICULTURE-GARDENING

A dish garden is a container in which (3) different plants are rooted and growing. see pg. 33 for floriculture receiving date(s).

- CLASS 1** Dish Garden

# YOUTH CONTESTS

## CLASSROOM GUIDELINES

No entry fees - Ribbon Award only  
DANISH SYSTEM OF JUDGING

1. Classroom projects are for TEACHERS ONLY entering for each student in their classroom, either as individuals or one entry created by many. Each student will receive a ribbon for his/her accomplishment.
2. **DIV. 96 and 97 MUST have student's full name, school, grade and teacher's name labeled on the FRONT of each child's entry. EXHIBITS MAY NOT BE RECEIVED IF THIS STEP IS NOT COMPLETED. THIS IS THE ONLY IDENTIFYING ELEMENT on students work.**
3. Include a legible classroom list with each child's name recorded as it appears on the FRONT of their entry. If you choose to photocopy your roll sheet, please clearly note any name changes so that the names will match the names on the front of each child's entry.
4. All work must have been done by Madera County students within the last 12 months.
5. Maximum 2 entries per student may be entered in Div. 96. Artwork should not exceed 12"x 18".
6. Maximum 1 entry per classroom may be entered in Div. 97. Artwork should not exceed 36"x 48".

**Exhibits Due: TUES. SEPTEMBER by 8 PM**

## CHOOSE DIVISION- CLASSROOM PROJECT

Madera Fair is excited that you can celebrate your "ALL AMERICAN PARTY" projects with us! You are welcome to incorporate this idea OR enter any wonderful artwork your students create! ALL classroom projects are welcome. Use one or many forms of media, the sky's the limit.

**DIVISION 96** Same project, Individually Created

**DIVISION 97** 2-D item/exhibit created by many

- CLASS 1** Pre-School - Kinder
- CLASS 2** Grade 1-3
- CLASS 3** Grade 4-6
- CLASS 4** Grade 7-8
- CLASS 5** Grade 9-12
- CLASS 6** SPED Classes

## GENERAL YOUTH GUIDELINES

1. The American and Danish System of Judging will be used.
2. All food entries must be on a disposable plates, pans or containers. NO EXCEPTIONS.
3. Your entry becomes the property of the Madera District Fair. A portion of all entries may be on display for the remainder of the Fair. Foods that are no longer presentable due to spoilage will be disposed.
4. One entry per class per exhibitor.
5. Recipes must be submitted on a white 5"x 8" recipe card. If they are not, be prepared to copy your recipe onto the correct card at receiving. DO NOT put your name on the card. Your exhibit number will be placed on your recipe at receiving. Special contest recipes may be published.
6. Exhibitors 18 years of age and under may enter any FEATURED CONTEST (as an adult) if there is not a comparable one in the Youth Division.

SEE Page 16 for EXHIBIT DATES AND TIMES

### THIS IS HOW YOU DO IT!

1. **Decide what division(s) and class(es) you are entering.**
2. **Visit [maderafair.com/entry](http://maderafair.com/entry) to create a user-name to enter online. ONLINE STILL and FLORICULTURE entries are FREE until August 1st, 2026.**
3. **Submit online entry on or before August 25th, 2026, pay applicable entry fees.**
4. **Bring Exhibit on FINAL receiving days, Aug.31st or Sept. 1st, 2026. Unless specific contest states otherwise.**

## JOB WELL DONE

Madera District Fair wants to honor the teachers hard work for their excellence, participation, originality, innovation and completion of a job well done. One teacher will be awarded \$250.00 for Division 96 or 97.

# YOUTH CONTESTS

## HOBBY, CRAFT, PAINTING & DRAWING GUIDELINES

1. Exhibitors limited to (2) entries per class.
2. All entries must have been made or completed by the exhibitor within the last 12 months.
3. Include exhibitor's full name as listed on entry form on the back of the artwork.
4. Please note age and grade on entry form.
5. Construction paper matting on paintings and drawings is encouraged. Total size of artwork not to exceed 12"x 18".
6. Large structures must be secured on a surface that can be easily moved. Mounting boards are not to exceed 18"x 18".
7. \*\*\*NOTE\*\*\* If you are entering as an organized youth participant, please include your age, grade, and club information including your leader's phone number during entry.

### AMERICAN SYSTEM OF JUDGING

One Best of Division Ribbon will be awarded in DIV. 98 & 99

### PRIZES OFFERED PER CLASS

1st Place	\$7.00
2nd Place	\$5.00
3rd Place	\$3.00

NO Entry Fees

## DIVISION 98 "HOMETOWN USA in LEGO"

Have you ever wanted to create your own Hometown USA? Now is your chance to design your home, market, park, or even a fire station. Let's show off your building skills using your favorite LEGO. Make sure not to exceed 12" in any one direction. Entry must be one unit. KRAGLE or NOT TO KRAGLE is up to you. WINNER receives a LEGO set. 1 prize per class.

- CLASS 1** Grade K-3 or Ages 5-8  
**CLASS 2** Grade 4-6 or Ages 9-12  
**CLASS 3** Grade 7-12 or Ages 13-18

## DIVISION 99 "HIP, HIP HOORAY FOR THE USA"

Pennants are a sign of support, celebration and pride. Let us display your spirit of America. Pennant can be crafted out of any media. Not longer than 18" or wider than 10". Finished pennants will be hung in a banner display.

- CLASS 1** Grade K-3 or Ages 5-8  
**CLASS 2** Grade 4-6 or Ages 9-12  
**CLASS 3** Grade 7-12 or Ages 13-18

## Pre-School and Elementary HOBBY, CRAFT, PAINTING & DRAWING

### DANISH SYSTEM OF JUDGING

NO entry fees  
Ribbon only

- DIVISION 100** Preschool-K  
**DIVISION 101** Grade 1-3  
**DIVISION 102** Grade 4-6

- CLASS 1** Ceramics, Pottery  
**CLASS 2** Finger Painting  
**CLASS 3** Pinewood Derby  
**CLASS 4** Jewelry, Beading  
**CLASS 5** Woodburning  
**CLASS 6** Model, Kit  
**CLASS 7** Mosaic, Collage  
**CLASS 8** Sewing-Craft  
**CLASS 9** Acrylic, Oil Paint  
**CLASS 10** Color Crayon  
**CLASS 11** Charcoal, Chalk  
**CLASS 12** Markers  
**CLASS 13** Pencil, Colored Pencil  
**CLASS 14** Tempera Paint  
**CLASS 15** Watercolor  
**CLASS 16** Any other, specify

# YOUTH CONTESTS

## AMERICAN SYSTEM OF JUDGING

One Best of Division Ribbon will be awarded  
DIV. 103-114

### PRIZES OFFERED PER CLASS

1st Place	\$3.00
2nd Place	\$2.00
3rd Place	\$1.00

NO Entry Fees

## JR HIGH & HIGH SCHOOL HOBBY and CRAFT

**DIVISION 103** Grade 7-8 Hobby & Craft  
**DIVISION 104** Grade 9-12 Hobby & Craft

- CLASS 1** Clay, Ceramics, Pottery
- CLASS 2** Collage, Mosaic
- CLASS 3** Jewelry, Beading
- CLASS 4** Leather Work
- CLASS 5** Small tems, Tool Box, Stool, etc.
- CLASS 6** Papier Mache'
- CLASS 7** Sewing
- CLASS 8** Scrap Booking (3 pgs)
- CLASS 9** Sculpture
- CLASS 10** Carved Items, Pens
- CLASS 11** Any other, specify

## JR HIGH & HIGH SCHOOL PAINTING and DRAWING

- DIVISION 105** Grade 7-8 Oil & Acrylic
- DIVISION 106** Grade 7-8 Charcoal, Pastels, Conte Crayon
- DIVISION 107** Grade 7-8 Watercolor
- DIVISION 108** Grade 7-8 Pen & Ink or Pencil
- DIVISION 109** Grade 7-8 Any other, specify
- DIVISION 110** Grade 9-12 Oil & Acrylic
- DIVISION 111** Grade 9-12 Charcoal, Pastels, Conte Crayon
- DIVISION 112** Grade 9-12 Watercolor
- DIVISION 113** Grade 9-12 Pen & Ink /Pencil
- DIVISION 114** Grade 9-12 Any other, specify
- CLASS 1** Abstract
- CLASS 2** Animal, Bird
- CLASS 3** Floral, Still Life
- CLASS 4** Landscape, Seascape

- CLASS 5** Portrait, People
- CLASS 6** Any other, specify

## PHOTOGRAPHY GUIDELINES

- Youth prints are 5"x 7" only. SINGLE, white matted with finished size 8x10.
- All prints must include an adhesive hanger centered on the back and flush with the top edge. Madera Fair can provide free of charge.
- Two entries per class per person may be entered.
- Please read general rules on pg. 8 and photography rules on pg. 9.
- Black & White prints may be entered in any class. However, for judging on Black & White technique, it must be entered in Black & White class # within your Division.  
\*\*\*NOTE\*\*\* If you are entering as an organized youth participant, please include your age, grade, and club information including your leader's phone number during entry.

## AMERICAN SYSTEM OF JUDGING

One Best of Division Ribbon will be awarded in each  
Division

### PRIZES OFFERED PER CLASS

1st Place	\$3.00
2nd Place	\$2.00
3rd Place	\$1.00

## CHOOSE DIVISION- PRINTS

- DIVISION 115** Prints-Grade K-3
- DIVISION 116** Prints-Grade 4-6
- DIVISION 117** Prints-Grade 7-12
- CLASS 1** Animals, Birds
- CLASS 2** Digital Manipulation
- CLASS 3** Mother Nature
- CLASS 4** People, Portrait
- CLASS 5** FAIR
- CLASS 6** Water Play
- CLASS 7** Black & White Technique, any subject
- CLASS 8** Photo Shopped
- CLASS 9** Any subject not listed, specify

# YOUTH CONTESTS

## SEWING & NEEDLEWORK GUIDELINES

1. **\*\*\*NOTE\*\*\*** If you are entering as an organized youth participant, please include your age, grade, and club information including your leader's phone number during entry.
2. All entries must have been made or completed by the exhibitor within the last 24 months.
3. Please read general rules on pg. 8.

### AMERICAN SYSTEM OF JUDGING

One Best of Division Ribbon will be awarded in each Division

#### PRIZES OFFERED PER CLASS

1st Place	\$3.00
2nd Place	\$2.00
3rd Place	\$1.00

## CHOOSE DIVISION- SEWING/NEEDLEWORK

**DIVISION 118** Grade K-6th

**DIVISION 119** Grade 7-12th

- CLASS 1** Embroidery, Latch Work  
**CLASS 2** Knitting, Crocheting  
**CLASS 3** Sewing Garment, specify  
**CLASS 4** Sewing, Large Item (quilt, wall hanging)  
**CLASS 5** Sewing, Small Item (tote bag, pillow)  
**CLASS 6** Any other, specify

## BAKING & CONFECTION GUIDELINES

1. Your recipe must be submitted with each entry. Please clearly print or type the recipe on one side of a white 5"x 8" recipe card. On the back of the card please print the exhibitor's name, division and class.
2. All entries must be made from scratch and entered on a disposable plate or container in a zip lock bag. Entries will not be returned.
3. Enter one whole loaf or 7 muffins or rolls.
4. Enter whole cake on a disposable plate or (7) cupcakes.
5. Enter 7 pieces of candy.
6. Enter 7 cookies.
7. A total of 2 entries per class.
8. Please bring items on Sept. 8th from 4-8pm.

**\*\*\*NOTE\*\*\*** If you are entering as an organized youth participant, please include your age, grade, and club information including your leader's phone number during entry.

### AMERICAN SYSTEM OF JUDGING

One Best of Division Ribbon will be awarded in each Division

### BAKING & CONFECTION SWEEPSTAKES AWARD Sponsored by Randy & Sheryl Berry

\$25.00 will be awarded to the top points receiver in Junior Baking and Confections. All junior exhibitors, entering independently or with an organized youth group are eligible for this award. (Divisions 120 -127) The sweepstakes point system is scored as follows: First Place = 3 points, Second Place = 2 points, and Third Place = 1 point. The junior exhibitor with the highest accumulated score will be awarded the sweepstakes.

#### PRIZES OFFERED PER CLASS

1st Place	\$3.00
2nd Place	\$2.00
3rd Place	\$1.00

NO Entry Fees

## CHOOSE DIVISION

**DIVISION 120** Grade K-6

**DIVISION 121** Grade 7-12

- CLASS 1** Bundt Cake  
**CLASS 2** Cupcakes  
**CLASS 3** Layer or Loaf Cake  
**CLASS 4** Any other, specify

## CHOOSE DIVISION- BREAD

**DIVISION 122** Grade K-6

**DIVISION 123** Grade 7-12

- CLASS 1** Fruit or Vegetable  
**CLASS 2** Muffins, specify  
**CLASS 3** Yeast Breads, Rolls  
**CLASS 4** Any other, specify

# YOUTH CONTESTS

## CHOOSE DIVISION- COOKIES

**DIVISION 124** Grade K-6  
**DIVISION 125** Grade 7-12

**CLASS 1** Bar Cookies  
**CLASS 2** Drop Cookies  
**CLASS 3** Molded Cookies  
**CLASS 4** Any other, specify

## CHOOSE DIVISION CONFECTIONS

**DIVISION 126** Grade K-6  
**DIVISION 127** Grade 7-12

**CLASS 1** Fudge  
**CLASS 2** Any other, specify

## PRESERVES GUIDELINES

1. Entries must be labeled with the following: product name, processing method and length of processing time. All entries must have been prepared and canned within the last year and include the date of preparation.
2. Two standard jars, specifically for canning purposes, same size and shape are required for each entry. All jars must be thoroughly cleaned. They must have clean, standard canning lids, sealed tightly, with loosened rings. Please no rusty rings and no paraffin seals.
3. One container will be opened for judging. The other container will remain on display for duration of the fair. The opened jar may be picked up the day after judging.
4. Enter 7 pieces of dehydrated foods in a snack size zip lock bag.
5. A total of (12) items may be entered per division..

\*\*\*NOTE\*\*\* If you are entering as an organized youth participant, please include your age, grade and club information including your leader's phone number during entry.

## AMERICAN SYSTEM OF JUDGING

One Best of Division Ribbon will be awarded in each Division

### \$50 SPECIAL AWARD

The Lorraine Tune-Hartley Canning Award  
Sponsored by Gary & Pam Tune

One Best of Division winner will be chosen from Divisions 128 or 129. Youth Preserved Foods will receive a \$50.00 special award In Loving Memory of Lorraine Tune-Hartley.

### \$25 SPECIAL AWARD

Sponsored by Randy & Sheryl Berry  
\$25.00 will be awarded to the top points receiver in Youth Food Preservation. All youth exhibitors, entering independently or with an organized youth group are eligible for this award. (Divisions 128 & 129) The sweepstakes point system is scored as follows: First Place = 3 points, Second Place = 2 points, and Third Place = 1 point. The youth exhibitor with the highest accumulated score will be awarded the sweepstakes.

## PRIZES OFFERED PER CLASS

1st Place	\$3.00
2nd Place	\$2.00
3rd Place	\$1.00

NO Entry Fees

## CHOOSE DIVISION PRESERVES

**DIVISION 128** Grade K-6  
**DIVISION 129** Grade 7-12

**CLASS 1** Fruit, Canned, any variety, specify  
**CLASS 2** Vegetable, Canned, any variety, specify  
**CLASS 3** Soft Spreads, (jams, jelly, etc.) any, specify  
**CLASS 4** Pickles, any variety, specify  
**CLASS 5** Dried Foods, any item, specify  
**CLASS 6** Any other preserved item, specify

# AG MECHANICS

## AG MECHANICS GUIDELINE

### 1. LEADERS/ADVISORS:

email [lynette@maderafair.com](mailto:lynette@maderafair.com) to schedule receiving between Aug. 31st and September 1st, 2026. Exhibitors are limited to ONE entry per class. "Any Other Items" must be identified on the entry form.

2. Although the exhibits need not be owned by the exhibitor, all must be the products of the students as a regular part of their instruction in Agricultural Mechanics. The student exhibitor must have been at least the major contributor to the building or repairing of the exhibit. No entry may be shown for more than one calendar year. An article may not be entered in more than one class and each exhibitor may not enter more than one article from the same pattern. Display cards must be filled out and attached to each exhibit in this department, correctly labeling the exhibit and giving a brief summary of the student exhibitor's project.

3. **GROUP PROJECT:** Entered by FFA Chapter. This is for projects involving 2-6 exhibitors. Please provide all exhibitor's names. If the exhibit is available to sell at auction, it must be indicated on display card. Any individual can not be on more than 2 group projects. Each group is limited to 1 entry.

4. **INDIVIDUAL PROJECT:** This is for projects entered by an individual exhibitor. If the exhibitor is available to sell at auction, it must be indicated on display card. Any individual can enter up to 2 entries per class.

5. An 8% commission will be charged to the exhibitor or chapter for all projects sold through the auction.

6. Highest ranking available Group and Individual projects will sell at Junior Livestock Auction.

7. Construction Cost/Project Value must be included on display cards.

## DIVISION 130 EQUIPMENT REPAIRED

### DANISH SYSTEM OF JUDGING PRIZES OFFERED PER CLASS

1st Place	\$25.00
2nd Place	\$15.00
3rd Place	\$10.00

NO Entry Fee

**CLASS 1** Simple Repairs (\$50.00 or less)

**CLASS 2** Complex Repairs (\$50.00 or more)

## DIVISION 131 SMALL CONSTRUCTION PROJECTS

Small Projects constructed in which the material costs do not exceed \$50.00.

### DANISH SYSTEM OF JUDGING PRIZES OFFERED PER CLASS

1st Place	\$6.00
2nd Place	\$5.00
3rd Place	\$4.00

NO entry fee

**CLASS 1** Cold Metal

**CLASS 2** Welding, Forging

**CLASS 3** Electrical

**CLASS 4** Woodwork

**CLASS 5** Rope Work

**CLASS 6** Combination

**CLASS 7** Sheet Metal

**CLASS 8** Any other, specify

# AG MECHANICS

## DIVISION 132 MEDIUM CONSTRUCTION PROJECTS

Medium Projects constructed in which material costs are more than \$50.00 but do not exceed \$150.00.

### DANISH SYSTEM OF JUDGING PRIZES OFFERED PER CLASS

1st Place	\$12.00
2nd Place	\$10.00
3rd Place	\$8.00

NO entry fee

<b>CLASS 1</b>	Cold Metal
<b>CLASS 2</b>	Welding, Forging
<b>CLASS 3</b>	Electrical
<b>CLASS 4</b>	Woodwork
<b>CLASS 5</b>	Rope Work
<b>CLASS 6</b>	Combination
<b>CLASS 7</b>	Sheet Metal
<b>CLASS 8</b>	Any other, specify

## DIVISION 133 LARGE CONSTRUCTION PROJECTS

Large Projects constructed in which material costs are more than \$150.00.

### DANISH SYSTEM OF JUDGING PRIZES OFFERED PER CLASS

1st Place	\$35.00
2nd Place	\$30.00
3rd Place	\$25.00

NO entry fee

<b>CLASS 1</b>	Construction Costs \$150.00-\$500.00
<b>CLASS 2</b>	Construction Costs \$501.00-\$2000.00
<b>CLASS 3</b>	Construction Costs \$2001.00-\$3500.00
<b>CLASS 4</b>	Construction Costs \$3501.00-\$5000.00
<b>CLASS 5</b>	Construction Costs Over \$5001.00

## DIVISION 134 FFA GROUP CONSTRUCTION PROJECTS

### DANISH SYSTEM OF JUDGING PRIZES OFFERED PER CLASS

1st Place	\$35.00
2nd Place	\$30.00
3rd Place	\$.00

NO Entry Fee

<b>CLASS 1</b>	Construction Costs \$150.00-\$500.00
<b>CLASS 2</b>	Construction Costs \$501.00-\$2000.00
<b>CLASS 3</b>	Construction Costs \$2001.00-\$3500.00
<b>CLASS 4</b>	Construction Costs \$3501.00-\$5000.00
<b>CLASS 5</b>	Construction Costs Over \$5001.00

*Free Online Entries*

**STILL and FLORICULTURE  
until August 1st, 2026!**

# FLORICULTURE-HOME GARDENING

## FLORICULTURE and HOME GARDENING

	ENTRY CLOSING	RECEIVING	CLAIMING
Gardens Adult & Junior	Tuesday August 25th between 4:00 - 8:00 PM	Completed by: Monday, Sept. 7th by 5:00PM	Tues. - Sept. 15th 4:00 - 8:00 PM
Dry Arrangements, Wreaths & Yard Art		Aug. 31st & Septmeber 1st 4-8 PM	Tues. - Sept. 15th 4:00 - 8:00 PM
Potted Plants		Tues. Sept. 8th 4:00-8:00 PM Home Arts	Tues. - Sept. 15th 4:00 - 8:00 PM
Produce, Fresh Arrangements, Natures Wonders & Home Gardening		Tues. Sept. 8th 4:00-8:00 PM Home Arts	Tues. - Sept. 15th 4:00 - 8:00 PM

**Open to Residents of Madera, Merced and Fresno Counties**

**All Local Rules Apply.**

1. Exhibitors are limited to two exhibits in any one class except where noted.
2. Exhibits in the Floriculture Department must have been grown by the exhibitor within the county, district or community represented by the exhibitor, except in classes for arrangements.
3. Exhibits must be adequately and correctly labeled.
4. Under no circumstances will flowers for exhibits be assembled in the show area. Table for assembling exhibits will be provided outside the show area.
5. Containers will be furnished for cut flowers and must be used by exhibitors.
6. Judges shall award first, second and third place according to merit and if without merit, no award shall be made.
7. Containers must be properly marked and cleaned for display.
8. All containers must be able to be moved as a single piece. If containers are made of multiple parts, all parts need to be securely attached. Fair shall not be responsible for any container that is not properly constructed.
9. Large containers/plants can be brought and placed. Please make arrangements with the Fair. Vases that leak will be replaced or removed from show.
10. Roses, except polyantha, ramblers and cluster types, should be disbudded. This also applies to dahlias, carnations and asters.
11. Foliage and accessories are permitted in all classifications of flower arrangements.
12. List variety or color on entry form for all "Any Variety Not Listed".
13. The Fair will not be responsible for loss, theft, or breakage.

**A copy of the State Rules may be obtained at the Fairgrounds main office or at: [www.cdfa.ca.gov/fe/](http://www.cdfa.ca.gov/fe/)**

# FLORICULTURE-HOME GARDENING

Please read general rules on page 8 and specific guidelines for each contest where applicable.

## GENERAL GUIDELINES

See pg. 33 for additional floriculture rules, dates and times. Exhibitors 18 years of age and under may enter any special contest (as an adult) if there is not a comparable one in the Junior Division.

### THIS IS HOW YOU DO IT!

1. Decide what division(s) and class(es) you are entering.
2. Visit [maderafair.com/entry](http://maderafair.com/entry) to create a username to enter online. ONLINE STILL and FLORICULTURE entries are FREE until August 1st, 2026.
3. Submit online entry OR paper entry form on or before August 25th, 2026, pay applicable entry fees.
4. Bring Exhibit on FINAL receiving days, Aug. 31st or September 1st, 2026 unless noted.
5. To reserve your Garden Spot or Barrels please submit online or come into the office upon entry opening.

## GARDEN GUIDELINES

1. Only one entry per person or organization permitted per division. In these division, if gardens are not filled by entry closing date, (1) additional entry will be permitted and assigned per order of waiting list.
2. A limited number of Gardens are available on the grounds and will be filled on a first come basis. To reserve your Garden Spot or Barrels please submit online or come into the office upon entry opening.
3. Madera County residents will be given first preference. Merced and Fresno County garden entries will be accepted beginning July 15th to fill any remaining openings.
4. If a garden space is not started by Sunday, Sept. 6th @ 5PM, that designated space will be filled with an exhibitor from the waiting list, if wait list exhibitor needs additional time, it will be allowed due to late start.
5. No commercial recognition permitted.
6. Plant materials for garden exhibits must be growing with roots well established in order to avoid wilt and disorderly appearance. If plants are not rooted, exhibit will be disqualified.
7. Gates will be open from 8AM to 4PM for watering gardens. Prior to the opening day of the Fair, exhibitors are responsible for watering as needed. During the Fair, gardens will be watered by Fair staff.

8. Gardens may be started as early as Saturday, September 5th from 8:00AM - 5:00PM. Gardens must be completed by Monday, September 7th @ 5 PM, unless otherwise authorized by the fair.
10. Individuals may utilize assistants but, the exhibitor must be the creative designer and execute the complete garden.

Open to Groups or Individuals  
**AMERICAN SYSTEM OF JUDGING**  
One Best of Show Ribbon will be awarded in  
Garden Div. 200 and 201

10'x10' GARDEN	
1st Place	\$150.00
2nd Place	\$100.00
3rd Place	\$75.00
4th Place	\$50.00
NO Entry Fee	

## DIVISION 200 GARDENS

- CLASS 1** 10'x10' Garden "ALL AMERICAN PARTY"  
**CLASS 2** 10'x10' Garden "All In This Together"  
\*class 2 for organized youth programs only

30"x6' RAISED GARDEN BED	
1st Place	\$90.00
2nd Place	\$65.00
3rd Place	\$40.00
4th Place	\$25.00
NO Entry Fee	

## DIVISION 201 GARDENS

- CLASS 1** 30"x6' Raised Garden "Backyard BBQ"  
**CLASS 2** 30"x6' Raised Garden "Stars and Stripes"  
**CLASS 3** 30"x6' Raised Garden "Route 66"  
**CLASS 4** 30"x6' Raised Garden "This Land Is Your Land"

# FLORICULTURE-HOME GARDENING

**PRIZES OFFERED**  
PER CLASS in the following  
DIVISIONS: 202-206

1st Place	\$10.00
2nd Place	\$7.00
3rd Place	\$5.00

Entry Fees: \$1.00 per entry per class  
AMERICAN SYSTEM OF JUDGING

## **DIVISION 202 DECORATE A PUMPKIN**

Have you ever wanted to create a pumpkin centerpiece? Here is your chance to share your creative ideas and show it off! You can use silk, dried, cactus or succulents.

1. No pumpkin larger than 14 inches in diameter.
2. You can use a real or artificial pumpkin.

**CLASS 1** Adult: age 19 and older  
**CLASS 2** Junior: age 18 and under

## **DIVISION 203 WREATH**

It's the last few holidays of the year and we can decorate for a celebration. Decorate and arrange with dry, silk or mixed materials. Wreaths may be 12"-24" across. Will it be round, oval, square or other? The wreath will need to hold foliage, flowers, plants or berries. The base can be a coat hanger, wood, horseshoes, rope or something completely different. Let's welcome the fair guests with your creative holiday skills and your favorite decorated wreath to hang this year.

**CLASS 1** Halloween  
**CLASS 2** Thanksgiving  
**CLASS 3** Christmas  
**CLASS 4** All American

## **DIVISION 204 NATURE'S WONDERS**

Do you have a sunflower that is bigger than your head? How about that ugly weed that you just can't seem to kill? Bring them to the fair and compete in the best of "Nature's Wonders!"

**CLASS 1** Pumpkin, largest in weight  
**CLASS 2** Sunflower head, largest by diameter  
**CLASS 3** Squash, largest in length  
**CLASS 4** Watermelon, largest by weight  
**CLASS 5** Ugliest Weed (Container/Potted)  
**CLASS 6** Any vegetable, oddest shape

## **DIVISION 205 UNUSUAL CONTAINER**

Show off your imagination by using a variety of unconventional items as potting containers. Maybe a hat, old chair, tire, watering can, or pallet? Anything, really! Express your floral artistry and give your favorite a new look.

**CLASS 1** Garage Find  
**CLASS 2** Tea Cups or Coffee Mugs  
**CLASS 3** Vintage Footwear  
**CLASS 4** Household Item  
**CLASS 5** Item larger than 18" but no larger than 4'  
**CLASS 6** Any other, specify

## **DIVISION 206 CREATIVE YARD ART**

**CLASS 1** Birdhouse, Bird feeder  
**CLASS 2** Metal (mailbox, topiary form)  
**CLASS 3** Stepping Stone, Rock  
**CLASS 4** Wood (sign, planter)  
**CLASS 5** Any other not listed, specify

**PRIZES OFFERED PER CLASS in the following  
DIVISIONS: 207-209**

1st Place	\$5.00
2nd Place	\$4.00
3rd Place	\$3.00

Entry Fees: \$1.00 per entry per class

# FLORICULTURE-HOME GARDENING

## AMERICAN SYSTEM OF JUDGING

One Best of Division Ribbon will be awarded in each Division, Divisions 207-209, with one Best of Show being chosen from the winners.

### DIVISION 207

#### HOME GARDENING - Produce

1. Three different varieties, per class, per person may be entered. Be prepared to state variety name upon receiving.
2. Amount to be displayed per entry follows class description.
3. Cracked, broken or spoiled produce will not be accepted.
4. If spoilage occurs, produce will be discarded after judging.

- CLASS 1** Bell Peppers, 3  
**CLASS 2** Cucumbers, 3  
**CLASS 3** Eggplant, 1  
**CLASS 4** Okra, 6  
**CLASS 5** Peppers, specify, 6  
**CLASS 6** Squash, 1  
**CLASS 7** Tomatoes, 3  
**CLASS 8** Other, specify

### DIVISION 208

#### SILK ARRANGEMENTS

- CLASS 1** "Floral Designs"

### DIVISION 209

#### DRIED ARRANGEMENTS

- CLASS 1** "Let Fall Begin"

#### PRIZES OFFERED PER CLASS in DIVISIONS 210-215

1st Place	\$5.00
2nd Place	\$4.00
3rd Place	\$3.00

Entry Fees: \$1.00 per entry per class

## AMERICAN SYSTEM OF JUDGING

One Best of Division Ribbon will be awarded in each Division, Divisions 210-215 with one Best of Show being chosen from the winners.

### DIVISION 210

#### IKEBANA

Ikebana, a Japanese floral and plant arrangement emphasizing other areas of the plant, such as its stems and leaves, and draws emphasis toward shape, line and form. Use of dried, fresh or silk materials.

- CLASS 1** Container opening size under 12"

- CLASS 2** Container opening size over 12"

### DIVISION 211

#### COLLECTION OF PLANTS

1. Collection of three pots, 1 plant per pot.
2. Only 10% of accessories or materials other than container should be unusually evident.

- CLASS 1** Cactus and Succulents

- CLASS 2** Ornamental Grasses

- CLASS 3** Potted Plants, other

### DIVISION 212

#### DISH GARDENS

- CLASS 1** Dish Garden

### DIVISION 213

#### HANGING PLANTS

Your beautiful hanging plants need to be ready to hang and have cascading foliage for all to see.

- CLASS 1** Container opening 12" and under

- CLASS 2** Container opening 12" and over

### DIVISION 214

#### SINGLE PLANTS

Bring in your plant to show off its beauty. One plant only, and no hanging pots.

- CLASS 1** Begonia, Any

- CLASS 2** Dracaena

- CLASS 3** Elephant Ears

- CLASS 4** Pony Tail Palm

- CLASS 5** Fern, any

- CLASS 6** Other, specify

# FLORICULTURE-HOME GARDENING

## DIVISION 215

### CACTUS & SUCCULENTS

- CLASS 1** Cactus, Bearded  
**CLASS 2** Cactus, Column type  
**CLASS 3** Cactus, Echino (barrel type)  
**CLASS 4** Cactus & Succulent Dish Garden. Container opening not to exceed 12".  
**CLASS 5** Cactus or Succulents, up to three (3) varieties growing in a dish garden, opening not to exceed 12" in diameter.  
**CLASS 6** Cactus or Succulents, 4 or more varieties growing in a dish garden, opening not to exceed 12" in diameter.  
**CLASS 7** Cactus, any variety not listed, please specify  
**CLASS 8** Christmas Cactus  
**CLASS 9** "Garden Scene" dish garden using cactus and/or succulents.  
**CLASS 10** Jade Tree, any  
**CLASS 11** Succulent Dish Garden container opening not to exceed 12"  
**CLASS 12** Succulent - (2) varieties, one container  
**CLASS 13** Succulent, any or any not listed, special

#### PRIZES OFFERED PER CLASS in Divisions 216 & 217

1st Place	\$10.00
2nd Place	\$7.00
3rd Place	\$5.00

Entry Fees: \$1.00 per entry per class

#### AMERICAN SYSTEM OF JUDGING

## DIVISION 216

### BONSAI

The art of dwarfing and shaping trees and shrubs in shallow pots through pruning is art all in itself.

- CLASS 1** Container opening size under 12"  
**CLASS 2** Container opening size over 12"

## DIVISION 217

### TOPIARY

The art or practice of training live perennial plants by clipping the foliage and twigs of trees, shrubs

and sub-shrubs to develop and maintain clearly defined shapes. Enter and share with Madera Fairgoers your fanciful creations!

- CLASS 1** Container size under 12"  
**CLASS 2** Container size over 12"

#### PRIZES OFFERED PER CLASS in DIVISIONS 218-222

1st Place	\$3.00
2nd Place	\$2.00
3rd Place	\$1.00

Entry Fees: \$1.00 per entry per class

#### AMERICAN SYSTEM OF JUDGING

One Best of Division Ribbon will be awarded in each Division, Divisions 218-222, with one Best of Show being chosen from the winners.

## DIVISION 218

### CUT FLOWER PERENNIALS and ANNUALS

This time of year may be limited, but fall flowers are at their best. Below are the ones we want to see. If there is not a particular fit, choose "Any Other". Please send in three stems with foliage.

- CLASS 1** Zinnias  
**CLASS 2** Chrysanthemums, small or clusters  
**CLASS 3** Yarrow  
**CLASS 4** Sunflowers  
**CLASS 5** Any Other Perennial not listed, specify  
**CLASS 6** Any Other Annual not listed, specify

## DIVISION 219

### DRIED FLOWERS

What a delightful way to showcase dried flower arrangements. Each class will focus on a method of drying flowers showing the diverse techniques and outcomes.

- CLASS 1** Air Dried  
**CLASS 2** Freeze Dried  
**CLASS 3** Pressed  
**CLASS 4** Any other not listed, specify

# FLORICULTURE-HOME GARDENING

## DIVISION 220 PROPAGATION

There are a few ways to propagate our new plants for our home garden and plants. Whichever way you choose, bring in your creations for the fair to see.

- CLASS 1** Water Propagation
- CLASS 2** Soil Propagation
- CLASS 3** Air Layering
- CLASS 4** Any other, specify

## DIVISION 221 PRIDE OF THE PORCH

You have dedicated your time and attention to these beauties and have invested in porch gardens throughout the year. Now is the time to showcase and share their growing journey. These plants may have been entered in the contests of years gone by and now we will have a look at how they have grown. Please include a short paragraph of a gardening story along with entry (index card) to share your care and gardening tips to fair goers.

- CLASS 1** My Favorite Plant
- CLASS 2** Cactus and Succulents

### DANISH SYSTEM OF JUDGING

Entry Fees: \$1.00 per entry per class

## DIVISION 222 I'M NEW!

Exhibitors demonstrate their potting skills by planting and presenting a potted plant for our exhibit display. We encourage and celebrate the creativity and passion of beginners, let's say 1st timers, in the art of floriculture all in one place. Let's start something new and grow! You can bring in ANY plant you want to display.

- CLASS 1** Beginner or 1st Timer in Floriculture

*Free Online Entries*  
**STILL and FLORICULTURE**  
**until August 1st, 2026!**

# FLORICULTURE-YOUTH

## AMERICAN SYSTEM OF JUDGING

One Best of Division Ribbon will be awarded in each Division.

### DIVISION 223 "CARS Turns 20!"

Here is your chance to recreate the best race with the coolest cars ever. This creative contest puts imagination in the driver's seat. Get ready to shift into high gear and let the best barrel win!

To reserve your Garden Spot or Barrels please submit online or come into the office upon entry opening.

1. Barrels provided by Madera Fair, 24" diameter x 8" deep.
2. Maximum entries six (6). First come, first served.
3. Limited to (1) one entry per exhibitor.
4. No one over 12 years old.

#### PRIZES OFFERED PER CLASS

1st Place	\$15.00
2nd Place	\$10.00
3rd Place	\$7.00

NO Entry Fee

### CLASS 1 "Racers, Start Your Engine!"

### DIVISION 224 "PLANT A SHOE"

- Step 1: Find a shoe or boot!  
 Step 2: Plant your favorite cactus, succulents works best!  
 Step 3: Bring it to the Fair!

Match the colors, textures and styles of your shoe to plants that you use to come up with a unique, planted shoe. \*Make sure you plant your shoe with dirt and use live plants.

#### PRIZES OFFERED PER CLASS

1st Place	\$10.00
2nd Place	\$7.00
3rd Place	\$5.00

NO Entry Fee

### CLASS 1 "All American Party"

### CLASS 2 Cactus or Succulent Garden

## New This Year

### HIGH SCHOOL CLASSROOM GUIDELINES

No entry fees - Ribbon Award only  
No Pre-Entry Required  
DANISH SYSTEM OF JUDGING

1. Classroom projects are for TEACHERS ONLY entering for each student in their classroom. either as individuals. Each student will receive a ribbon for his/her accomplishment.
2. **DIV. 225 MUST have student's full name, school, grade and teacher's name on a floral pick. EXHIBITS MAY NOT BE RECEIVED IF THIS STEP IS NOT COMPLETED. THIS IS THE ONLY IDENTIFYING ELEMENT on students work.**
3. Include a legible classroom list with each student's name recorded as it appears on the FRONT of their floral pick. If you choose to photocopy your roll sheet, please clearly note any name changes so that the names will match the names on each student's entry.
4. All work must have been done by Madera County students within the last 12 months.
5. Maximum 2 entries per student may be entered in Div. 225.

Exhibits Due: TUES. SEPTEMBER 8TH 8PM

### FLORICULTURE CLASSROOM PROJECT

Madera Fair is excited that you can celebrate the "ALL AMERICAN PARTY" projects with us! You are welcome to incorporate this idea OR enter any wonderful projects your students create! ALL classroom projects are welcome.

### DIVISION 225- Same project, Individually Created

- CLASS 1 Fresh Flower Arrangement
- CLASS 2 Mason Jar
- CLASS 3 Dry or Silk Arrangement
- CLASS 4 Dish Gardens
- CLASS 5 Wreath

# FLORICULTURE-YOUTH

## ARRANGEMENTS and POTTED PLANTS AMERICAN SYSTEM OF JUDGING

One Best of Division Ribbon will be awarded in each  
Division 226-234.

### PRIZES OFFERED PER CLASS

1st Place	\$3.00
2nd Place	\$2.00
3rd Place	\$1.00

NO Entry Fees

## DIVISION 226 FRESH FLOWER ARRANGEMENT

Container opening not to exceed 6" in diameter.  
You choose your container!

- CLASS 1**   Preschool-K
- CLASS 2**   Grades 1-4
- CLASS 3**   Grades 5-8
- CLASS 4**   Grades 9-12

## DIVISION 227 MASON JAR

This is so easy to create that timeless arrangement  
that is so much fun to add to any decor.

- CLASS 1**   Preschool-K
- CLASS 2**   Grades 1-4
- CLASS 3**   Grades 5-8
- CLASS 4**   Grades 9-12

## DIVISION 228 DRY OR SILK ARRANGEMENT

- CLASS 1**   Preschool-K
- CLASS 2**   Grades 1-4
- CLASS 3**   Grades 5-8
- CLASS 4**   Grades 9-12

## DIVISION 229 DISH GARDENS

Container opening not to exceed 12" in diameter.

- CLASS 1**   Preschool-K
- CLASS 2**   Grades 1-4
- CLASS 3**   Grades 5-8
- CLASS 4**   Grades 9-12

## DIVISION 230 CACTUS and SUCCULENTS

- CLASS 1**   Cactus, Bearded
- CLASS 2**   Cactus, Column type
- CLASS 3**   Cactus, Echino (barrel type)
- CLASS 4**   Cactus, Any other, specify
- CLASS 5**   Succulent, Any, specify

## DIVISION 231 HANGING PLANTS \*Must be ready for hanging.

- CLASS 1**   Container opening 12" and under
- CLASS 2**   Container opening 12" and over

## DIVISION 232 POTTED HOUSE PLANTS You can enter any potted house plant.

- CLASS 1**   Any Other House Plant, specify

## DIVISION 233 SHRUBS, TREES, GRASS Single Container with shrub, tree or grass.

- CLASS 1**   Azalea
- CLASS 2**   California Bay Laurel
- CLASS 3**   California Oak
- CLASS 4**   Fruit Tree, specify
- CLASS 5**   Tree, specify
- CLASS 6**   Native Shrub, specify
- CLASS 7**   Bottle Brush
- CLASS 8**   Crape Myrtle
- CLASS 9**   Any Other Foliage Plant, specify

## DIVISION 234 WREATH This is for YOU! Create those spectacular wreaths! Use any form or shape. Decorate and arrange with live, silk or dry materials. Wreaths can be between 12-24 inches in diameter. Will it be round or square, wire or rope, the decision is yours.

- CLASS 1**   Halloween
- CLASS 2**   Thanksgiving
- CLASS 3**   Christmas
- CLASS 4**   All American