



MAIN ADDRESS

715 Locust St
Evansville, IN 47708

MAIN PHONE NUMBER

(812) 435-5770

MAIN FAX

(812) 435-5500

TECHNICAL PACKET



MANAGEMENT TEAM

General Manager

Alexis Berggren

(812) 437-8283

Aberggren@oldnationaleventsplaza.com

Box Office Manager

Cindy Gehring

(812) 437-8287

cgehring@oldnationaleventsplaza.com

Director of Operations

Brian Liivak

(812) 437-8286

bliivak@oldnationaleventsplaza.com

Event Manager

Natalie Duesler

(812) 437-8284

nduesler@oldnationaleventsplaza.com

Sales & Marketing Contact

Ginger Harper

(812) 437-8302

bliivak@oldnationaleventsplaza.com

Merchandise Contact

Nick Wallace

(812) 437-8303

nwallace@oldnationaleventsplaza.com

Catering Sales Manager

Kasia McMullen-Koontz

(812) 437-8301

kkoontz@oldnationaleventsplaza.com



LOADING DOCK

Located on the Walnut St side of the facility

Docks 3 & 4 are dedicated to the Stage

2 Dock Bays located Off-Stage Right, with 50ft flat push to Off-SR storage
8ft w x 10ft h rollup doors – (1) permanent dock plate, (1) moveable dock plate

Freight Elevator to Basement located Off-Stage Right

Docks 1 & 2 are subject to availability and will be discussed during the advance





STAGE INFORMATION

Proscenium width: 57' - 11"

Proscenium height: 28'

Wall to Wall Stage Width: 98'

Center Line to Fly Floor Edge: 41' - 5"

Plaster Line to First US Obstruction: 43'

DS Edge to First US Obstruction: 52'

DS Edge of Orchestra Pit to First US Obstruction: 59' - 10"

DS Edge to Plaster Line: 9'

DS Edge of Orchestra Pit at Stage Level to Plaster Line: 16' - 10"

1st Catwalk Throw to DS Center: 62' - 67'

2nd Catwalk Throw to DS Center: 90' - 94'

Follow Spot Booth Throw to DS Center: 153'

FOH Mix to DSC: 88'

Lighting & Sound Booth to DSC: 120'

Grand Tier Rail to DSC: 93' - 95'

Balcony Rail to DSC: 125' - 127'

LABOR

All stage and truck labor is provided through IATSE Local 102

For current stagehand rates, and to advance labor, please contact house Event Manager



Local 102
International Alliance of Theatrical Stage Employees
Evansville, Indiana





RIGGING

DOUBLE PURCHASE system from Tiffen Rigging – Re-roped with multiline in August 2002

49 Line Sets

Operated from SL Fly floor – 10'- 0" above stage floor

Grid Height: 61'- 0"

Bottom of Loft: 60'- 0"

Maximum Fly Height: 59'- 0"

Battens- See Line Set Schedule

49 – 70'- 0" Double Purchase on 6" centers

4 – 70'- 0" Motorized dedicated Electric battens

2 – Motorized dedicated Orchestra Shell ceiling panels

Arbor Capacity: 2,000lbs (1,000lbs at pipe)

Chain motors can be rigged from the Grid using 4" schedule 80 pipe sections.

Standard safe rigging practices are required.

Dedicated Sound points – located 3'- 0" DS of proscenium

Points DS of Plaster – located 10'- 0" DS of proscenium at every 8'- 0" across

SOFT GOODS

List of available soft goods in Aiken Theatre

Type	Quantity	Height	Width	Color	Notes
Main Curtain	1	28'	70'	Red	Includes Valance
Border	5	15'6"	70'	Black	
Legs	5 (pairs)	22' 8"	22'	Black	
Travelers	3	22' 8"	70'	Black	



LINESET SCHEDULE

Lineset	Plaster	Housing Hang	Show Hang	Pipe Weight	Notes
	8"	Valence			Controls from SR
1	1'-5"	Main Drape			
2	2'-6"				
3	2'-11"				
	3'-7"	1 st Electric			
4	4'-4"				
5	5'				
6	5'-8"				
	6'-5"	1 st Orchestra Shell			
7	7'-5"				
8	7'-11"	1 st Border			
9	8'-6"	1 st Legs			
10	9'-1"				
11	9'-9"				
12	10'-4"				
13	11'-5"	1 st Traveler			
14	12'-8"				
15	13'	2 nd Border			
16	13'-8"	2 nd Legs			
17	14'-2"				
	15'-1"	2 nd Electric			
18	15'-10"				
19	16'-3"				
20	16'-9"				
21	17'-4"				
	18'-1"	2 nd Orchestra Shell			
22	18'-11"				
23	19'-4"				
24	19'-10"	3 rd Border			
25	20'-3"	3 rd Legs			
26	20'-7"				
27	21'-3"				
28	22'-7"	2 nd Traveler			
29	23'-4"				
	24'-5"	3 rd Electric			
30	25'-6"				
31	26'-3"	4 th Border			
32	27'-1"	4 th Legs			
33	28'-8"				
34	29'-3"				
35	29'-10"				
36	30'-8"				
37	31'-1"				
38	31'-9"	5 th legs			
39	33'-2"				
40	34'-2"				
41	35'				
42	35'-10"	5 th Border			
	36'-10"	4 th Electric			
43	37'-8"	3 rd Traveler			
44	38'-8"				
45	39'-5"				
46	40'-1"				
47	41'	4 th Traveler			Empty track
48	41'-8"	Cyc			
49	42'-5"				Very close to back wall
Notes		Width of stage is 101' from wall to wall	Plaster line to back wall is 44'	Double purchase system	Proscenium opening is 58'



ORCHESTRA PIT

Hydraulic Orchestra Pit

- Stage Level
- Floor Level – Rows AAA, BBB, CCC
- Pit Level

Pit= 40ft at widest point x 12ft at deepest point

SHOW POWER

Amps	Location
800, 208V	Mid Stage Right
800, 208V	Mid Stage Left

Bare wire tails

Dedicated sound ground available at both locations.

LIGHTING CONTROL & DIMMING

ETC Ion console with tablet running ARFR software

House Light Control located:

- Lighting Booth
- FOH Mix
- Stage Manager Panel DSR

#	Model	Location
18	Source 4 PAR w/ lens kits	On stage 1 st Electric
6	Source 4	On stage 1 st Electric
18	Source 4 PAR w/ lens kits	On stage 2 nd Electric
6	Source 4	On stage 2 nd Electric
18	Source 4 PAR w/ lens kits	On stage 3 rd Electric
6	Source 4	On stage 3 rd Electric
6	3 color Cyc lights	On stage 4 th Electric
22	Source 4 26 Degree Ellipsoidal	1 st Catwalk (nearest to stage)
18	Source 4 19 Degree Ellipsoidal	2 nd Catwalk (furthest from stage)
5	Source 4 10 Degree Ellipsoidal	2 nd Catwalk (furthest from stage)
12	Source 4 5 Degree Ellipsoidal	Balcony Rail
4	Source 4 10 Degree Ellipsoidal	Balcony Rail
4	2K Strong Xenon Super Trouper	Spot Booth



DIMMER SCHEDULE

1-4	Followspot Booth	
5-16	1 st Balcony Rail	
17-22	2 nd Balcony Box Seat House Left	
23-28	2 nd Balcony Box Seat House Right	
29-40	2 nd Balcony Rail	
41-82	2 nd Catwalk	
83-127	1 st Catwalk	
128-145	Proscenium Catwalk	
146-151	House Left Box Boom 1	
152-157	House Right Box Boom 1	
158-163	House Left Box Boom 2	
164-169	House Right Box Boom 2	
170-173	Orchestra Pit Stage Right	
174-177	Orchestra Pit Stage Left	
178-217	1 st Electric	
218-257	2 nd Electric	
258-297	3 rd Electric	
298-337	Cyc Electric	
	Drop Box – Dimmer #'s available	
	Drop Box	
	Drop Box	
	Drop Box	
	Drop Box	
	Drop Box	
410-417	Down-Stage Right Proscenium Wall	
418-425	Down-Stage Left Proscenium Wall	
426-433	Up-Stage Right Proscenium Wall	
434-441	Up-Stage Left Proscenium Wall	
445-462	1 st Orchestra Shell Electrics	Dedicated
463-480	2 nd Orchestra Shell Electrics	Dedicated
494-505	Down-Stage Platform Zipstrips	Dedicated
506-513	Up-Stage Platform Zipstrips	Dedicated
514-517	Proscenium Catwalk	



AUDIO

- DDA CS3/ 40 channel Audio board located in Sound Booth
 - Left and right stack has EAW MH660E long throw md/hi, 2 BV525 long throw bass, and MH690IE mid throw mid/hi.
 - 93dB Max
 - The center cluster has EAW AS690 mid/hi/low, and MH690IE hi/mid/short throw.
 - There are MK2194 speakers positioned on the catwalks, and various other smaller speakers on the pit lip and under balconies.
 - Crown Com-tech 410, 810, and 1610 Amps
 - EV EQ-131 Equalizers
 - EAW MX8750 processors
 - Rane AD22B digital delays
 - Rane PE17 parametric equalizers
 - Compressors
 - 360 Systems Instant Replay machine
 - PA rooms are located DSL and DSR in which to situate amps and stacks.
 - FOH Mix located at Orchestra rear. House tie-in can be accomplished here, or backstage.
 - (3) 12" conduits run from FOH to the orchestra pit. Road snakes must use these, as there are no center aisles in the auditorium.
- 

Orchestra Level

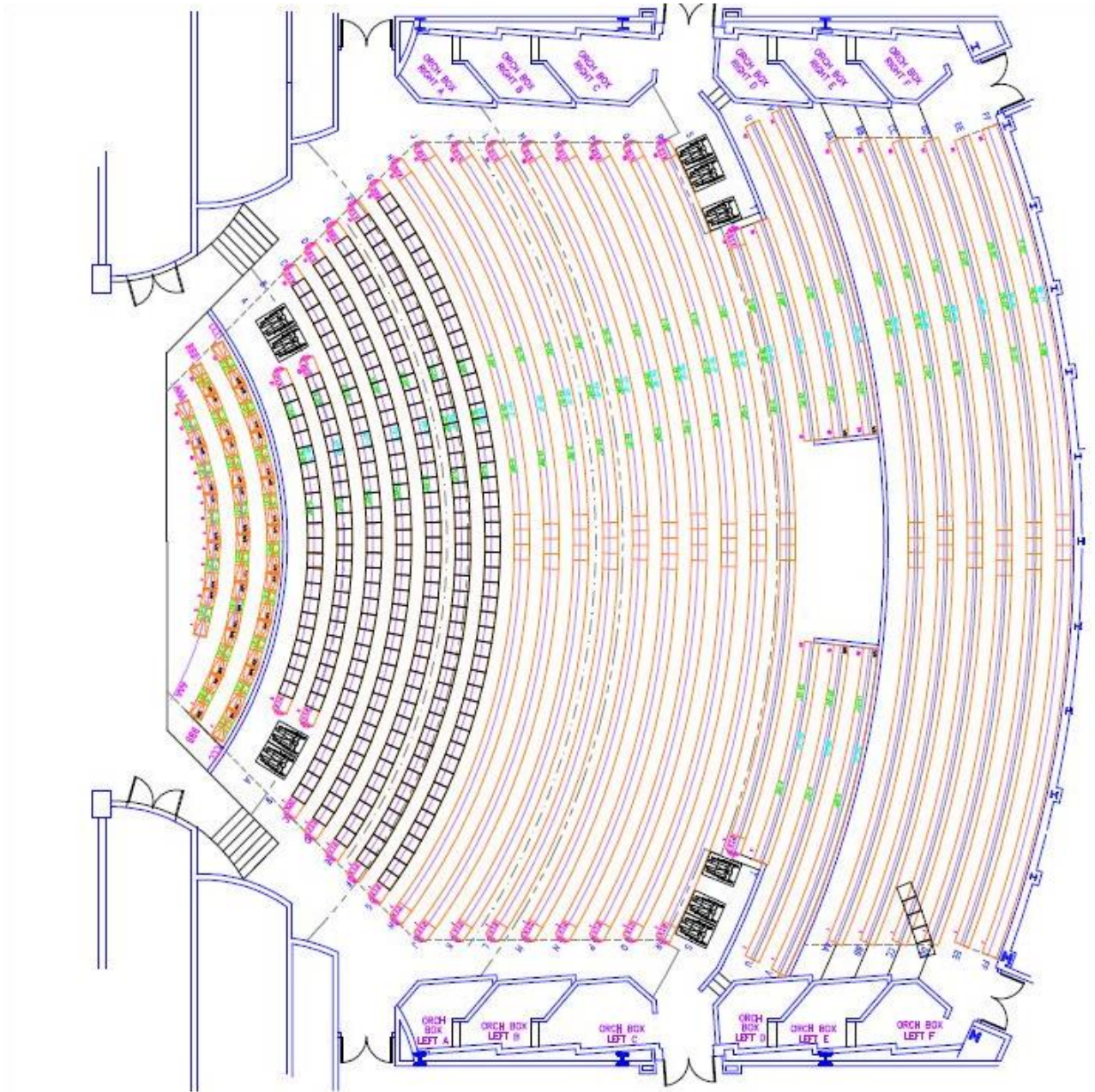

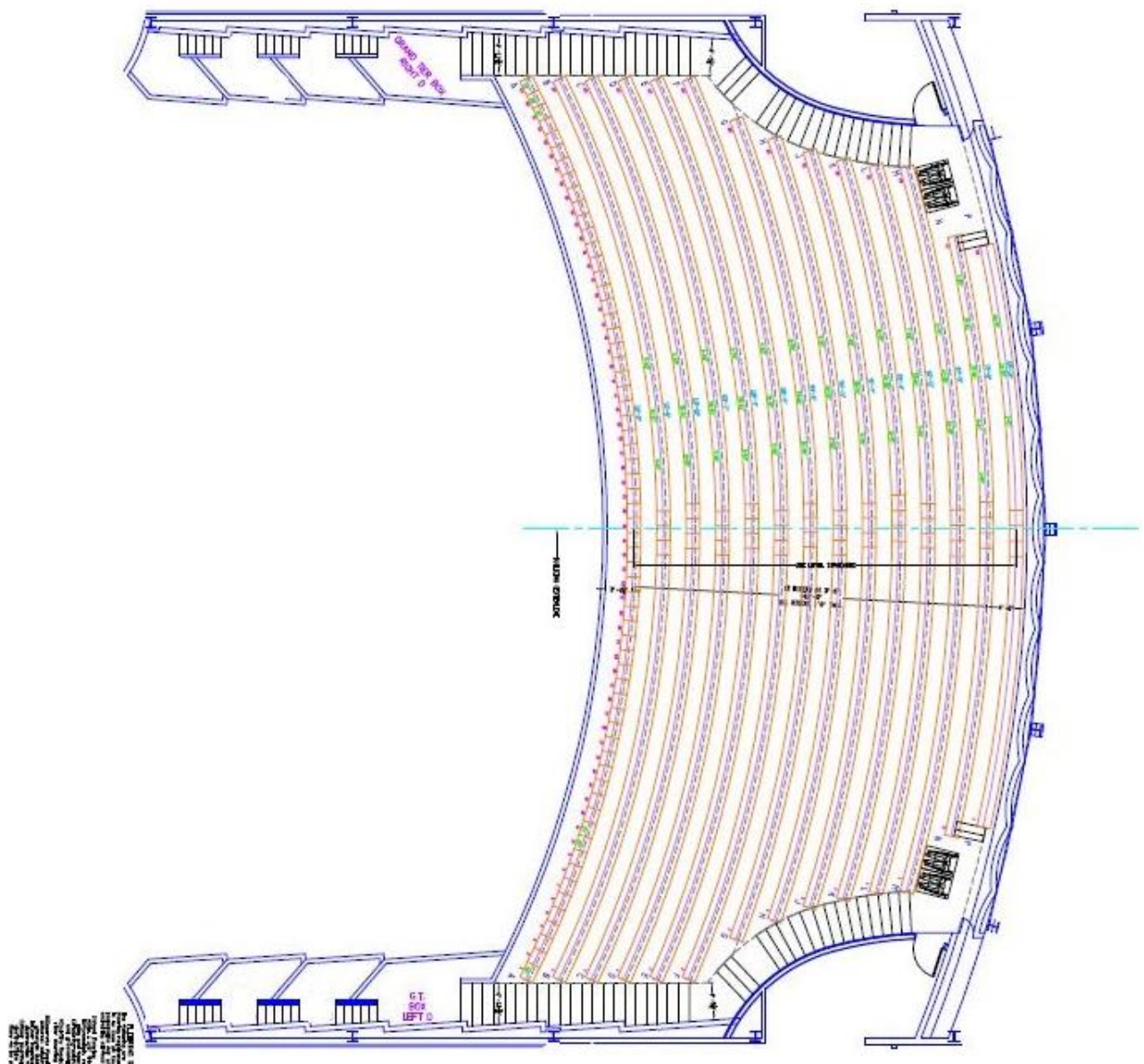

Balcony

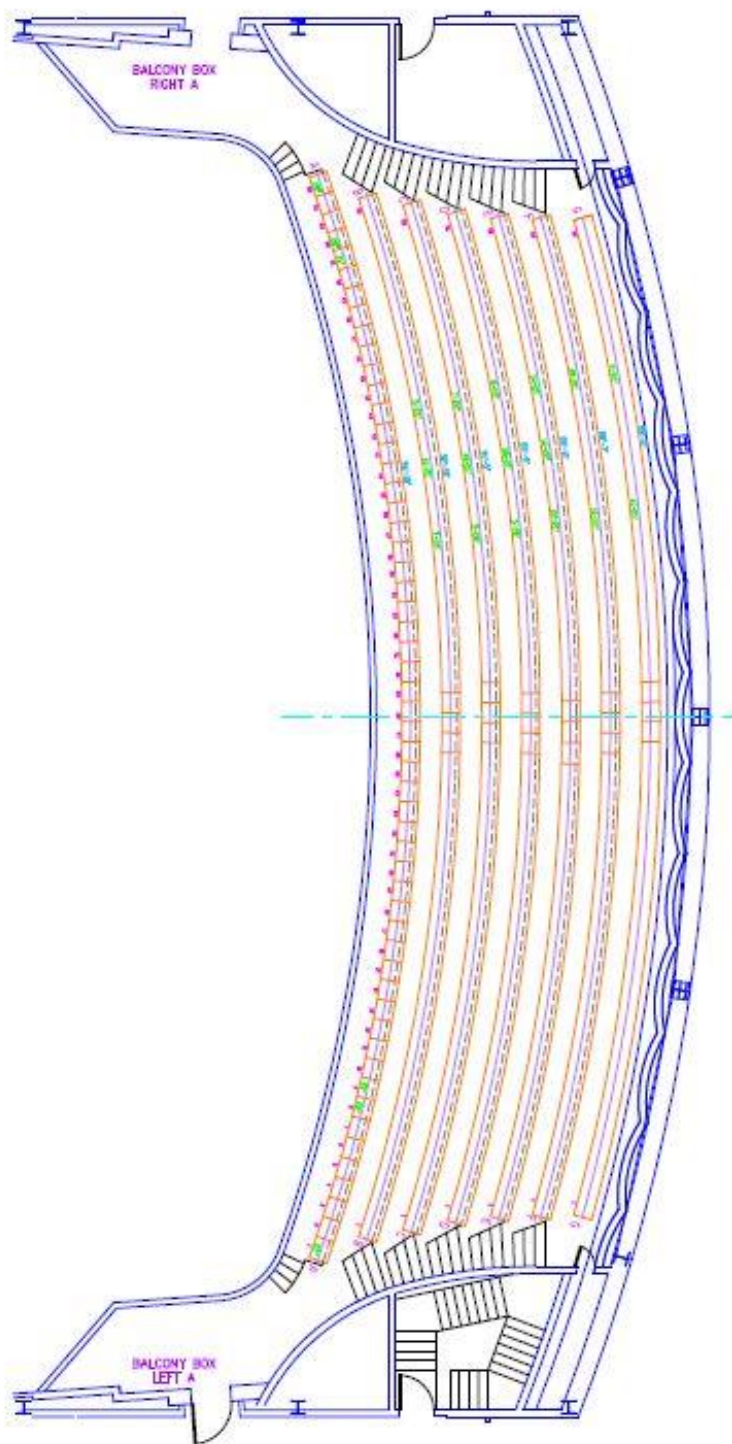

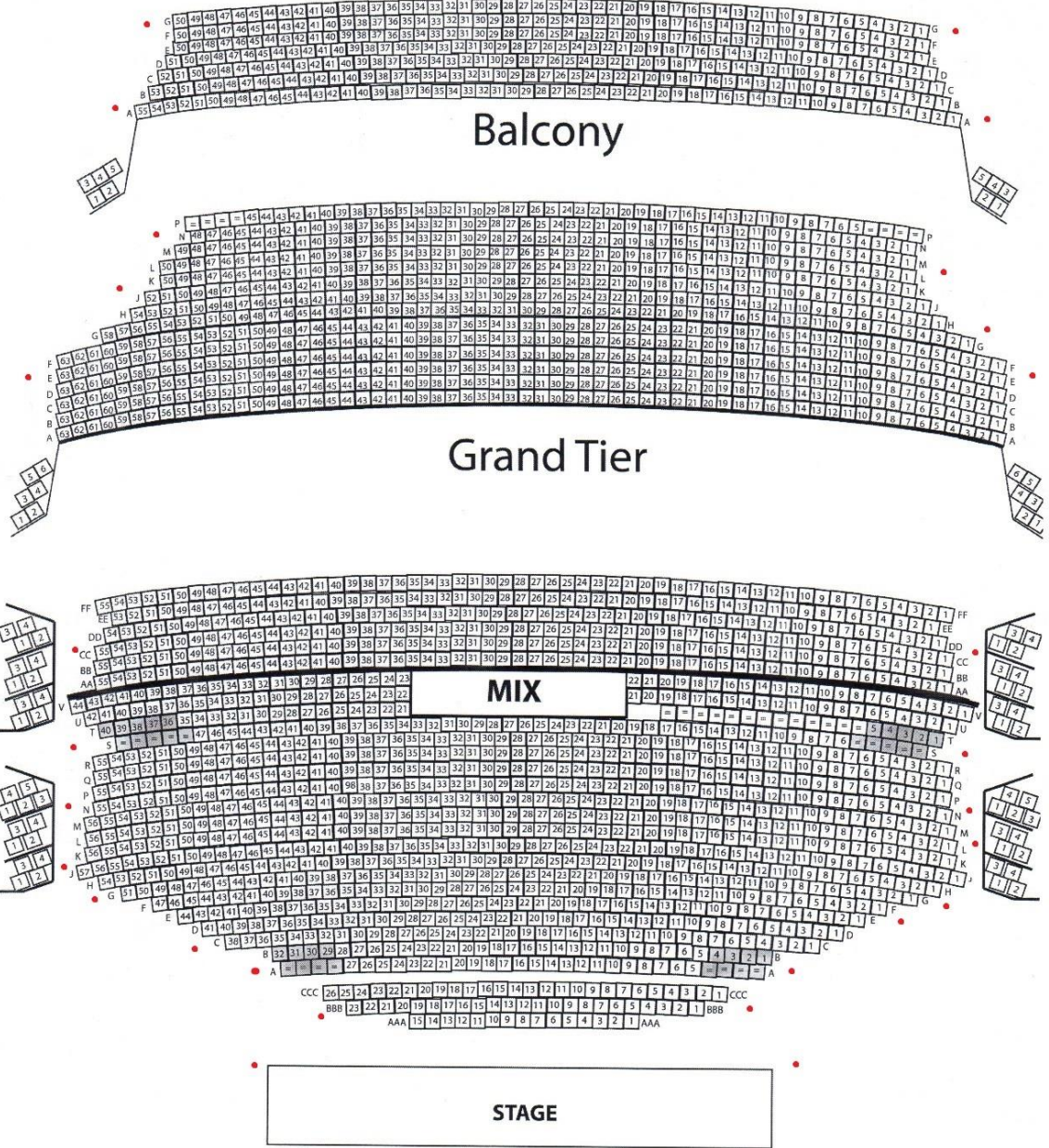

Ground Plan

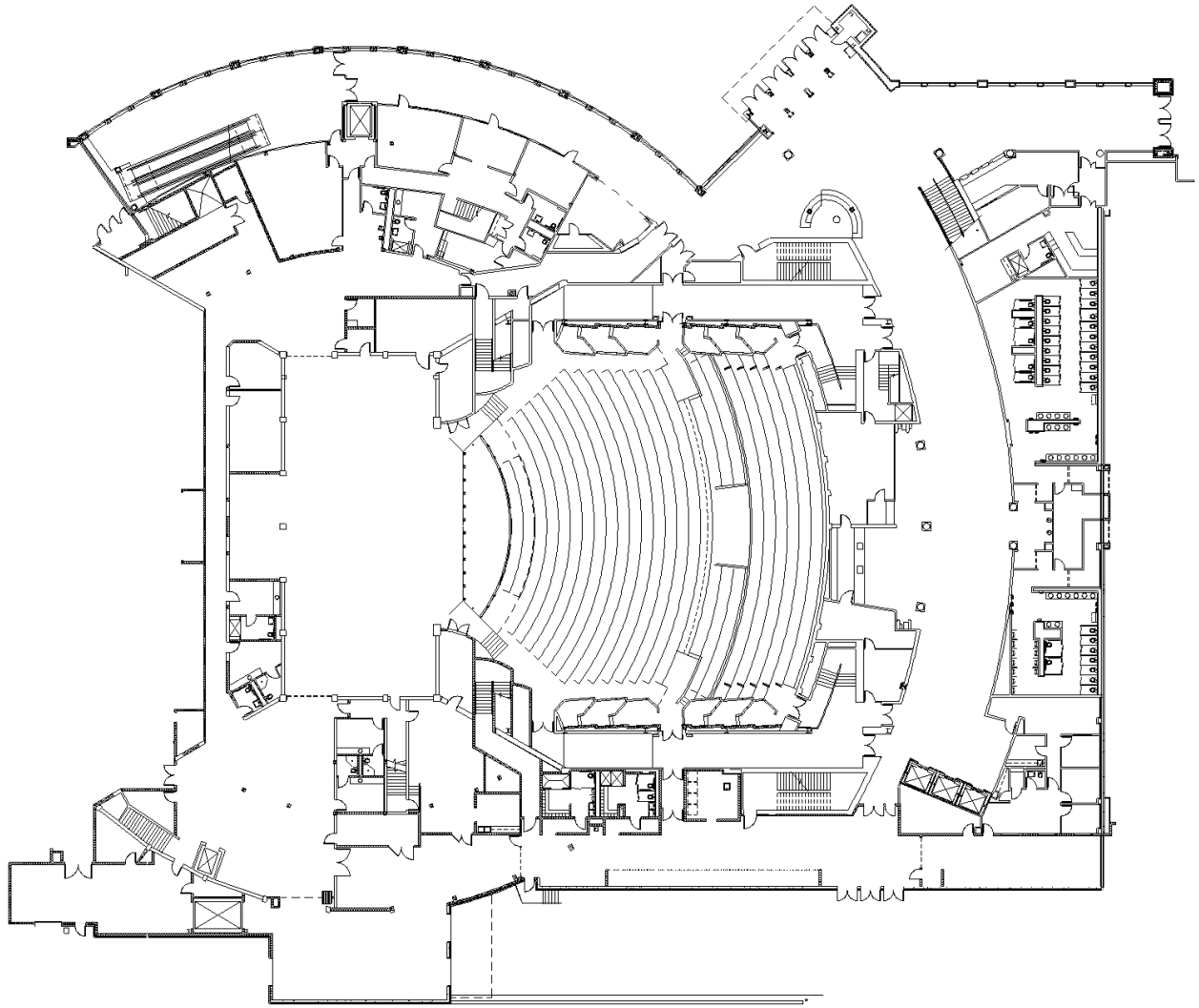

Section View





DRESSING ROOMS

Room #	Location	Sink	Toilet	Shower
101	Off Right	1	1	1
102	Off Right	1	1	1
103	US Crossover	1	1	1
104	US Crossover	1	1	1
105	Off Left	1	1	1
LL1	Basement	1	1	1
LL2- chorus	Basement	3	3	3
LL3	Basement	1	1	1
LL4- chorus	Basement	3	3	3
LL5	Basement	1	1	1
LL6	Basement	1	1	1
LL7	Basement	1	1	1

PRODUCTION ROOMS

Room	Location	Notes
Wardrobe	Off Right	2 washers, 2 dryers
Production office	US Crossover	Hardline internet available
Tech office	US Crossover	
Orchestra room	Basement	





MISCELLANEOUS INFORMATION

Box Office

Tickets sold through our box office or Ticket Master (www.ticketmaster.com)

Box Office Phone: 812-435-8200

Regular Hours: 10am – 5pm, Monday – Friday

Food and Beverage

SAVOR... exclusive catering

All catering serviced in house. Menus must be prearranged and can accommodate almost any request.

Hotels

Name	Address	Phone #	Distance
DoubleTree by Hilton	601 Walnut St Evansville, IN 47708	812-423-5002	.1 mile
Tropicana Evansville	421 NW Riverside Dr Evansville, IN 47708	812-433-4000	1.0 mile
Le Merigot	615 NW Riverside Dr Evansville, IN 47708	812-433-4700	1.0 mile
Hampton Inn Evansville Airport	5701 US-41 Evansville, IN 47711	812-464-1010	6.1 miles
Holiday Inn Evansville Airport	7101 US-41 North Evansville, IN 47725	812-867-7999	6.5 miles

