

# TECHNICAL SPECIFICATIONS

CHARLES F. DODGE  
CITY CENTER  
PEMBROKE PINES

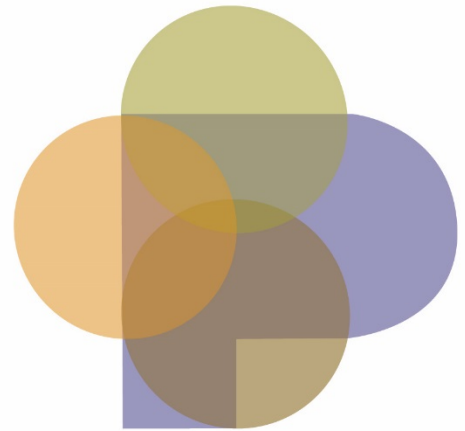

601 SW City Center Way  
Pembroke Pines, Florida 33025  
TELEPHONE: 954.392.9480  
[www.charlesfdodgecitycenter.org](http://www.charlesfdodgecitycenter.org)

# CHARLES F. DODGE CITY CENTER PEMBROKE PINES TECHNICAL SPECIFICATIONS

UPDATED: September, 2019

## TABLE OF CONTENTS

GENERAL CONTACT INFORMATION .....	3
MAP & DIRECTIONS.....	4
TRUCK, BUS & VEHICLE PARKING .....	7
SEATING CHART .....	9
PHOTOS.....	11
STAGE DIMENSIONS .....	15
RIGGING SPECIFICATIONS.....	15
GENIE LIFT .....	17
SOFTGOODS INVENTORY .....	18
SOUND .....	19
PROJECTIONS.....	20
LIGHTING INFORMATION AND POWER DISTRIBUTION .....	21
FIRE WATCH.....	23
VEHICLE REQUIREMENTS, GREAT HALL AND PLAZA.....	23
DRESSING ROOM / GREEN ROOM / MEETING ROOM INFORMATION .....	24
HOTEL INFORMATION / SHOPPING / HOSPITALS .....	25



## Address & Telephone Information

CHARLES F. DODGE CITY CENTER  
601 SW City Center Way  
Pembroke Pines, FL 33025

Main Number: 954-392-9480  
Box Office: 1-800-745-3000 Ticketmaster  
Front Desk/Security: 954-450-1060

### GENERAL MANAGER

General Manager Steve Clark 954-392-2136 [Sclark@ppines.com](mailto:Sclark@ppines.com)

### OPERATIONS, FACILITIES AND PRODUCTION

Operations Manager Marie Boudreau 954-392-9483 [Mboudreau@ppines.com](mailto:Mboudreau@ppines.com)

### EVENT SERVICES

Event Services Manager Rolando Silva 954-392-9482 [Rsilva@ppines.com](mailto:Rsilva@ppines.com)

### SALES AND MARKETING

Director Sandra Daley-Francois 954-392-2137 [Sdaleyfrancois@ppines.com](mailto:Sdaleyfrancois@ppines.com)

### BOX OFFICE

Ticketmaster 800-745-3000 [www.ticketmaster.com](http://www.ticketmaster.com)

## MAP & DIRECTIONS

The Charles F. Dodge City Center Pembroke Pines, 601 SW City Center Way, Pembroke Pines, FL 33025 is conveniently located in the City of Pembroke Pines, Broward County and can be reached by several routes.

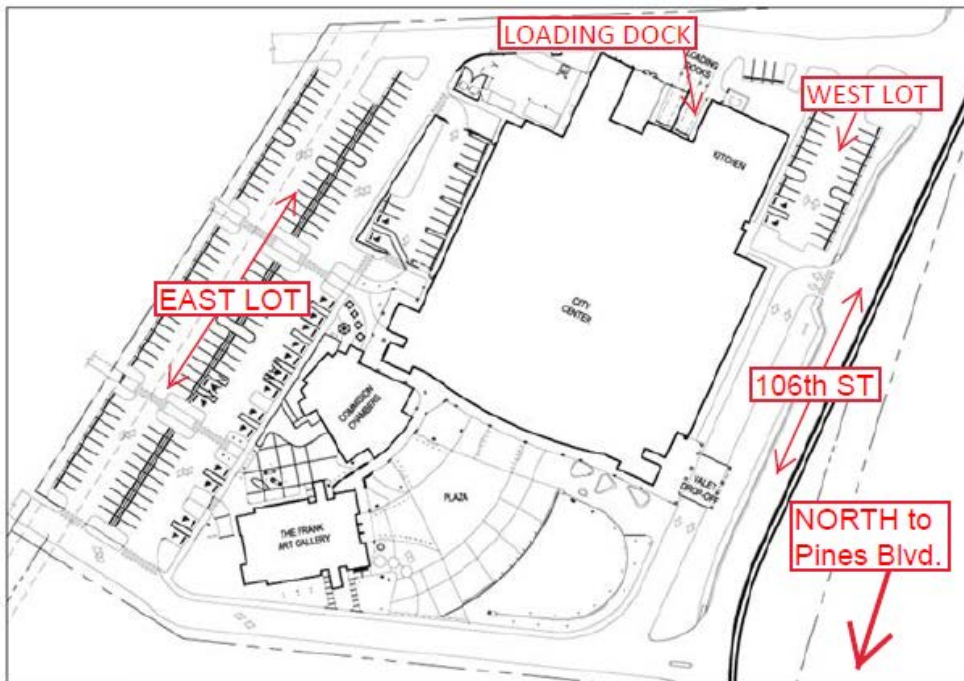
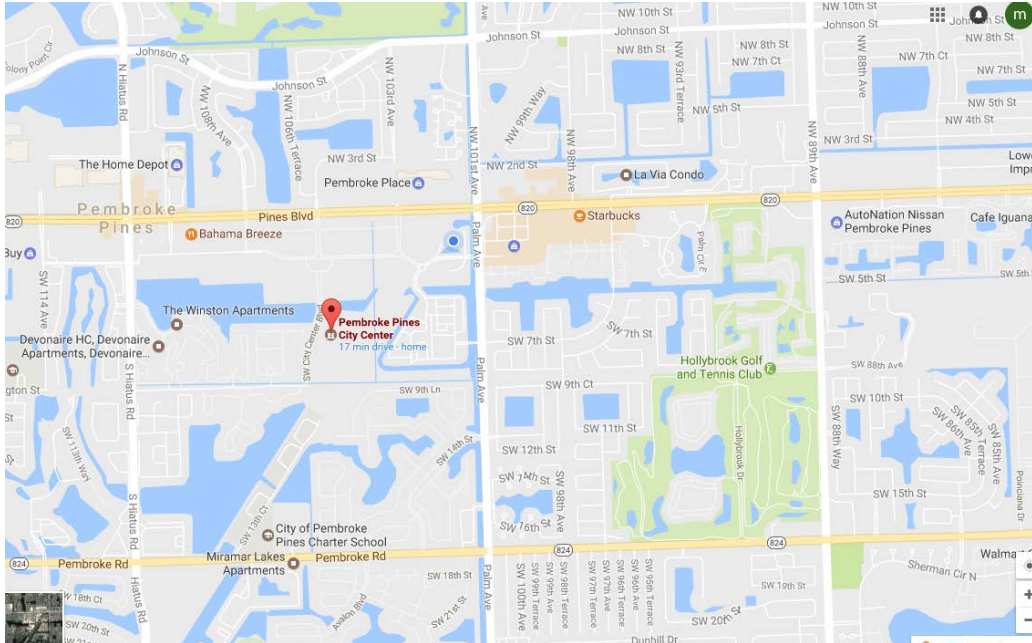

## **From North to Loading Dock:**

### **From I-75:**

Take exit 9A, Pines Blvd East/FL-820 East, Head East  
Turn right at Hiatus Road  
Turn Left on Washington Street  
Turn Left on 106<sup>th</sup> Street  
The Charles F. Dodge City Center will be on your right  
Car Parking is on the East side of the Building  
Loading dock is on the South side of the Building  
Bus Parking is in the SouthWest Parking lot (next to the building)

### **From Florida's Turnpike:**

Take exit 49, Pines Boulevard West  
Turn Left at Hiatus Road  
Turn Left on Washington Street  
Turn Left on 106<sup>th</sup> Street  
The Charles F. Dodge City Center will be on your right  
Car Parking is on the East side of the Building  
Loading dock is on the South side of the Building  
Bus Parking is in the SouthWest Parking lot (next to the building)

### **From I-95:**

Take exit 20, Hollywood Boulevard/SR820 West  
Turn Left at Hiatus Road  
Turn Left on Washington Street  
Turn Left on 106<sup>th</sup> Street  
The Charles F. Dodge City Center will be on your right  
Car Parking is on the East side of the Building  
Loading dock is on the South side of the Building  
Bus Parking is in the SouthWest Parking lot (next to the building)

## **From South to Loading Dock:**

### **From I-75:**

Take exit 9A, Pines Blvd East/FL-820 East, Head East  
Turn Right at Hiatus Road  
Turn Left on Washington Street  
Turn Left on 106<sup>th</sup> Street  
The Charles F. Dodge City Center will be on your right  
Car Parking is on the East side of the Building  
Loading dock is on the South side of the Building  
Bus Parking is in the SouthWest Parking lot (next to the building)

**From Florida's Turnpike:**

Take exit 43, Red Road North  
Turn Right at Hiatus Road  
Turn Right on Washington Street  
Turn Left on 106<sup>th</sup> Street  
The Charles F. Dodge City Center will be on your right  
Car Parking is on the East side of the Building  
Loading dock is on the South side of the Building  
Bus Parking is in the SouthWest Parking lot (next to the building)

**From I-95:**

Take exit 20, Hollywood Boulevard/SR820 West  
Turn Left at Hiatus Road  
Turn Left on Washington Street  
Turn Left on 106<sup>th</sup> Street  
The Charles F. Dodge City Center will be on your right  
Car Parking is on the East side of the Building  
Loading dock is on the South side of the Building  
Bus Parking is in the SouthWest Parking lot (next to the building)

## TRUCK, BUS & VEHICLE PARKING

Truck & Bus parking is Available on site. Please see below maps and directions for all parking needs.

Truck Parking is at the loading dock on the South side of the building.

The Charles F. Dodge City Center has one flat dock available for Truck Parking.

Bus Parking is in the West lot adjacent to the facility.

There are 5 available shore power outlets in the West parking lot.

Please see Electrical Distribution for more information and photos.

Feel free to contact Rolando Silva, Events Manager, for any questions prior to arrival.

Phone: 954-392-9482 Email: [rsilva@ppines.com](mailto:rsilva@ppines.com)

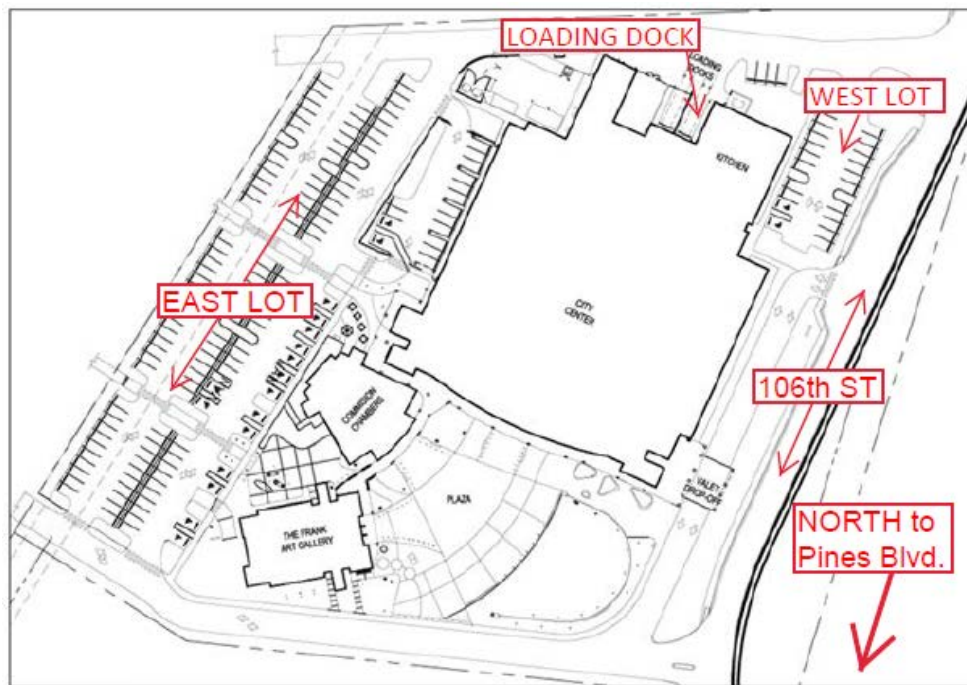

## CHARLES F. DODGE CITY CENTER PEMBROKE PINES

The Charles F. Dodge City Center Pembroke Pines is Mixed Use Facility that can support Concerts, Dance, Conventions, Expos, Meetings and Banquets of various sizes.





# GREAT HALL: ORCHESTRA LEVEL & MEZZANINE LEVEL SEATING CAPACITY: 3,204 60' wide x 24' deep Stage

\*This configuration does not support the use of the Main Curtain or DS legs

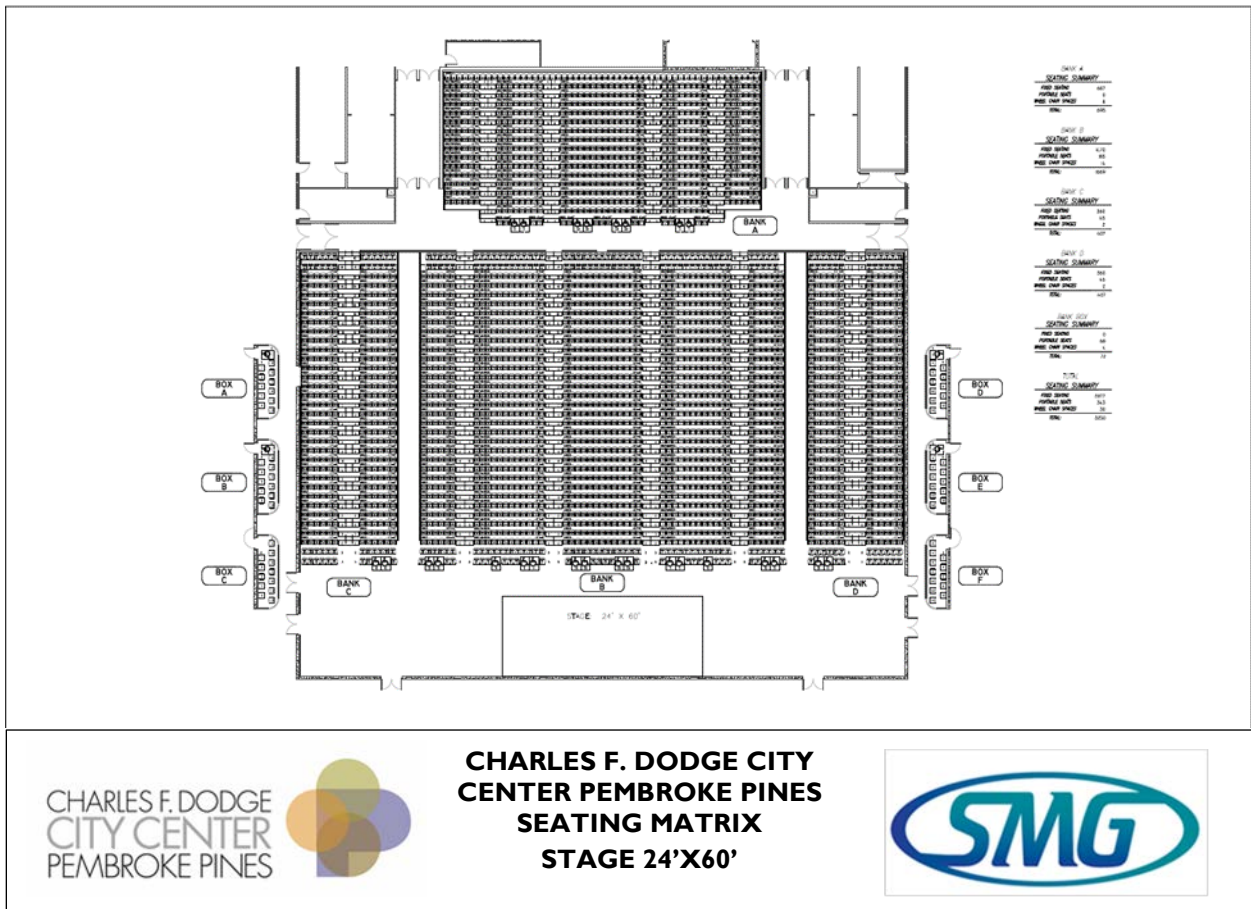

## PHOTOS:

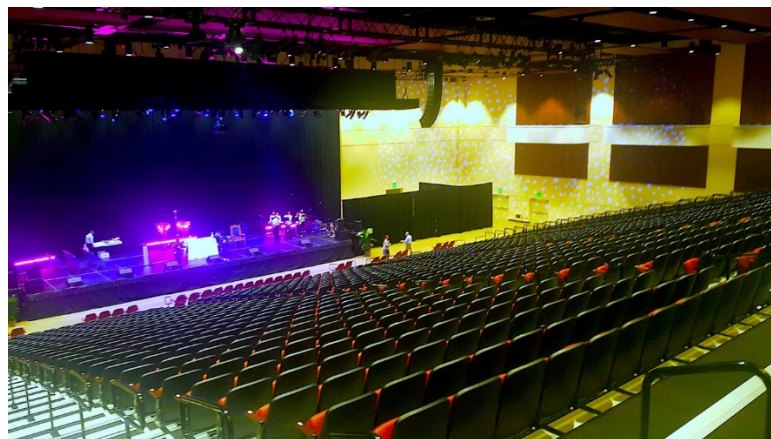



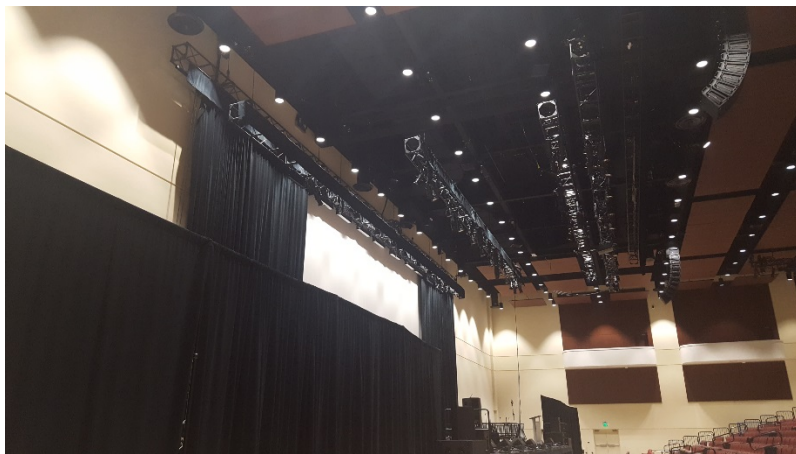



## STAGE SPECIFICATIONS

### (Theatrical Configuration 40'-00" X 60'-00" Stage)

BLACK TECHSTAGE BY STAGERIGHT	40' x 60' x 48"
HEIGHT OF STRUCTURAL HIGH STEEL	80'
(High Steel is not rated for weight)	
(Requires 80' Reticulated Boom Lift to Reach)	
HEIGHT OF STRUCTURAL LOW HANGING STEEL	41' 6"
LOCATION OF HOUSE RIGGING POINTS	See Page 16/17
DEPTH OF STAGE	40'
WIDTH OF STAGE	60'
APRON	N/A
HEIGHT OF STAGE (seating level to stage level)	48"
BACK WALL OF MEZZANINE LEVEL TO CYC	190'
TECH BOOTH TO FRONT EDGE OF STAGE	90'
TECH BOOTH TO CYC	130'
BACK WALL OF ORCHESTRA LEVEL TO CYC	130'
FOLLOWSPOT BOOTH TO EDGE OF STAGE	60'
FOH ELECTRICS TRUSS TO EDGE OF STAGE	30'

## RIGGING SPECIFICATIONS

HEIGHT OF STRUCTURAL LOW HANGING STEEL	41' 6"
HEIGHT OF STRUCTURAL HIGH HANGING STEEL	80'
(High Steel is not rated for weight)	
(Requires 80' Reticulated Boom Lift to Reach)	
LOCATION OF RIGGING POINTS	VARIOUS
OVER STAGE MOTOR POINTS	VARIOUS
OVER STAGE MOTOR POINT POWER/CONTROL	USL
OVER STAGE TRUSS LOCATION	See Page 16/17
OVER HALL MOTOR POINTS	See Page 16/17
OVER HALL MOTOR POINT POWER	USL
PA LOCATION AND POINTS	40' FROM US WALL/30' OFF CENTER L/R
HEIGHT OF ACOUSTICAL CEILING PANELS	VARIES

## LOCATION OF HOUSE RIGGING POINTS IN AQUA PDF / CAD OF DRAWING AVAILABLE BY REQUEST

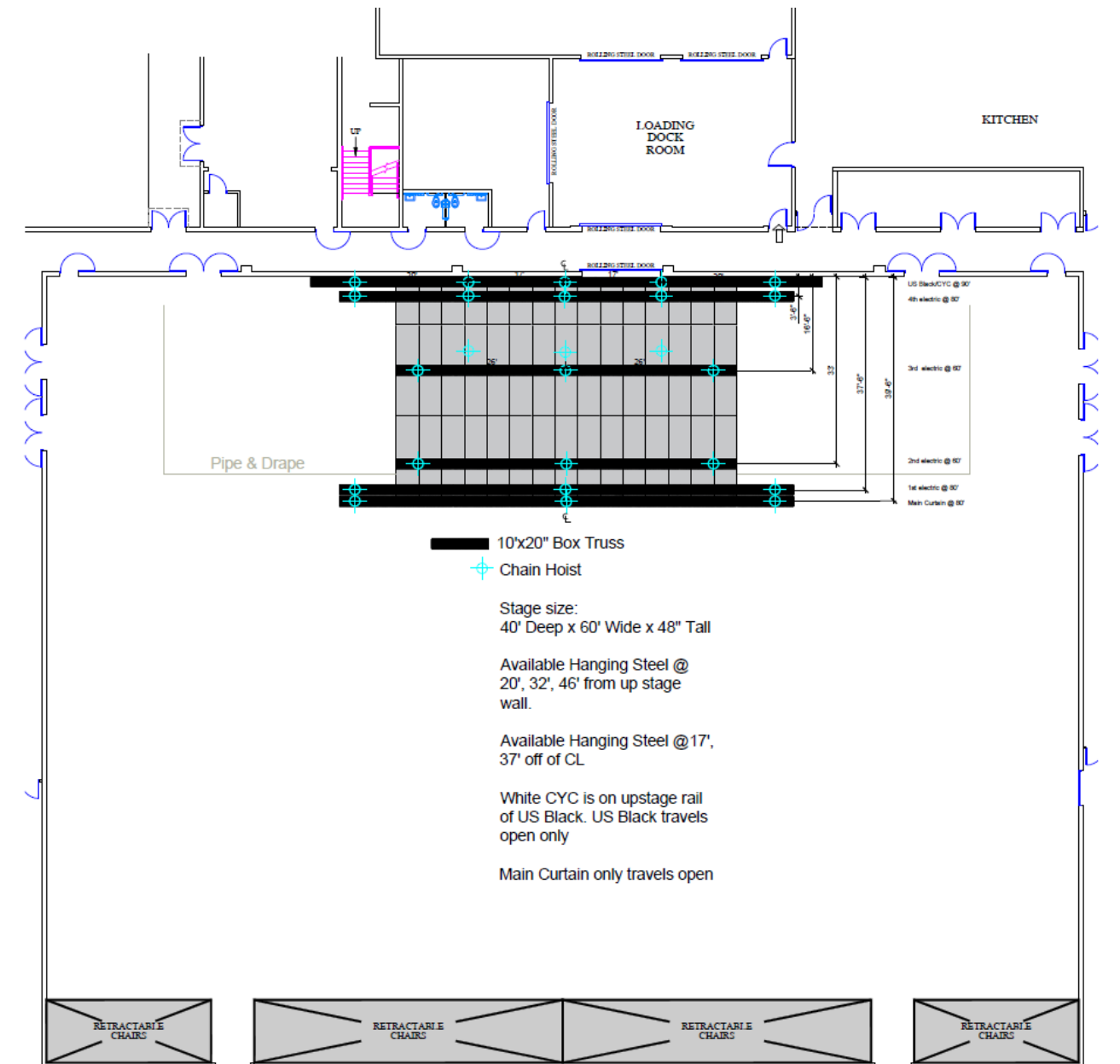

## TRUSS AND MOTOR SPECIFICATIONS

Please note that supplies and motors are used in the house Lighting Plot and Drape Package and are unavailable.

**\*All Rigging is Exclusive to the Charles F. Dodge City Center**

51	20.5" x 10' Thomas box truss plated black w/hardware
8	12" x 4' Thomas box truss plated black w/hardware
8	12" x 8' Thomas box truss plated black w/hardware
8	Truss Base B4620
27	1 T Stagemaker 16FPM
10	1/4 T Stagemaker 16 FPM
2	150' Fly Cable Assembly
15	100' Fly Cable Assembly
15	75' Fly Cable Assembly
20	50' Fly Cable Assembly
5	25' Fly Cable Assembly
2	Skonjberg hoist control system 8 way
2	Skonjberg P8-CS-SQ-D remote pendant w/ 50' cable
4	50' feeder sets #2
4	25' feeder sets #2

## Rigging Supplies

25	4' spanset Black 5300LBS Vertical
10	9' spanset Black 5300LBS Vertical
10	4' web slings UUI202NIX04
10	9' web slings UUI202NIX09
10	4' Sling Steeltex 5300LBS Vertical
10	9' Sling Steeltex 5300LBS Vertical

## Genie Man Lift / Forklift ETC

- I Genie AWP One Man Lift:
  - 40'-04" platform height
  - 46'-04" working height
- I Scissor Lift:
  - 39'-00" platform height
  - 45'-00" working height
- I Forklift: 6,000lb Electric

## PORTABLE WHEELCHAIR LIFT

Available upon request

## MAIN CURTAIN

The Main Curtain is a manual center split velour curtain located at the DS edge of the stage/platforming. **As The Charles F. Dodge City Center is a No-Fly House, the main curtain can only manually travel open and closed side to side.**

## SOFT GOODS INVENTORY

- I Black Main Curtain - 25 oz. IFR Velour (2) sections Bi parting main drape 31' high x 60' with 3' overlap 75% fullness  
**As The Charles F. Dodge City Center is a No-Fly House, the main can only travel open and closed.**
- I Main valance 6' x 60' 75% fullness
- I Bi parting black traveler 31' high x 88' wide with 3' overlap flat 25oz Charisma
- 4 Leg Curtains (pairs) – Black IFR Velour each 31' high x 10' wide
- 4 Border Curtains – Black IFR Velour 24" high x 60' wide
- I White Cyclorama-IFR- 31' high x 60' wide
- 40 PBS 0010 bases
- 20 VER 0037 9 to 16 poles
- 20 VER 0033 7 to 12 poles
- 25 12' high x 8' wide portable drapery 20oz Crescent
- \*Please note that all Pipe and Drape listed above is in use and unavailable
- 10 Aluminum Bottom Pipe 10' sections

## RISERS (In Addition to stage risers)

- 12 Wenger Versa Decks (4'x 8' with adjustable heights: 8", 16", & 24")
  - 2 Adjustable step units 16" or 24"
- Black skirting and railings are available for risers

## PIANO

The Charles F. Dodge City Center does not have a Piano on Site. Pianos can be rented through a variety of locations.

**\*Please note that Drone usage is not allowed in the City Center due to Beam Detectors. If the beam is broken, the fire alarm will go off.**

## **SOUND AND COMMUNICATIONS**

### **SPEAKER CONFIGURATION**

The House has Full Meyer Sound main system and subsequent side balcony fills and delay speakers. FOH Cluster is permanently hung right and left. Each cluster is self-powered and uses a Meyer Galileo Speaker management system, and contains:

House-Left / House-Right PA –  
4 Flow Sub 900LFC Meyer Sound 09.246.001.01  
20 Leopard Meyer Sound 09.243.001.01  
5 UPQ-IP Side/Delay Meyer Sound 09.185.001.01

### **FRONT FILL / SUBS**

6 UPM-1p Front Fill Meyer Sound 09.084.001.01  
6 Floor Sub 1100LFC Meyer Sound 09.220.001.05

### **SOUND MIX POSITION**

Rear Center Orchestra

### **CONTROL**

Q-sys and Dante Control Systems

### **FRONT OF HOUSE CONSOLE**

Yamaha CL5

\*Due to the nature of this system, Rental / Touring Consoles must send outputs to the house console

\*A clean copy of both FOH and Monitor console patch is available by request.

### **MONITOR CONSOLE**

Yamaha CL5

### **STAGE MONITORS**

10 Meyer Dual 8" MJF 208 Meyer Sound 09.235.001.11  
4 Meyer Stage Sub 900 LFC  
4 Meyer UPQ-2P Sidefill Meyer Sound 09.190.001.01

### **MISCELLANEOUS:**

6 Whirlwind 12 channel subsnakes  
8 DI's  
1 Tascam CD-200SB CD Players

### **MICROPHONES:**

2 Shure SM 57  
2 Shure SM 58

2 Shure SM 81

\*Full Microphone rental package available for additional cost

**WIRELESS MICROPHONES:** *(additional rental cost)*

3 SHURE ULXD4Q Quad Digital Receivers

10 Shure UH2/ BETA 87A Handheld Microphones

6 Sennheiser MD421

6 DPA Microphones 4061-B54 Lapel Microphone

**PROJECTION** *(additional rental cost)*

2 Christie HD14K-M Projectors

2 Christie Lens Short Throw

\*Projector is hung on the 1<sup>st</sup> Electric and focused on the US White Cyc

2 Draper RP fast fold – Medium 10'-0" x 18'-0"

1 Draper RP fast fold – Large 13'6" x 24'-0"

2 ViewSonic 3600 Lumen Short Throw Projectors

2 100" 16 x 9 Pull Up Projection Screens (4' x 7' Projection Surfaces)

**COMMUNICATIONS**

4 Clear Com Wireless Tempest Units

Numerous Clear Com Belt pack and Headsets, Wired

## LIGHTING INFORMATION

Charles F. Dodge City Center Pembroke Pines is equipped with an extensive general "house" lighting plot. It comes focused and colored as per that plot. Any refocusing of equipment during the load-in must be restored during the load-out and the cost of the restore will be included in show settlement.

## ELECTRICAL INFORMATION

### Power Distribution/Company Switches

**Bus Parking West** – 5 multi-function 60 amp boxes and are equipped with a 3 blade dryer plug, a 4 blade dryer plug and Edison Outlets.



**Loading Dock South** – No Company Switches Available in the Loading Dock. Power can be run to the loading dock from various locations.

**Stage Left US Wall** - 100A, 200A, 200A Powersafe Pro Company Switch with CamLock Connections

**Stage Right US Wall** - 100A, 400A, 400A, 400A Powersafe Pro Company Switch with CamLock Connections



\*All Company Switches are Independently Grounded

\*One SL 200A Switch is in use for Motor Control

\*One SR 100A Switch is in use for Monitor World

## THEATRICAL LIGHTING

Overhead lighting plot consists of 12 automated fixtures, 40 LED Pars, and various conventional lighting units on a typical 4 electric setup. Plot must be used as hung. Due to rigging limitations it is cost prohibitive to alter the hang on the overhead electrics. **Please specify if your production will require a lighting designer or if additional time is needed for show specific cueing.** Additionally, there are a number of conventional units to be used from the FOH hanging position.

## CONTROL

1 ION Console, 1024 Outputs w/2-Touchscreen Monitors  
192 2.4k ETC Sensor dimmers

## FOLLOWSPOTS *(additional rental cost)*

4 2K Xenon Followspots located in the Followspot Booth

## LIGHTING INVENTORY

Charles F. Dodge City Center Pembroke Pines has a permanent repertory light plot; therefore most of the inventory is hanging

QTY	MFG.	DESCRIPTION
20	ETC Source 4	10 deg. 750w, 115V
20	ETC Source 4	14 deg. 750w, 115V
12	ETC Source 4	19 deg. 750w, 115V
20	ETC Source 4	26 deg. 575w, 115V
60	ETC Source 4	36 deg. 575w, 115V
18	ETC Source 4	50 deg. 575w, 115V
60	Colorado Quad 2 Zooms	
18	Vivid-R Strip Lights	
12	MAC Viper Profile	

## LIGHTING / STAGE EFFECTS

Charles F. Dodge City Center Pembroke Pines is not equipped with any special effects equipment, *(Additional rental costs may apply.)*

## STAGE LABOR

**Above the Mark** is the preferred supplier of Stage Labor and technical services at the Center. <https://abovethemarkinternational.com/>

If an outside A/V supplier is contracted, the Event Manager will need to be notified. All Rigging is exclusive to Above the Mark.

## AUDIO VISUAL EQUIPMENT RENTAL

Please contact: Marie Boudreau, [Mboudreau@ppines.com](mailto:Mboudreau@ppines.com) for assistance.

## FIRE PREVENTION / EMT SERVICES CITY OF PEMBROKE PINES

**Please note that the use of Haze or any other special effect will require a Fire Marshal to be on site for the entire time Haze or effects are in use. Fire Marshal costs are at Prevailing Rates and a 4 hour minimum.**

Fire Rescue Inspectors are contracted for any performance or event that uses open flame, smoke, haze or pyrotechnic effects. Fire Watch requests should be provided as part of the advance, and should be submitted to Production no later than 4 weeks prior to the date of the event.

Fire watch will not be needed if you choose to use the Charles F. Dodge City Center hazers. They have been approved by Fire.

EMT services are will be determined based on event type.

## VEHICLES ON PLAZA OR INSIDE THE GREAT HALL REQUIREMENTS:

### GREAT HALL:

Vehicles must have no more than 1/4 of a tank of gas.

Vehicles must have the battery disconnected and have the terminals taped off.

The gas cap must be taped shut

Vehicles must have a carpet / drop cloth underneath the oil pan to prevent spills.

\*If you do not provide a carpet / drop cloth and there is a spill, you will be charged a cleaning fee at settlement.

Vehicles must be no larger than 10' wide by 10' tall (including antennas).

Vehicles may not be started or moved during the entirety of the event.

### PLAZA:

Vehicles must have a carpet / drop cloth underneath the oil pan to prevent spills.

\*If you do not provide a carpet / drop cloth and there is a spill, you will be charged a cleaning fee at settlement

At no time is tire to concrete contact allowed. Please bring tire socks, plywood, or cardboard. \*A cleaning fee will be charged at settlement if tire marks are found on plaza.

## DRESSING ROOM / WARDROBE / GREEN ROOM INFORMATION

### DRESSING ROOMS:

All dressing rooms are located on the first floor of the Charles F. Dodge City Center Pembroke Pines. All Dressing rooms are equipped with showers, toilets, mirrors and chairs. Rolling costume racks (Z-Racks) are available. There is 1 star dressing room and 2 larger dressing rooms available.

Dressing Room #	Number of People	Dimensions
Room	2 Persons (Star)	12' W x 13' L
Room 1	15	13' W x 30' L
Room 2	12	13' W x 24' L
Green Room/Prod. Office	18	13' W x 24' L

Any changes to the positioning or configuration of furniture must be discussed ahead of time and taken into consideration in both production schedule and budget.

### WARDROBE ROOM: None Available

### LAUNDRY ROOM: None Available

### WASHER/DRYER AVAILABLE UPON REQUEST

The Charles F. Dodge City Center has 1 washer / dryer available upon request.

### MEETING ROOMS: *(additional rental cost)*

A-101	42'x28'	In Lobby	Max. Capacity 80
A-102	43'x28'	In Lobby	Max. Capacity 80
B- 203	28'x13'	2 <sup>nd</sup> Floor East	Max. Capacity 20
B- 204	28'x13'	2 <sup>nd</sup> Floor East	Max. Capacity 20
B- 205	24'x13'	2 <sup>nd</sup> Floor East	Max. Capacity 20
B- 206	28'x14'	2 <sup>nd</sup> Floor West	Max. Capacity 20
B- 207	28'x14'	2 <sup>nd</sup> Floor West	Max. Capacity 20
B- 208	28'x14'	2 <sup>nd</sup> Floor West	Max. Capacity 20
B- 210	18'x28'	2 <sup>nd</sup> Floor West	Max. Capacity 34

## **LOCAL SERVICES**

### **GROUND TRANSPORTATION**

Yellow Cab  
954-777-7777

A Personal Touch Limousine Service  
800-741-2785  
<http://www.aplimo.net/>

Wall Street Transportation & Limousine  
954-946-3878

### **HOTEL INFORMATION**

Hampton Inn & Suites  
10990 Marks Way  
Miramar, FL 33025  
954-430-5590  
[www.hilton.com/Hampton\\_Inn/Miramar](http://www.hilton.com/Hampton_Inn/Miramar)

Courtyard by Marriott Fort Lauderdale SW/Miramar  
14500 SW 29th St  
Miramar, FL 33027  
954-450-1801  
[www.marriott.com](http://www.marriott.com)

Ritz-Carlton Fort Lauderdale  
1 North Fort Lauderdale Beach Boulevard Fort  
Lauderdale, FL 33304  
954-465-2300  
[www.ritzcarlton.com/fortlauderdale](http://www.ritzcarlton.com/fortlauderdale)

Gallery One Fort Lauderdale, A Doubletree Suites by Hilton  
2670 East Sunrise Boulevard  
Fort Lauderdale, FL 33304  
954-565-3800  
[www.galleryone.doubletree.com](http://www.galleryone.doubletree.com)

Hampton Inn Pembroke Pines  
1900 NW 150 Avenue  
Pembroke Pines, FL 33028



954-441-4242

[www.hilton.com/Hampton\\_Inn/Pembroke\\_Pines](http://www.hilton.com/Hampton_Inn/Pembroke_Pines)

Holiday Inn Express & Suites

14651 NW 20th St

Pembroke Pines, FL 33028

954-430-9404

[https://www.ihg.com/holidayinnexpress/hotels/us/en/pembroke-pines/flpp/hoteldetail?cm\\_mmc=GoogleMaps\\_-\\_EX\\_-\\_USA\\_-\\_FLLPP](https://www.ihg.com/holidayinnexpress/hotels/us/en/pembroke-pines/flpp/hoteldetail?cm_mmc=GoogleMaps_-_EX_-_USA_-_FLLPP)

Fairfield Inn & Suites

1650 SW 145th Ave

Pembroke Pines, FL 33027

954-447-9662

<http://www.marriott.com/hotels/travel/flpe-fairfield-inn-and-suites-fort-lauderdale-pembroke-pines/?scid=bb1a189a-fec3-4d19-a255-54ba596febe2>

Wingate by Wyndham Miramar

2800 South West 149th Ave

Miramar, FL 33027

954-374-7604

<https://www.wyndhamhotels.com/wingate/miramar-florida/wingate-by-wyndham-miramar/overview?CID=LC:WG::GGL:RIO:National:10586&iata=00065402>

Grand Palms Hotel, Spa and Golf Resort

110 Grand Palms Drive

Pembroke Pines, FL 33027

954-431-8800

<http://www.grandpalmsresort.com/>

Hilton Garden Inn Ft. Lauderdale SW/Miramar

14501 Hotel Rd

Miramar, FL 33027

954-438-7700

<http://hiltongardeninn3.hilton.com/en/hotels/florida/hilton-garden-inn-ft-lauderdale-sw-miramar-FLLSWGI/index.html>

Residence Inn Fort Lauderdale SW/Miramar

14700 Hotel Rd

Miramar, FL 33027

954-450-2717

<http://www.marriott.com/hotels/travel/flmr-residence-inn-fort-lauderdale-sw-miramar/?scid=bb1a189a-fec3-4d19-a255-54ba596febe2>

## **BANKING**

Bank of America  
2300 Miramar Parkway  
Miramar, FL 33025  
954-744-8740

Wells Fargo  
12184 Miramar Parkway  
Miramar, FL 33025  
954-432-9740

Chase  
11100 Pembroke Road  
Miramar, FL 33025  
954-437-0146

PNC  
9479 Sheridan Street  
Hollywood, FL 33024  
954-392-0702

Regions  
8020 Pines Boulevard  
Pembroke Pines, FL 33024  
800-734-4667

SunTrust  
10000 Taft Street  
Pembroke Pines, FL 33024  
954-624-7800

BB&T  
11200 Pines Boulevard  
Pembroke Pines, FL 33026  
954-431-8305

Citi  
8411 Pines Boulevard  
Pembroke Pines, FL 33024  
800-734-4667



## **DINING & SHOPPING**

The Pembroke Lakes Mall is less than 2 miles from the Charles F. Dodge City Center Pembroke Pines. There are numerous restaurants, both fast food and sit down, in the surrounding vicinity.

In addition, The Shops at Pembroke Gardens are less than 5 miles from the City Center. There are a multitude of Shops, Boutiques and Dining.

## **HOSPITALS AND URGENT CARE**

MDNow Urgent Care  
9650 Pines Blvd  
Pembroke Pines, Florida 33024  
954-885-9009 or 888-mdnow-911

Memorial Hospital West  
703 N Flamingo Rd  
Pembroke Pines, FL 33028  
954-436-5000