

#6

6-25-81

Floral Building

MAIN POWER SOURCE IS
FROM PANEL C CIRCUIT 40
125A 3 ϕ

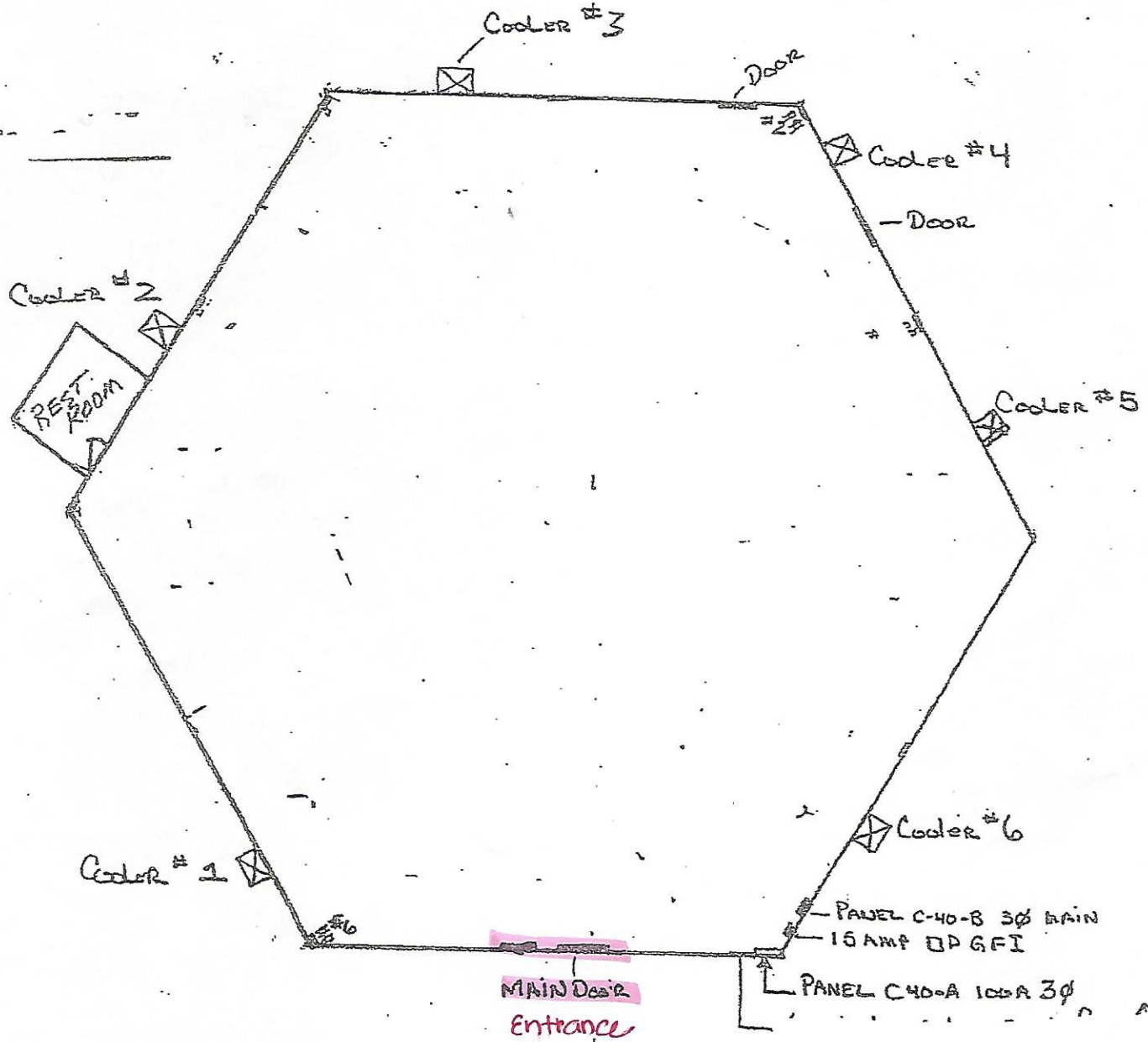
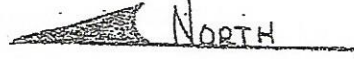

2) Emergency lighting above main main door

ALL DOORS MUST HAVE 20' CLEARANCE

ALL AISLES MUST HAVE 10' CLEARANCE

DO NOT BLOCK FIRE EXTINGUISHERS OR ELECTRICAL PANELS