

V&R PRO STOCK 2024

******THESE ARE THE RULES, THEY ARE NOT SUGGESTIONS. YOU MAY NOT DO ANYTHING THAT IS NOT SPECIFIED IN THE RULESET. THIS IS WHAT YOU MAY DO TO PREPARE YOU VEHICLE FOR THE DERBY. EVERYTHING NOT LISTED IN THIS RULESET CANNOT BE MANIPULATED OR ENHANCED, MUST REMAIN STOCK. IF YOU ARE UNSURE OF SOMETHING OR IF YOU HAVE ANY QUESTIONS PLEASE CALL BEFORE YOU DO IT!**

707-301-8324, -BOBBY RUTLEDGE
530-902-2069, -RALPH GARCIA
PLEASE ALLOW AT LEAST UP TO 24HRS FOR A RESPONSE

PREPARING YOUR CAR

- ALL GLASS MUST BE REMOVED.
- STOCK GAS TANK AND SPARE TIRE MUST BE REMOVED.
- BATTERY MUST BE REMOVED AND TRANSFERRED TO INSIDE OF CAR
- NO USE OF PLASTIC GAS TANKS, OR MILK CRATES FOR BATTERY BOX
- ALL ORIGINAL TRIM, HEADLIGHT AND TAIL LIGHT BEZELS MUST BE REMOVED.
- OFFICIALS RESERVE THE RIGHT TO HAVE YOU "CUT" OPEN OR INSPECT ANY PART OF THE VEHICLE BEFORE, DURING, OR AFTER EVENT.
- OFFICIALS DISCRETION IF FINAL
- CARS MUST REMAIN STOCK UNLESS OTHER SPECIFIED IN THESE RULES
- NO PAINTING OF FRAMES OR INTERIOR OF BODY
- ALL TRAILER HITCHES AND BRACES MUST BE REMOVED
- THE INTENT IS FOR THESE VEHICLES TO REMAIN STOCK ASIDE FROM THE MODIFICATIONS THAT ARE ALLOWED IN THE RULES.

CARS LEGAL TO RUN IN THE EVENT

- NO LIMOUSINES, VANS, HEARSE, MILITARY VEHICLES, OR PRE 1974 IMPERIALS WILL BE ALLOWED.
- ANY OTHER PASSENGER CAR NOT LISTED ABOVE WILL BE ALLOWED TO COMPETE, IF YOU HAVE QUESTIONS PLEASE ASK.

CAGE AND DOOR BARS RULES

- ALL CAGE BARS MUST BE STRAIGHT AND CANNOT CONTOUR ANY PART OF THE BODY.
- ALL CAGE BARS MUST BE MOUNTED INSIDE THE CABIN AREA NOT THREW DOORS OR PILLARS.
- ALL CROSS BARS MUST ONLY BE MOUNTED TO DOOR BARS.



- ALL BARS MUST BE 4" ABOVE THE HIGHEST POINT OF THE FLOORBOARD AND OR DOOR SILL, AND NOT HIGHER THAN THE TOP OF THE INSIDE OF THE DOOR.
- DOOR BARS MUST BE 3" AWAY FROM FRONT FIREWALL AND MAY TOUCH REAR WHEEL WELL HUMPS.
- DOOR BARS CANNOT EXTEND PAST THE FRONT MOST PART OF THE INTERIOR WHEEL WELL SHEETMETAL (OFFICIALS DISCRETION)
- YOU MAY EITHER RUN A 3 CROSS BAR SYSTEM WITH NO GAS TANK PROTECTOR, **OR** A 2 CROSS BAR SYSTEM **WITH** A GAS TANK PROTECTOR.
- FRONT DASH BAR MUST BE A MINIMUM OF 2X2X 1/4 WALL MATERIAL AND A MAXIMUM OF 6X6X 1/2 WALL, AND BE 12" BEHIND FIREWALL AND A MINIMUM OF 6" OFF THE HIGHEST PART OF THE TRANSMISSION TUNNEL, THIS BAR CANNOT COME INTO CONTACT WITH ANY OTHER PART OF THE CAR, WINDOW BARS AND/OR ENGINE.
- SEAT BAR MUST BE WITHIN THE BACK OF THE SEAT AND THE 3RD BAR OR END OF DOOR BAR.
- GAS TANK PROTECTORS MUST BE CENTERED IN WHEEL WELL HUMPS, MAY ONLY BE ATTACHED THE REAR SEAT BAR WITH THE EXCEPTION OF GUSSETS.
- GAS TANK PROTECTOR CANNOT EXCEED 30" OD, AND CANNOT EXCEED THE TOP OF THE GAS TANK MORE THAN 4".
- GAS TANK PROTECTOR MUST BE A MINIMUM OF 2" AWAY FROM **ALL** SHEET METAL, REAR PAN SHEET METAL **CANNOT** BE HAMMERED OR MOVED IN ANY DIRECTION MUST STAY FACTORY.
- GAS TANK PROTECTOR GUSSET BARS MAY BE MOUNTED TO HALO BAR AND DOOR BARS BUT MUST REMAIN 4" FROM **ALL** BODY PANELS, ALL BARS AND GUSSETS

CANNOT CONTOUR BODY PANELS UNLESS SPECIFIED, **THESE GAS TANK PROTECTOR RULES STILL APPLYS TO USED CARS.**

- HALO BARS MUST BE USED, MUST BE A MINIMUM OF 2X2X 1/4 PIPE OR SQUARE TUBING, AND MAXIMUM OF 6X6X 1/2", MUST BE CONNECTED TO ROOF IN AT LEAST 3 SPOTS WITH EITHER BOLTS OR WELDING. CAN BE WELDED ANYWHERE ON THE DOOR BAR.
- ALL HALO BAR MATERIAL MUST BE STRAIGHT AND NOT ANGLED, HALO BARS MAY ONLY BE ATTACHED TO DOOR BARS AND ROOF, MOUNTS ON ROOF CANNOT BE EXCEEDING PAST THE HALO BAR MORE THAN 3" IN ANY DIRECTION.
- ROOF SIGNS MUST BE USED, MAY BE WELDED TO ROOF, HALO BAR/ROOF SIGN CANNOT COME INTO CONTACT WITH ANY WINDOW BAR, CANNOT BE USED TO STRENGTHEN CAR OFFICIALS DISCRETION.
- YOU ARE ALLOWED X2 WINDOW BARS FOR WINDSHIELD AND X2 IN REAR WINDOW MUST NOT EXCEED 2"X2"X1/4" SQUARE TUBING AND MUST BE MOUNTED INSIDE OF WINDOW SEAM ONLY, WINDOW BAR MATERIAL MUST BE STRAIGHT ONLY. AND



CANNOT COME INTO CONTACT WITH ANY PART OF CAR EXCEPT SHEET METAL, CANNOT BE ATTACHED TO ALL THREAD.

- DOWN BARS MAY BE USED, YOU WILL BE ALOUD TO HAVE 2 DOWN BARS ON EACH SIDE OF CAR NOT TO EXCEED 2X2X1/4 SQUARE TUBING, **MUST ONLY BE ATTACHED TO DOOR BARS AND TOP OF FRAME OR**

FLOORBOARD AND MUST STAY VERTICAL.

- DOWN BARS CAN BE WELDED TO TOP OF FRAME RAIL, OR FLOOR BOARD SHEET METAL, WITH NO MORE THAN 7" TOTAL OF CONTINUOUS WELD. DOWN BARS CANNOT HAVE CONTACT/ OR BE WELDED TO ANY MOUNT OR BRACKET OF CAR OTHER THAN WHATS SPECIFIED IN RULES.
- IF WELDING DOWN BAR TO STEET METAL ONLY, YOU MAY USE A 3"X3"X. 1/4" LANDING PAD, PAD MAY NOT COME INTO CONTACT OR BE WELDED TO ANYTHING OTHER THAN SHEETMETAL

BUMPERS/BRACKETS

- BUMPER HEIGHT CAN BE NO MORE THAN 20" TALL, CAR WILL BE MEASURED FROM THE GROUND TO THE BOTTOM OF THE BUMPER.
- HOMEMADE/REPLICA BUMPERS MAY BE USED, IT CAN BE NO TALLER THAN 8" WITH A POINT OF 15", THE POINT MUST TAPER OVER AN AREA OF AT LEAST 32"
- SQUARE TUBE BUMPER ENDS MUST BE CAPPED FOR SAFTEY, ANY SHARP EDGES WILL BE CUT OFF OR SANDED SMOOTH FOR SAFTEY.
- ON OEM STYLE 5MPH BUMPERS THE CHROME SKIN MAY BE HAMMERED DOWN AND WELDED.
- BUMPERS MAY BE LOADED, BUT ALL WORK MUST BE DONE ON THE INTERIOR OF THE BUMPER

- YOU MAY CHOOSE ONLY 1 OF 3 OPTIONS OF BUMPER BRACKET MATERIAL BUT ALL MATERIALS CANNOT EXCEED 10" LONG AND 4" WIDE, BRACKETS CAN CONTOUR THE FRAME RAIL, AND MAY ONLY BE USED ON ANY OF THE 4 EXTERIOR SIDES OF THE FRAME, **CANNOT** BE STUFFED INSIDE.
- BRACKETS WILL BE MEASURED FROM THE BUMPER MOUNTING PLATE STRAIGHT BACK WITH THE TAPE MEASURE HELD STRAIGHT.
- 1ST OPTION IS A PIECE 10"X2"X4"X 1/4 SQUARE TUBING.
- 2ND OPTION 10X4X 1/2 FLAT PLATE, PLATE MAY HAVE 1 "TEEPEE" IN IT AND BEND CANNOT BE HIGHER THAN 1/2.
- 3RD OPTION IS OEM BRACKET OFF OF ANY CAR THAT IS LEGAL TO RUN TO THIS RULESET, IF USING THIS OPTION, BRACKET CANNOT BE MANIPULATED OR HARD FACED IN ANY WAY, BRACKET MUST BE CUT DOWN TO 10" LONG MAX (THIS INCLUDES WHERE ITS MOUNTED TO THE BUMPER TO THE END OF THE BRACKET).
- BUMPER BRACKETS MAY BE WELDED TO FRAME WITH NO MORE THAN 1/2" WELD, ANY EXCESSIVE WELD WILL BE DETERMINED BY THE OFFICIALS.
- YOU MAY WELD A 6X6X1/2" MOUNTING PAD ON THE BACK OF THE BUMPER.
- NO BUMPER BRACKET MAY BE WELDED TO ANY SUSPENSION PART OR BODY.



80'S AND NEWER

- 2003 AND NEWER CROWN VICS WITH ALUMINUM CROSSMEMBERS HAVE 1 OPTION FOR CROSSMEMBERS, NOTE THAT OPTION ONE CAN HAVE **NO** WELDING TO FRAME, EVERYTHING MUST BE BOLTED.
- YOU MAY BOLT A 3/8" PLATE OVER THE FACTORY STRUT TOWER AND CONNECT IT TO THE ALUM. CRADLE MOTOR MOUNT BOLT ACROSS TO THE OTHER SIDE TO MOUNT YOUR ENGINE (VIEW PICTURE AT END OF RULES). PLATE CONNOT TOUCH FRAME IN ANY WAY

- ALL SUSPENSION MAY BE SWAPPED WITH FACTORY PARTS FROM VEHICLES LEGAL TO RUN IN THIS EVENT (VIEW SUSPENSION SECTION FOR MORE INFO)
- YOU MAY TILT AT THE TRANSMISSION CROSSMEMBER ONLY! MAX 7" OF WELD

RADIATORS

- RADIATORS MUST BE MOUNTED IN FACTORY LOCATION.
- RADIATORS MUST BE ALUMINUM,COPPER,OR BRASS ONLY
- NO HOMEMADE RADIATORS.
- NO STEEL FAN SHROUDS.
- NO WELDING RADIATOR IN, MUST BE STRAPPED,BOLTED OR WIRED IN.
- YOU MAY RUN AN AC CONDENSER IN FRONT OF RADIATOR, MAY BE WELDED TO CORE SUPPORT A TOTAL OF 6"PER SIDE WITH 2" FLAT STRAP 1/8" THICK OR BOLTED WITH (X4) 3/8" BOLTS WITH 1" WASHERS.
- CORE SUPPORT LOCATION MUST BE IN THE FACTORY LOCATION NO SETTING BACK OR BENDING THE BOTTOM BACK, MUST STAY VERTICAL.

FRONT SUSPENSION, AND STEERING

- ANY TIE RODS MAY BE USED MUST BE 2" OR SMALLER MATERIAL
- ANY SUSPENSION PART MAY BE CHANGED WITH ANY FACTORY CAR THAT IS LEGAL TO RUN IN THIS EVENT NO MAKING SPECIAL MOUNTS OR WELDING, IT MUST DIRECTLY BOLT IN PLACE.
- ANY SUSPENSION THAT IS CHANGED MUST BOLT IN FACTORY LOCATION
- NO AFTERMARKET SUSPENSION OTHER THAN WHAT IS SPECIFIED
- CENTER LINK MAY BE CLEARANCED FOR ENGINE FITTMENT
- IF RUNNING A SWAY BAR IT MUST BE MOUNTED IN THE FACTORY LOCATION, THE ENDS CAN BE HEATED UP AND BENT TO BOLT TO LOWER A ARM WITH MAX 1/2" BOLT AND MUST BE 1" AWAY FROM PULLEY PROTECTOR
- YOU MAY WELD THE UPPER A ARM WITH MAX MATERIAL 1/4"X2"X4" PER SIDE OF A ARM, AND MUST BE MOUNTED WITHIN 2" OF A ARM

ENGINES,CRADLES



- ANY ENGINE SIZE MAY BE USED, FRONT ENGINE CRADLES MAY BE USED
- FRONT ENGINE CRADLE CANNOT GO FURTHER BACK THAN THE MIDDLE OF YOUR ENGINE BLOCK.
- YOU MAY USE A FRONT PULLEY PROTECTOR, CANOT EXTEND MORE THAN 4" PAST PULLEY IN ANY DIRECTION.
- 1/2" EXHAUST FLANGES ARE OK, MAY CONNECT THE FRONT AND REAR CYLINDER HEADS.
- ENGINE SWAPS, AND ENGINE SET BACKS ARE ALLOWED.
- YOU MAY WELD YOUR ENGINE DOWN TO CROSSMEMBER OR FRAME WITH NO MORE THAN 4" HORIZONTAL AND 4" VERTICAL MAX.

- ENGINE WELD MUST BE PARALLEL WITH ENGINE MOUNTING AREA, NO FORWARD OR REAR MOUNTS.
- YOU MAY RUN X1 FRONT HEAD MOUNTS PER SIDE OF ENGINE, MOUNT TO NOT EXCEED 2"X2"X1/4" SQUARE TUBE.
- HEAD MOUNT MAY BE MOUNTED 3" IN FRONT OF A ARM AND CAN ONLY HAVE 8" CIRCUMFRANCE WELD AROUND TUBING.
- REAR HEAD PLATES ARE OK, CANNOT EXTEND PAST THE VALVE COVER LOCATION, OR COIL PACK HEIGHT FOR AN LS ENGINE. MAY CONNECT BOTH SIDES TOGETHER.
- ENGINE CRADLES CANNOT EXCEED FURTHER FROM THE ENGINE BLOCK MORE THAN 4" IN ANY WAY , WITH THE EXCEPTION OF THE FRONT PLATE FOR ACCESSORIES, FRONT PLATE CANNOT BE FURTHER BACK THAN THE FRONT MOST PART OF THE CYLINDER HEAD, AND CAN BE NO THICKER THAN 1" THICK.

TRANSMISSION

- TRANSMISSIONS MAY HAVE AN ALUMINUM ULTRA BELL, STEEL BELL, STEEL TAIL SHAFT, STEEL PAN, AND TRANSMISSION BRACE.
- IF NOT USING A STEEL BELL, YOU MAY CONNECT A PIECE OF 3"X3/16" FLAT STRAP FROM TRANS. PAN TO ENGINE PAN.
- IF USING A STEEL FABRICATED TRANSMISSION PAN, THE PAN DIMENSIONS MUST BE WITHIN 1/2 OF ORIGINAL PAN WIDTH, TRANSMISSION MOUNTING FLANGE CAN BE WITHIN 2" FROM MOUNTING BOLTS.
- TRANSMISSION CROSSMEMBERS MAY BE A FACTORY CAR STYLE **OR** 2X2X1/4 STEEL TUBING CANNOT BE BOTH, MUST BE HOLLOW, AND TUBING CANNOT BE MADE FROM PLATE.
- IF USING 2X2 SQUARE TUBING IT **MUST** BE MOUNTED UNDERNEATH THE FRAME FOR INSPECTION
- TRANSMISSION CROSSMEMBER MAY HAVE SPACER ON TOP TO CONNECT TRANS PAN/TAILSHAFT, SPACER CANNOT BE WIDER THAT THE WIDTH OF THE TAILSHAFT.
- CADILLAC AND 70'S FORD DOG LEGS MUST HAVE ATLEAST 1" GAP FROM CROSSMEMBER
- IF RUNNING TRANS BRACE, OR STEEL BELL YOU MUST HAVE QTY 5, 1/2"X14" RELIEF CUTS VERTICAL DOWN THE TRANSMISSION TUNNEL
- TRANSMISSION CROSSMEMBER CAN BE MOUNTED TO EXTERIOR FRAME RAILS ONLY, YOU MAY HAVE A PIECE OF 3X7 ANGLE IRON MOUNTED TO OUTSIDE FRAME TO WELD YOUR CROSSMEMBER TO, ONLY IF YOU HAVE A CHANNEL CENTER SECTION OF FRAME.

□

- CROSSMEMBER MUST STAY HORIZONTAL, NO ANGLING OR BENDING CROSSMEMBER.
- TRANSMISSION BRACE MUST BE WITHIN 3" OF TRANSMISSION HOUSING

BODY/HOOD

- YOU MAY "PING" ANY PART OF THE VEHICLE EXTERNAL BODY, BODY LINES MAY BE MORE DEFINED BUT MUST REMAIN STRAIGHT, AND CANNOT BE FOLDED OVER OR BEAT DOWN
- YOU MAY ADD X4 3/8 BOLTS IN EACH FENDER/QUARTER PANEL TO

INNER PANEL ABOVE TIRES ONLY

- YOU MAY "ROLL" QUARTER PANELS ABOVE FRONT AND REAR TIRES VERTICALLY, AND BOLT TOGETHER WITH THE ALLOWED X4 BOLTS STATED IN THE RULES ABOVE.
 - FIRE WALL MAY BE BEATEN BACK OR CUT OUT FOR ENGINE SETBACKS, IF BEATING THE FIRE WALL BACK PLEASE REMEMBER FRONT DASH BAR HAS TO BE 12" AWAY FROM **ORIGINAL** FIREWALL LOCATION WHETHER YOU BEAT IT BACK OR NOT
 - YOU MAY RUN A TOTAL OF X6 HOOD BOLTS,
 - X1 HOOD BOLT PER SIDE MAY GO THREW THE FRONT CORE SUPPORT BOLT HOLE AND BE NUTTED OR WELDED TO OUTSIDE OF FRAME, MUST GO THREW THE CENTER OF THE CORE SUPPORT
 - ALL OTHER HOOD BOLTS WITH THE EXCEPTION OF THE LAST RULE MUST ONLY MOUNT TO TOP OF FENDERS OR CORE SUPPORT WITH A MAXIMUM MATERIAL SIZE OF 6"X6"X1/4" WITH A 1" BOLT MAX, OR YOU MAY USE ANGLE IRON MUST BE NO LARGER MATERIAL THAN 3"X3"
 - YOU MAY USE A 2"X2"X1/4" PIECE OF SQUARE TUBING SPACER AT THE CORE SUPPORT BOLT AS A CORE SUPPORT SPACER AND MAY BE WELDED TO THE TOP OF FRAME RAIL ONLY, MUST BE VERTICAL AND CANNOT BE LONGER THAN 6" LONG.
 - TRUNK LIDS MAY BE TUCKED UP TO 50% OF THE TRUNK LID, TRUNK LIDS MAY BE WELDED A TOTAL OF 5" ON AND 5" OFF, TRUNK MUST BE WELDED IN FACTORY LOCATION ONLY, MAY BE WELDED TO FLOORS AND QUARTER PANELS ONLY IF THE TRUNK IS TUCKED, MAX MATERIAL SIZE IS 1/2 REBAR, OR 2 1/2X1/4 FLAR BAR, ALL TRUNK WELDING MUST BE TO THE OUTER EDGE ONLY

 - SPEAKER DECKS **MAY NOT** BE REMOVED
 - IF YOU "V" YOUR TRUNK LID IT MUST HAVE AT MINIMUM OF 12" OF CLEARANCE FROM THE HIGHEST POINT OF THE TRUNK FLOOR, TRUNK LID MUST HAVE A 12"X12" HOLE FOR INSPECTION
 - FRONT AND REAR BUMPERS MAY HAVE 2 STRAPS PER BUMPER WELDED FROM BUMPER TO TRUNK LID/CORE SUPPORT, STRAP MAX SIZE IS 36"X2 1/2X1/4, EACH STRAP MUST ONLY BE WELDED A MAXIMUM OF 8" PER SIDE OF STRAP
 - STATION WAGON DECK LIDS MAY BE WELDED 5" ON 5" OFF
 - DRIVERS DOOR MAY BE FULLY WELDED
 - TOP OF DRIVERS DOOR ONLY MAY BE FULLY WELDED WITH UP TO 3"X1/4" STRAP.
-
- ONLY THE EXTERIOR OF THE DOORS MAY BE WELDED.
 - EXTERIOR DOORS CAN ONLY BE WELDED 5" ON 5" OFF WITH 1/4"X3" MATERIAL
 - TRUNK LIDS MAY HAVE UP TO X2 1" ALL THREADS, ALL THREAD CAN ONLY GO THREW TRUNK LID AND MUST BE VERTICAL AND MAY BE WELDED TO SIDE OF FRAME WITH NO MORE THAN 4" OF WELD, OR MAY GO THREW A STOCK BODY BOLT MOUNT WITH A 3"X3" WASHER ON THE BOTTOM OF THE FRAME, YOU MAY HAVE UP TO 6"X6" WASHERS ON TOP OF TRUNK LID.
-

- YOU MAY USE ANY REAR END.



REAR END

- YOU MAY USE AFTERMARKET TRAILING ARM EARS
- YOU MUST RUN THE FACTORY LEAF PACK FOR THAT VEHICLE
- COILS MAY BE WELDED TO REAR END AND WELDED 4" TO PACKAGE TRAY
- NO PART OF REAREND HOUSING OR MOUNTS CAN ADD STRENGTH TO CAR FRAME/BODY
- YOU MAY HAVE UP TO 5 LEAF SPRING CLAMPS PER SPRING PACK, MAX SIZE IS 3" WIDE AND CAN ONLY BE 6" WIDE
- ON LEAF SPRING CARS YOU MAY BUILD A HOMEMADE LEAF SPRING SHACKLE ON REAR ONLY, IT MAY BE NO LARGER THAN 3 1/2" X 3/8" PLATE. MAY MOUNT WITH UP TO 5/8" BOLT
- COIL SPRING CARS MAY BRACE TRAILING ARMS, OR USE SQUARE TUBING, MAX SIZE TUBING CANNOT EXCEED 2" X 2" IN ANY DIRECTION ON EITHER OPTION, MUST BE BOLTED AND WORKING.
- YOU MAY USE AFTERMARKET TRAILING ARM MOUNTS ON PACKAGE TRAY AND REAREND AND MUST NOT EXCEED 2" PAST ORIGINAL SIZE OF MOUNTS.
- YOU MAY CONVERT WATTS LINK TO A 4 LINK SYSTEM, IF USING THIS METHOD YOU MAY MAKE A 7" X 7" MOUNT WITH X4 BOLT HOLE THAT MOUNT TO YOUR PACKAGE TRAY FOR YOUR UPPER TRAILING ARMS TO BOLT TO, YOU MAY CUT THE OLD LOWER TRAILING ARM MOUNT TO FRAME OFF AND MOUNT IT TO THE INNER SIDE OF FRAME PARALLEL TO THE ORIGINAL LOCATION, MUST ONLY WELD WITH NO MORE THAN 1/2" WELD.
- YOU MAY RUN A BUMP STOP IN THE REAR THAT CAN BE WELDED TO YOUR REAR END HOUSING AND MUST FREE FLOAT ON THE BOTTOM OF THE FRAME RAIL, MAX MATERIAL SIZE IS 2" X 2" X 1/4" SQUARE TUBING, TUBING MUST STAY VERTICAL, MUST USE ONE PIECE WITH NO GUSSETS.
- YOU MAY CHAIN THE REAR END WITH NO LARGER THAN 1/2" CHAIN WITH A SINGLE WRAP ON THE FRAME AND REAR END, **CANNOT** SANDWICH THE BODY AND FRAME WITH CHAIN.
- IF USING A UNI BODY CAR YOU MAY CUT A HOLE ABOVE THE REAR FRAME TO RUN YOUR CHAIN THREW THE TRUNK AND BACK TO THE REAR END

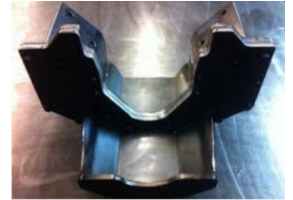

MISC.

- YOU MAY HAVE 12" X 4" X 1/2" OF FRAME REPAIR PER FRAME RAIL ON FRESH OR USED CARS, REPAIR MAY BE BROKE INTO 2 PIECES TOTAL, CAN ONLY BE BROKE UP LENGTH WISE NOT BY THE WIDTH.
- YOUR CAR WILL BE REINSPECTED AFTER THE SHOW IF ANYTHING IS FOUND OR BROUGHT UP THAT WAS NOT LEGAL TO RUN IN THE RULES YOU WILL BE DISQUALIFIED.

TIRES

- YOU MAY USE ANY SIZE RUBBER TIRE, MUST BE AIR FILLED, NO SOLID TIRES.

- YOU MAY RUN A SMALL MULTI LUG WHEEL CENTER UP TO 3/8".

BATTERY'S

- MAY HAVE UP TO 3 BATTERY'S TOTAL.
- BATTERY BOX CANNOT STRENGTHEN THE CAR IN ANY WAY.
- BATTERY BOX MUST NOT BE WELDED OR COME INTO CONTACT WITH ANY PART OR THE CAR OTHER THAN THE FLOORBOARD, CANNOT USE AS A BRACE, MUST BE 6" FROM FIREWALL. OFFICIALS DISCRETION, CANNOT BE BOLTED THROUGH BODY BRACES OR FRAME RAILS.