

## INDOOR EXHIBIT SPACE

Exhibit Space	Cost
10' x 10' .....	\$925
15' x 10' .....	\$1,150

Corner locations are an additional \$50 per corner.

A \$105 maintenance fee will be charged to all vendors for each location.

20 AMP electrical service is included in price. If you require more, there will be an additional charge.

Buildings will be decorated with pipe and drape, 8 ft. back drapes and 3 ft. side drapes. **Exhibitors must confine all exhibit activities within the limits of space allotted. Sales personnel and demonstrators are prohibited from operating in the aisles. (Please refer to Rules and Regulations for additional policies and procedures).**

Indoor vendors may begin set up Tuesday, January 11, 2022 at 9 a.m. Set up must be completed by 3 p.m. on Thursday, January 13. All vendors must first check in at the credentials office to obtain badges, passes and parking permits as needed. Accounts must be paid in full. Proof of insurance must be on file prior to entering the grounds. Anyone owing a balance upon arrival will not be permitted to set up until balance is paid. **No exceptions will be made.**

Exhibits must be staffed during Fair operation hours. Failure to man an exhibit is cause for loss of space and all expenses or rental fees will be forfeited. Hours of operation are:

Monday through Friday 12 noon – 10 p.m.\*

Saturday, Sundays and Martin Luther King Day (Monday, January 17) 10 a.m. – 10 p.m.\*

\* Hours subject to change

Buildings will remain locked until one hour prior to opening. Exhibits Manager must approve admittance to the buildings prior to scheduled times. No one will be permitted to enter a building without proper credentials.

Permits are required for all stock trucks parked anywhere on the fairgrounds, including general parking areas, fair camping locations and off site remote parking lots operated by the Fair. Stock truck permits can be obtained from the vendor office for \$100. Electrical hook-ups must be purchased separately.

**All Indoor vendors will receive release forms after 7 p.m. on the final day of the Fair. Tear down may not begin until 8 p.m. Violators will not be allowed to return the following year. Release slip must be presented at the gate upon removal of concession stand or exhibit.**

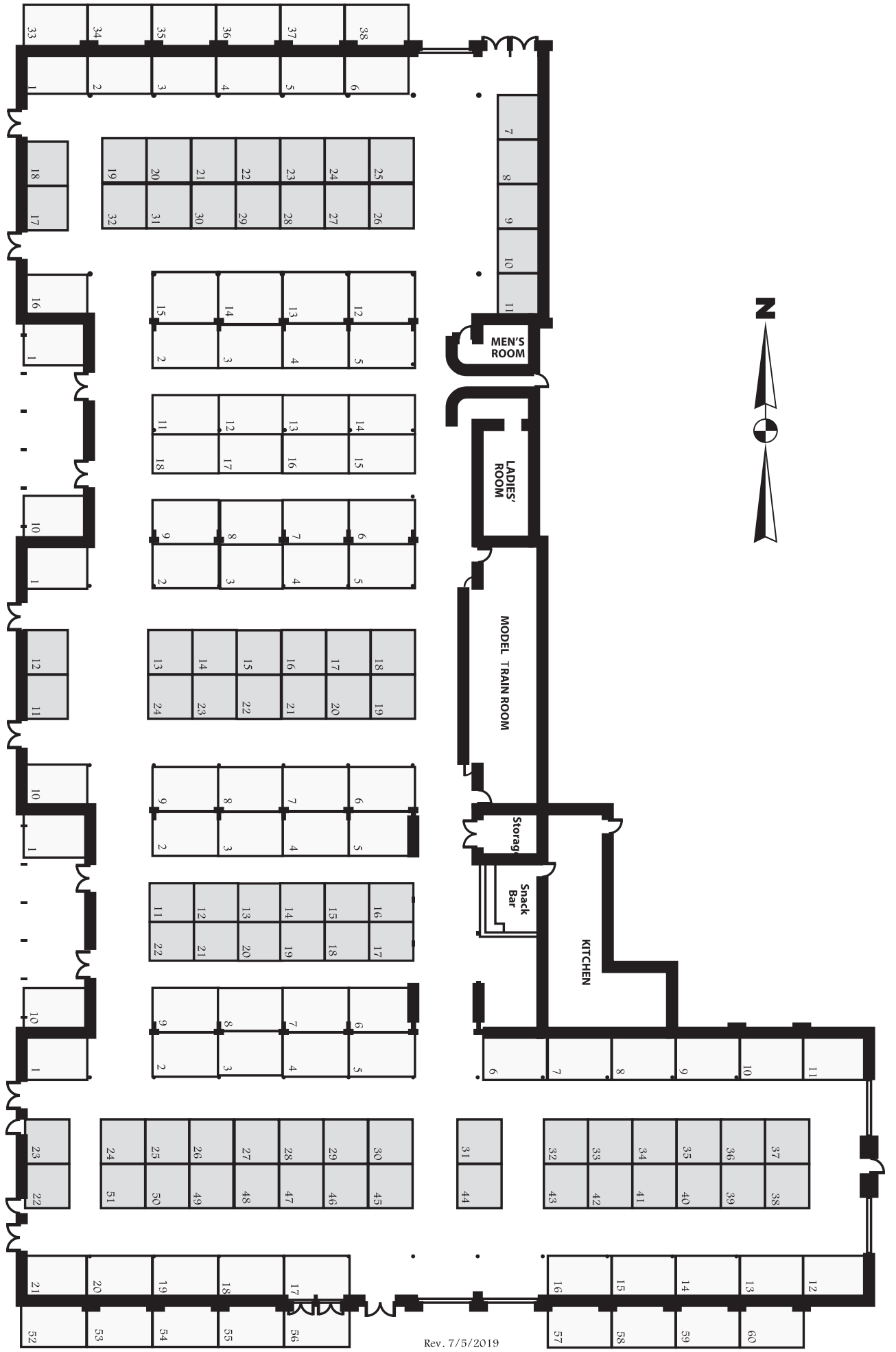

9

7

8

6

10