

Expo Building

EXPO CENTER *at the South Florida Fairgrounds*

Offering 128,000 Usable Square Feet of Exhibit Space Ideal For:
Consumer Shows • Trade Shows
Meetings • Special Events
Banquets • Corporate Training

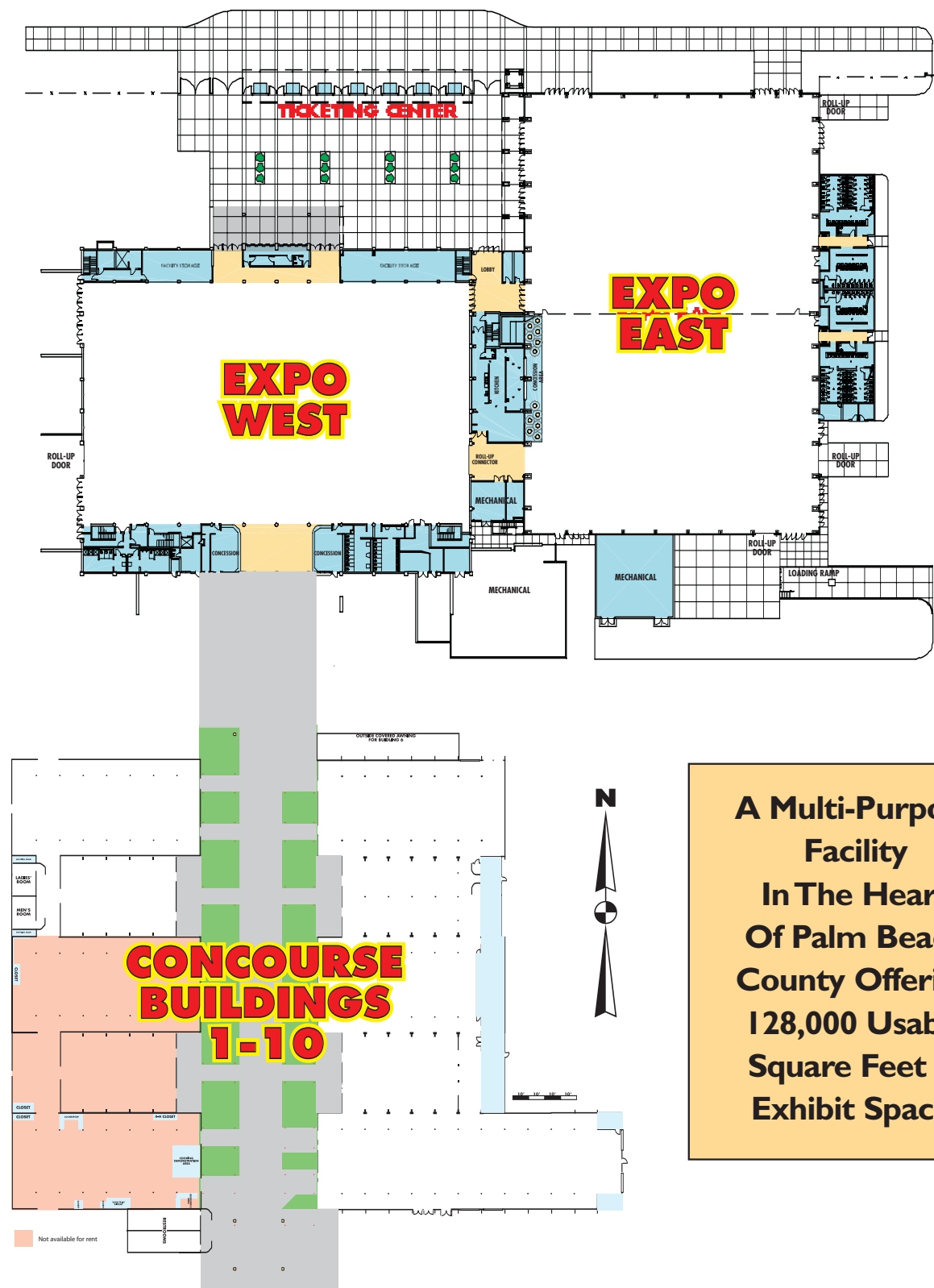

**A Multi-Purpose
Facility
In The Heart
Of Palm Beach
County Offering
128,000 Usable
Square Feet of
Exhibit Space.**

EXPO CENTER *at the South Florida Fairgrounds*

9067 Southern Boulevard • West Palm Beach, FL 33411
(561) 790-4908 • Fax (561) 790-5206
Website: www.southfloridafair.com

Exposition Hall West

- Finished concrete floor
- Plaster covered masonry walls
- Exposed structure
- 25' clear to underside of structure
- No columns or obstructions

Net Area: 35,700 SF
Room for 160-190 booths, 10' X 10', with 10' aisles

Loading/Unloading:
One 18' wide X 21' high overhead coiling door to exterior
One 18' wide X 16'4" high overhead coiling door to new exposition hall

Dual concession areas: Kitchen with hood and cooking equipment.

Restrooms:
Women: 9 WC's
Men: 8 WC's, 10 Urinals

Lighting:
Overhead in ceiling producing a minimum of 35 foot-candles of lighting at floor level. Dimmable to two levels.

Electrical:
120v, 20 Amp receptacle service located in floor throughout building.
Selected 60 Amp 120/208 3-phase four wire connection at certain locations.

PA System throughout building

Promoters Office

EXPO CENTER SPECIFICATIONS
TOTAL OF 84,751 USABLE SQUARE FEET

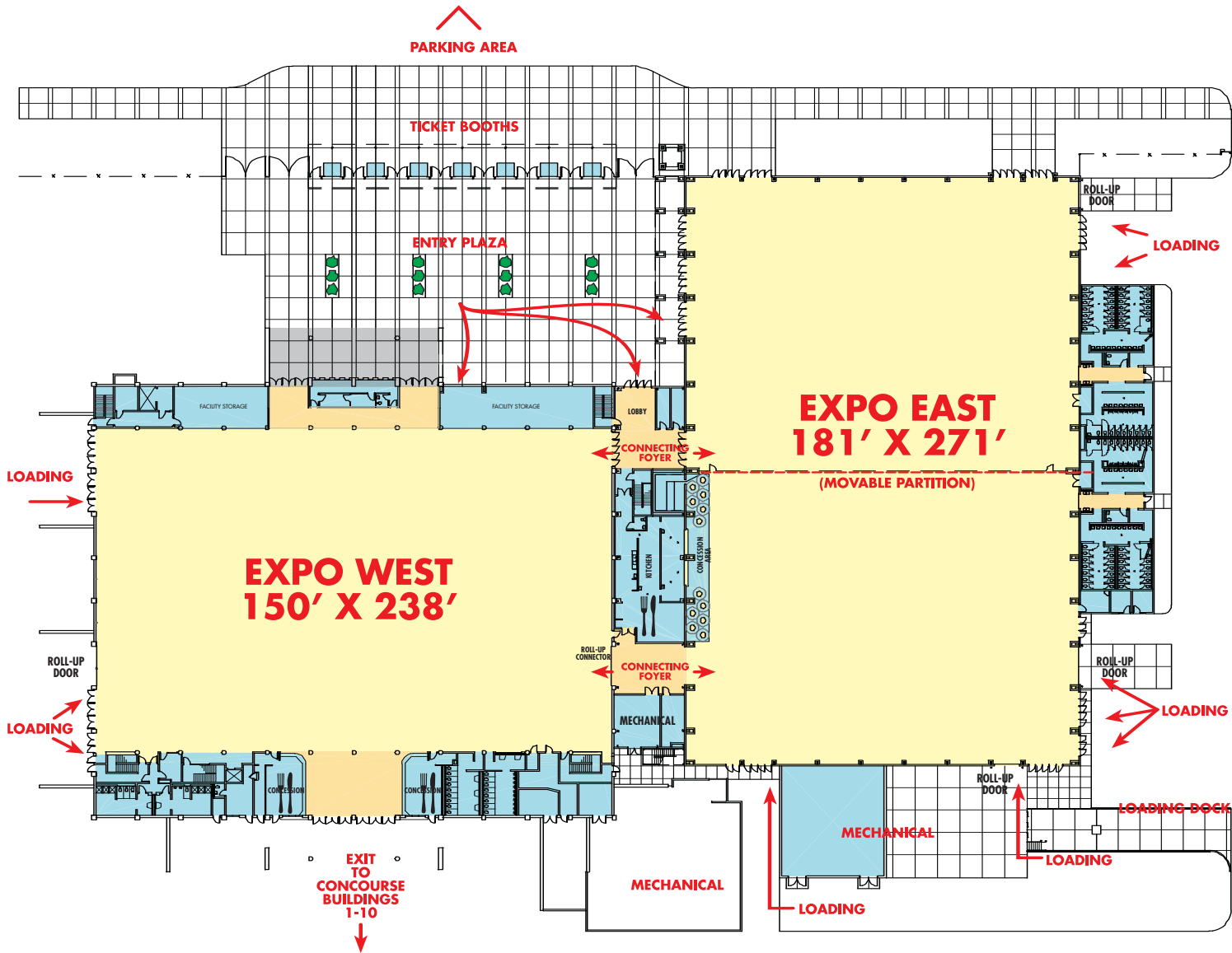

Exposition Hall East

- Finished, sealed concrete floor; Painted block walls to a height of 14'8"
- Exposed roof structure, painted out
- 32' clear to underside of roof structure at lowest point, 35' at highest (center line of building)
- No columns or obstructions

Net Area: 49,051 SF
Room for 250+ booths, 10' X 10', with 10' aisles.
Hall is dividable in center by floor to ceiling partition.

Loading/Unloading:
Two 12' wide X 16' high overhead doors (one on either side of possible operable partition)
One 18' wide X 20' high overhead door to exterior
One 17'4" wide X 16'4" high roll-up door connecting opening between East and West Exposition Halls.
One loading dock.

Concession: Full concession stand and kitchen with hood, walk-in cooler, and cooking equipment.

Restrooms:
Two banks of restrooms on north and south side of hall with the following:
Women: 54 WC's
Men: 18 WC's, 12 Urinals
2 Family Restrooms

Lighting: Multilevel lighting available in the East Exposition Hall for a variety of types of events. Minimum of 50 foot-candles at floor level. Dimmable to four (4) levels.
Dedicated stage and lighting power available at three locations for concert type events. (100 amp, 120/208 volt, 3 phase.)

Electrical: Single phase and 3 phase, 120/208 volt power available to vendor booths from floor boxes located 30' off-center throughout the floor. Voice and data connectivity with capability for local area networking located in floor boxes located 30' off-center throughout the floor.
Water and sewer outs located within 100' of each booth.

PA System throughout building

2- Promoter Offices



TYPICAL 10'X10' BOOTH LAYOUT
(429 10'X10' BOOTHS)



TYPICAL LARGE SPACE SHOW LAYOUT

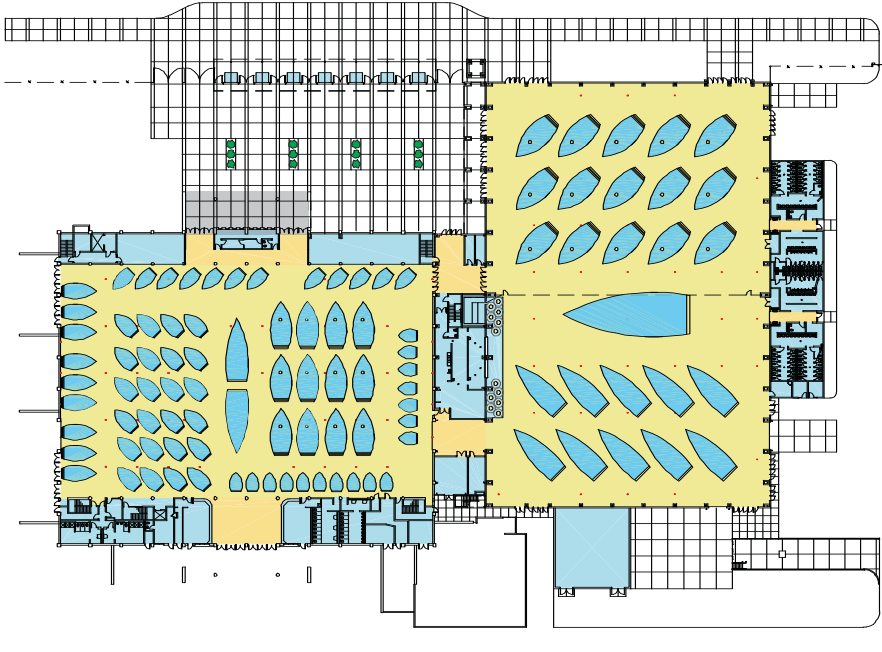

TYPICAL BOAT SHOW LAYOUT