



Event Center Project Newsletter

November 2018

Vol. 3

Vision of Events to Come

by Washington County Project Manager, Geoffrey Kavulya and Rob Massar, Consultant

In 2008, a diverse group of stakeholders, known as the Fairgrounds Revitalization Task Force, developed a grand master plan for the redevelopment of the Washington County Fairgrounds. The cornerstone of their vision; an Event Center that would showcase Washington County and attract a broad array of events including consumer and public shows, conventions, conferences, banquets, trade shows, business meetings, sporting events, and other regional and local events. Now their vision is about to be realized, as we begin the construction of the Washington County Events Center. The Center will include an Exposition Hall, as well as a conference center with operable walls to allow convenient usage of up to 40,000 and 10,600 contiguous square feet of space in each room respectively.

In this issue...

Spotlight on...

Project Team

Project Updates

Contact Information

Project Scope:

Build a state of the art Event facility at the Washington County Fair Complex that includes approximately 40,000 square feet of exposition space and a 14,000 sf, state-of-the-art, conference center, complete with commercial kitchen, concessions and offices.

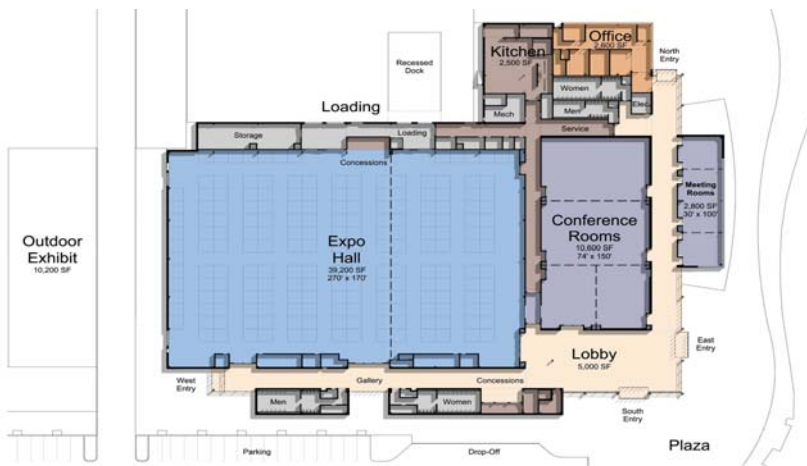

The Event Center will also include a pre-function and support space, galleries, commercial kitchen, and concessions. As a meeting place for major conventions and trade shows in an urban environment, the facility's design is pedestrian friendly, with thoroughfares that thoughtfully connect to the existing fabric of the city as well. Additionally, the design takes advantage of existing contextual features like view to Mt. Hood to enrich the event goer experience. Moreover, an attractive and inviting Plaza will surround the east and south sides of the Center, reorienting the front door of the Event Center and Fairgrounds to the light rail station to the south. The design leverages materiality to integrate the new facility into its urban context and Pacific North West feel through use of Cross Laminated Timber (CLT).